



# TRQ300 INTERNATIONAL TORQUE

21A  
Orig. schematic showed lever with 21A-200T washer  
This washer has been replaced by key #26B part #26-200T

40-300T 3pc Assembly Only  
Can order 55 and 120 separately for now

18A  
54B  
158  
1  
These parts were on the original revision of the TRQ200 and TRQ300 schematics, but were removed on later revisions, as they are part of the 1-200T, 1-300T side plates and are not being offered as a serviceable part.

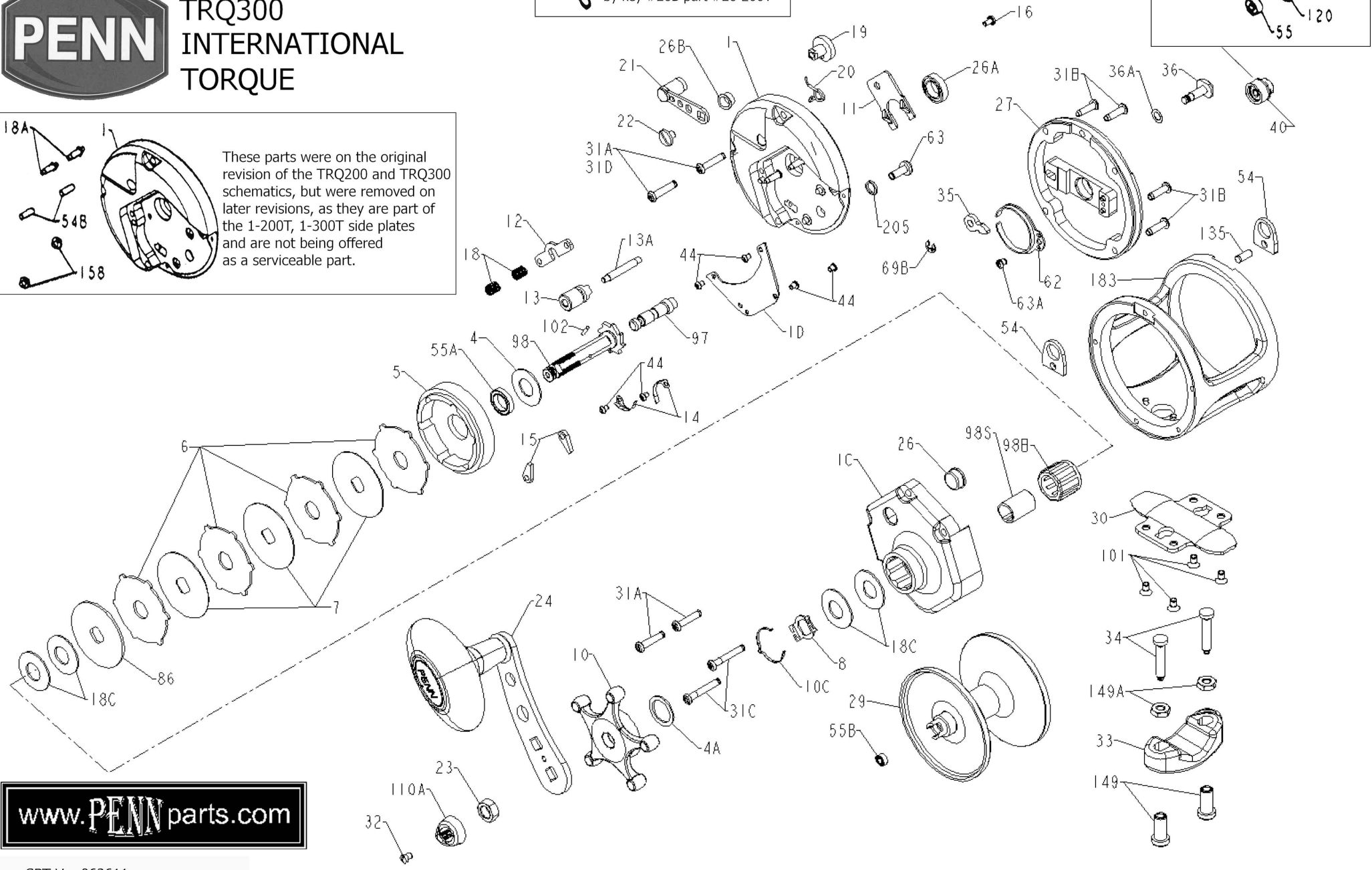

[www.PENNparts.com](http://www.PENNparts.com)

## Penn Reel Parts list for:

## Model: TRQ300 International Torque

KEY NO	PART NO.	DESCRIPTION	KEY NO	PART NO.	DESCRIPTION
1	1-300T	RIGHT SIDE PLATE	31A	31TA-300T	SCREW R.S. (2 REQUIRED)
1C	1C-300T	COVER, RIGHT SIDE	31B	31TB-300T	SCREW L.S. (4 REQUIRED)
1D	1D-300T	BACKING PLATE	31C	31TC-300T	SCREW R.S. (2 REQUIRED)
4	4-60	GRAPHITE WASHER	32	39-10	SCREW
4A	4-300T	GRAPHITE WASHER	33	33N-113	ROD CLAMP
5	5-300T	MAIN GEAR	34	34-16VS	ROD CLAMP SCREW (2 REQUIRED)
6	6-300T	DRAG WASHER (4 REQUIRED)	35	35-60	CLICK TONGUE
7	7-300T	METAL DRAG WASHER (3 REQUIRED)	36	36-300T	CLICK BUTTON
8	8-113HN	SPRING RETAINER	36A	36A-300T	WASHER, CLICK BUTTON
10	10-300T	DRAG STAR	40	40-300T	BEARING CUP, LEFT SIDE (ASSEMBLY)
10C	10C-113HN	DETENT SPRING	44	44-300T	SCREW (4 REQUIRED)
11	11-300T	ECCENTRIC JACK	44A	44-4200	SCREW (2 REQUIRED)
12	12-300T	PINION YOKE	54	54-16S	HARNESS LUG (2 REQUIRED)
13	13-300T	PINION	**	54A016VS	HARNESS LUG PLUT (2 REQUIRED)
13A	13A-300T	PINION PIN	55A	55-113HN	BALL BEARING (MAIN GEAR)
14	14-300T	DOG SPRING (2 REQUIRED)	55B	55-910	BALL BEARING (SPOOL ASSEMBLY)
15	15-200T	DOG, ANTI-REVERSE (2 REQUIRED)	62	62-309	CLICK SPRING
16	16-200T	ECCENTRIC JACK SCREW	63	63-30T	SCREW (GEAR STUD)
18	18-60	CLUTCH SPRING (2 REQUIRED)	63A	63-209	SCREW (CLICK SPRING)
18C	18-505	TENSION WASHER (4 REQUIRED)	69B	69B-600	RETAINING RING
19	19-300T	ECCENTRIC	86	86-300T	WASHER, KEYED
20	20-155	ECCENTRIC SPRING	97	97-300T	BRIDGE (F/GEAR STUD)
21	21-300T	ECCENTRIC LEVER ASSEMBLY	98	98-300T	GEAR SLEEVE
22	22-60CH	SCREW, ECCENTRIC LEVER	98B	98B-525	CLUTCH BEARING
23	23-555	HANDLE NUT	98S	98S-525	CLUTCH BEARING SLEEVE
24	24S-113HN	HANDLE	101	101-80ST	SCREW, STAND (4 REQUIRED)
26	26-113HN	BEARING CUP ASSEMBLY	102	102-60	PIN, GEAR SLEEVE
26A	26A-2.5FR	BALL BEARING	110A	110A-555	HANDLE NUT CAP
26B	26-200T	ECCENTRIC BUSHING	135	135A-80	DOWEL PIN, LUG (2 REQUIRED)
27	27-300T	LEFT SIDE PLATE ASSEMBLY	149	149-45	ROD CLAMP NUT (2 REQUIRED)
29	29L-300T	SPOOL ASSEMBLY	149A	149-200	ROD CLAMP HEX NUT (2 REQUIRED)
30	30-16VS	STAND	183	183-300T	FRAME
			205	205-300T	WASHER, GEAR STUD

NOTE: Many of www.pennparts.com schematics include changes that were either made by Penn, or errors found and corrected by our parts dept.

SBT VER. 062611 (BASED ON PENN'S REV 9)

### This part was on the original schematic:

21A 21A-200T ECCENTRIC LEVER WASHER

### Replaced By:

26B 26-200T ECCENTRIC BUSHING

### These were removed in Rev2

154 154-117 CLICK TONGUE SHIM

8A 8A-300T SHIM

### These parts were on the original schematic:

18A 18A-300T CLUTCH SPRING POST (2 REQUIRED)

54B 54B-130 DOWEL PIN (2 REQUIRED)

158 158-300T DOG PIN (2 REQUIRED)

**They are part of the 1-200T and 1-300T plates**

**Penn is not offering them as servicable parts**

### These three pieces on original schematic:

40 40-300T BEARING CUP, LEFT SIDE

55 55-113H BALL BEARING (LEFT SIDE PLATE)

120 120-113H O-RING, LEFT SIDE PLATE

Are sold together as an assembly under # 40-300T