



PARTS LIST FOR MODEL SSVI8500LL

1481280



mysticparts.com

MYSTIC REEL PARTS

965 Radio Road
Little Egg Harbor, NJ 08087
+1 (609) 296-1300
www.mysticparts.com
customerservice@mysticparts.com

MRP Ver 102118

(based on Penn's Rev 00 04-11-18)

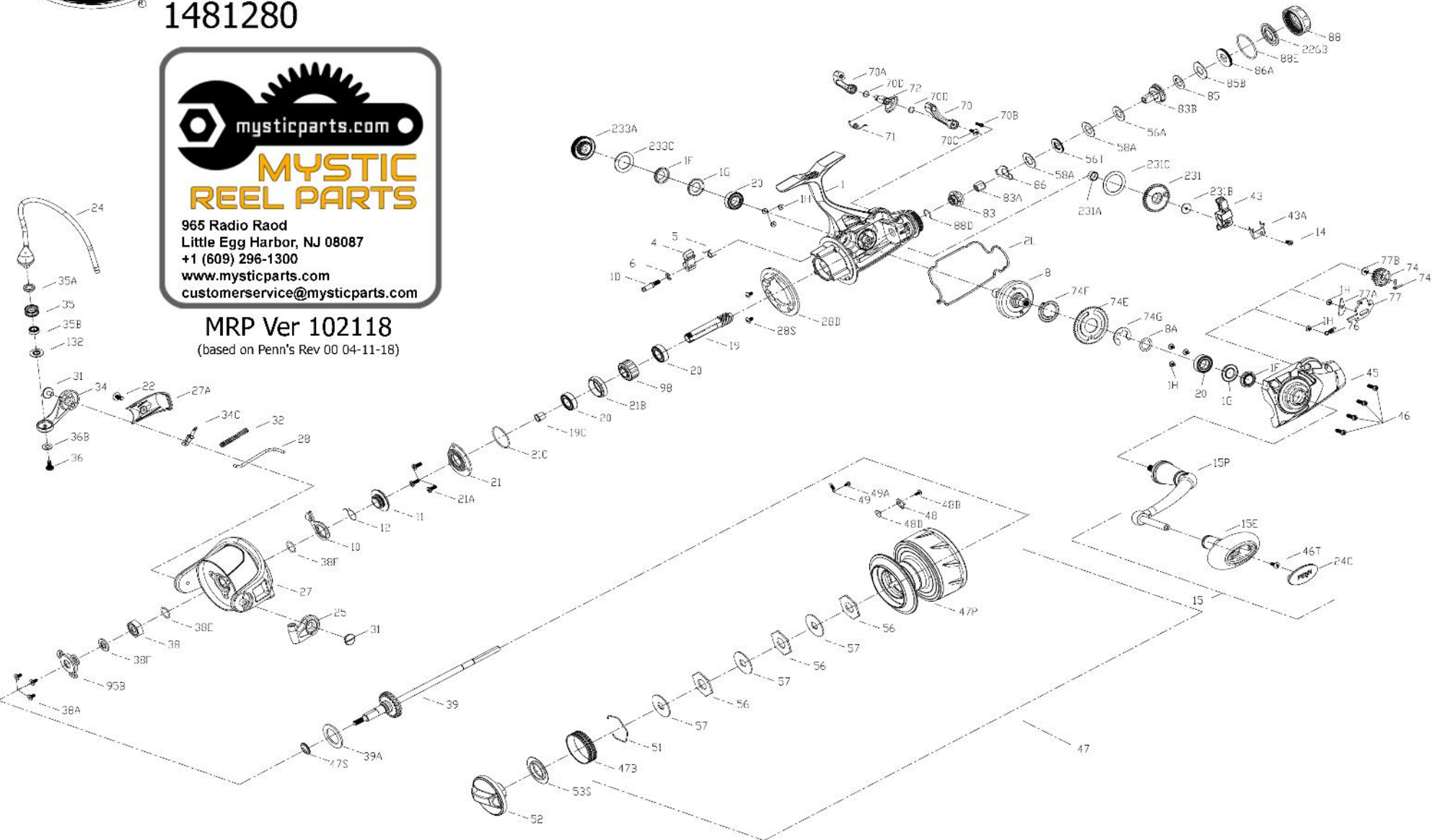

Penn Reel Parts list for Model: SSVi8500LL Spinfisher VI Live Liner (1481280)

KEY	PUREFISHING	PART	DESCRIPTION	KEY	PUREFISHING	PART	DESCRIPTION
<u>NO</u>	<u>NO</u>	<u>NO.</u>		<u>NO</u>	<u>NO</u>	<u>NO.</u>	
1	1494791	1-SSVi8500LL	BODY/HOUSING	45	1494806	45-SSVi8500LL	BODY COVER ASSEMBLY
1D	1277140	1D-SSV7500	A/R PAWL POST	46	1277074	46-SSV5500	BODY COVER SCREW (4 REQUIRED)
1F	1419083	1F-SLA7500	BODY BALL BEARING SEAL (2 REQUIRED)	47	1494807	47-SSVi8500LL	SPOOL ASSEMBLY
1G	1419082	1G-SLA7500	BODY SIDE SEAL LOCK PLATE (2 REQUIRED)	47B	1277076	47B-SSV5500	SPOOL BAND
1H	1418957	1H-SLA3500	BODY SIDE SCREW (8 REQUIRED)	47P	1494808	47P-SSVi8500LL	SPOOL (BARE)
2L	1494792	2L-SSVi8500LL	BODY SEAL	47S	1494699	47S-SSVi2500LL	SPOOL SEAL
4	1277142	4-SSV7500	A/R PAWL	48	1385578	48-CLA3000	SPOOL CLICK PLATE
5	1277143	5-SSV7500	PAWL SPRING	48B	1385581	48B-CLA3000	SPOOL CLICKER SPRING SCREW
6	1277144	6-SSV7500	RETAINER CLIP	48D	1385579	48D-CLA3000	SPOOL CLICKER SPACER RING
8	1494793	8-SSVi8500LL	DRIVE GEAR (MAIN GEAR)	49	1385580	49-CLA3000	SPRING
8A	1277037	8A-SSV5500	SHIM / WASHER (DRIVE AND PINION GEARS)	49A	1341547	49A-SSV7500LC	SCREW (2 REQUIRED)
10	1277147	10-SSV7500	A/R PAWL HOLDER	51	1447925	51-CFTii5000	DRAG WASHER RETAINER
11	1419088	11-SLA7500	A/R BUSHING	52	1494809	52-SSVi8500LL	DRAG KNOB ASSEMBLY
12	1339487	12-SLA5500	A/R BUSHING SPRING	53S	1447927	53S-CFTii5000	DRAG KNOB SEAL
14	1276992	14-SSV6500LL	SCREW, FOR OSCILLATION SLIDER RETAINER	56	1339557	56-CLA5000	DRAG FRICTION WASHER (3 REQUIRED)
15	All handle components, see page 3						
19	1494797	19-SSVi8500LL	PINION GEAR	56A	1494767	56A-SSVi6500LL	FRICTION WASHER (REAR)
19C	1419092	19C-SLA7500	PINION GEAR BUSHING	56T	1494768	56T-SSVi6500LL	DRAG WASHER (REAR) (dual sided ht100/metal - square key hole)
20	1277152	20A-SSV7500	BALL BEARING (4 REQUIRED)	57	1339558	57-CLA5000	KEYED METAL DRAG WASHER (3 REQUIRED)
21	1419083	21-SLA7500	BALL BEARING RETAINER	58A	1494769	58A-SSVi6500LL	EARRED METAL DRAG WASHER (REAR) (2 REQUIRED)
21A	1277154	21A-SSV7500	RETAINER SCREW (3 REQUIRED)	70	1494770	70-SSVi6500LL	LEVER, LEFT
21B	1419094	21B-SLA7500	PINION BALL BEARING COLLAR	70A	1494771	70A-SSVi6500LL	LEVER, RIGHT
21C	1385684	21C-CLA8000	BODY HEAD SEAL	70B	1277128	70B-SSV6500LL	SCREW, FOR DRAG SWITCH LEVER
22	1277046	22-SSV5500	SCREW, FOR ROTOR COVER	70C	1277003	70C-SSV4500LL	SCREW, FOR RIGHT DRAG SWITCH LEVER
24	1494798	24-SSVi8500LL	BAIL WIRE	70D	1494708	70D-SSVi2500LL	O-RING (2 REQUIRED)
25	1385663	25-CLA8000	BAIL HOLDER	71	1494772	71-SSVi6500LL	SPRING
27	1494800	27-SSVi8500LL	ROTOR	72	1494773	72-SSVi6500LL	SWITCH CAM
27A	1494801	27A-SSVi8500LL	ROTOR COVER	74	1494774	74-SSVi6500LL	CAM GEAR
28	1494802	28-SSVi8500LL	ROTOR TRIP LEVER	74B	1494775	74B-SSVi6500LL	SPRING
28D	1277161	28D-SSV7500	ROTOR BRAKE	74E	1494810	74E-SSVi8500LL	GEAR
28S	1277054	28S-SSV5500	SCREW (2 REQUIRED)	74F	1494811	74F-SSVi8500LL	SPRING
31	1277055	31-SSV5500	BAIL ARM SCREW (2 REQUIRED) (SEE 31A IN NOTES)	74G	1277014	74G-SSV4500LL	E-CLIP, FOR THREE PAWL LEVER
32	1277162	32-SSV7500	BAIL SPRING	76	1494778	76-SSVi6500LL	LIVE LINER CLAW SPRING
34	1385667	34-CLA8000	BAIL ARM	77	1494812	77-SSVi8500LL	STOP CLAW
34C	1277164	34C-SSV7500	PIVOT ARM	77A	1494813	77A-SSVi8500LL	PLATE
35	1457805	35-SLAiii8500HS	LINE ROLLER	77B	1496533	22A-SLA7500	SCREW, FOR DRAG COVER
35A	1457806	35A-SLAiii8500HS	LINE ROLLER BUSHING	83	1496528	83-SSVi8500LL	RATCHET
35B	1377606	35A-BTLII8000LC	LINE ROLLER BALL BEARING	83A	1496529	83A-SSVi8500LL	BUSHING
36	1277166	36-SSV7500	LINE ROLLER SCREW	83B SUPPORT ASSEMBLY - SEE PG 3 NOTES			
36B	1417809	36B-CLA6000	BAIL ARM SCREW WASHER	85	1494783	85-SSVi6500LL	WASHER (2 REQUIRED)
38	1419103	38-SLA7500	ROTOR NUT	85B	1494784	85B-SSVi6500LL	EARRED METAL WASHER
38A	1277044	21A-SSV5500	SCREW (3 REQUIRED)	86	1494785	86-SSVi6500LL	SPRING
38E	1302502	232B-SSV3500	PINION GEAR SEAL	86A	1494786	86A-SSVi6500LL	NUT
38F	1419080	38F-SLA7500	ROTOR-MAIN SHAFT SEAL	88	1494787	88-SSVi6500LL	KNOB
				88D	1500157	88D-SSVi8500LL	RETAINER

39	1494803	39-SSVi8500LL	MAIN SHAFT	88E	1494789	88E-SSVi6500LL	O-RING
39A	1494758	39A-SSVi6500LL	WASHER	95B	1419114	95B-SLA7500	ROTOR NUT LOCKING PLATE
43	1494804	43-SSVi8500LL	OSCILLATION SLIDER (CROSSWIND BLOCK)				
43A	1494805	43A-SSVi8500LL	SLIDER RETAINER PLATE				

page 2 of 3

Mystic Reel Parts

KEY	PUREFISHING	PART	
<u>NO</u>	<u>NO</u>	<u>NO.</u>	<u>DESCRIPTION</u>
98	1277190	98-SSV75500	CLUTCH/SLEEVE ASSEMBLY
132	1457807	132-SLaiii85500HS	LINE ROLLER COLLAR
226B	1494790	226A-SSVi6500LL	SEAL (REAR)
231	1419117	231-SLA7500	OSCILLAION GEAR (CROSSWIND GEAR)

KEY	PUREFISHING	PART	
<u>NO</u>	<u>NO</u>	<u>NO.</u>	<u>DESCRIPTION</u>
231A	1494814	231A-SSVi8500LL	OSCILLATION GEAR BUSHING
231B	1277100	231B-SSV5500	OSCILLATION GEAR SCREW
231C	1494815	231C-SSVi8500LL	OSCILLATION GEAR WASHER
233A	1419118	233A-SLA7500	HANDLE CAP
233C	1419076	233C-SLA5500	HANDLE CAP WASHER

HANDLE COMPONENTS

15	1494794	15-SSVi8500LL	HANDLE ASSEMBLY (RUBBER FOOTBALL KNOB)
15E	1494795	15E-SSVi8500LL	HANDLE KNOB (METAL)
15P	1494796	15P-SSVi8500LL	SUB-HANDLE ASSEMBLY
24C	1494799	24C-SSVi8500LL	HANDLE KNOB CAP (FOR METAL KNOB)
46T	1494762	46T-SSVi6500LL	SCREW

NOTES

83B	1494782	83B-SSVi6500LL	SUPPORT ASSEMBLY (SEE SPRING BELOW)
83C	??	83C-SSVi2500LL	SPRING FOUND ON ASSEMBLY, WE ASSIGNED THIS NUMBER
83D??	??	83D-SSVi6500LL	KEYED RETAINING WASHER, WE ASSIGNED THIS NUMBER
31A**	??	31A-SSVi8500LL	SHIM, BAIL SCREW SHIM

****Not on Rev00 Penn Schematic, found in the SSVi8500LL reel
NOT ADDING IT TO THE DRAWING AT THIS TIME 1/31/21**

MYSTIC REEL PARTS REVISION!

NOTE:

Many of www.mysticparts.com schematics include changes that were either made by Penn, or errors found and corrected by our parts dept.

MRP Ver 102118 (Based on Penn's Rev. 00 , 04-11-18)