



PARTS LIST FOR MODEL SSVI2500LL 1481278

mysticparts.com
MYSTIC REEL PARTS
965 Radio Raod
Little Egg Harbor, NJ 08087
+1 (609) 296-1300
www.mysticparts.com
customerservice@mysticparts.com

MRP Ver 102118

(based on Penn's Rev 00 04-11-18)

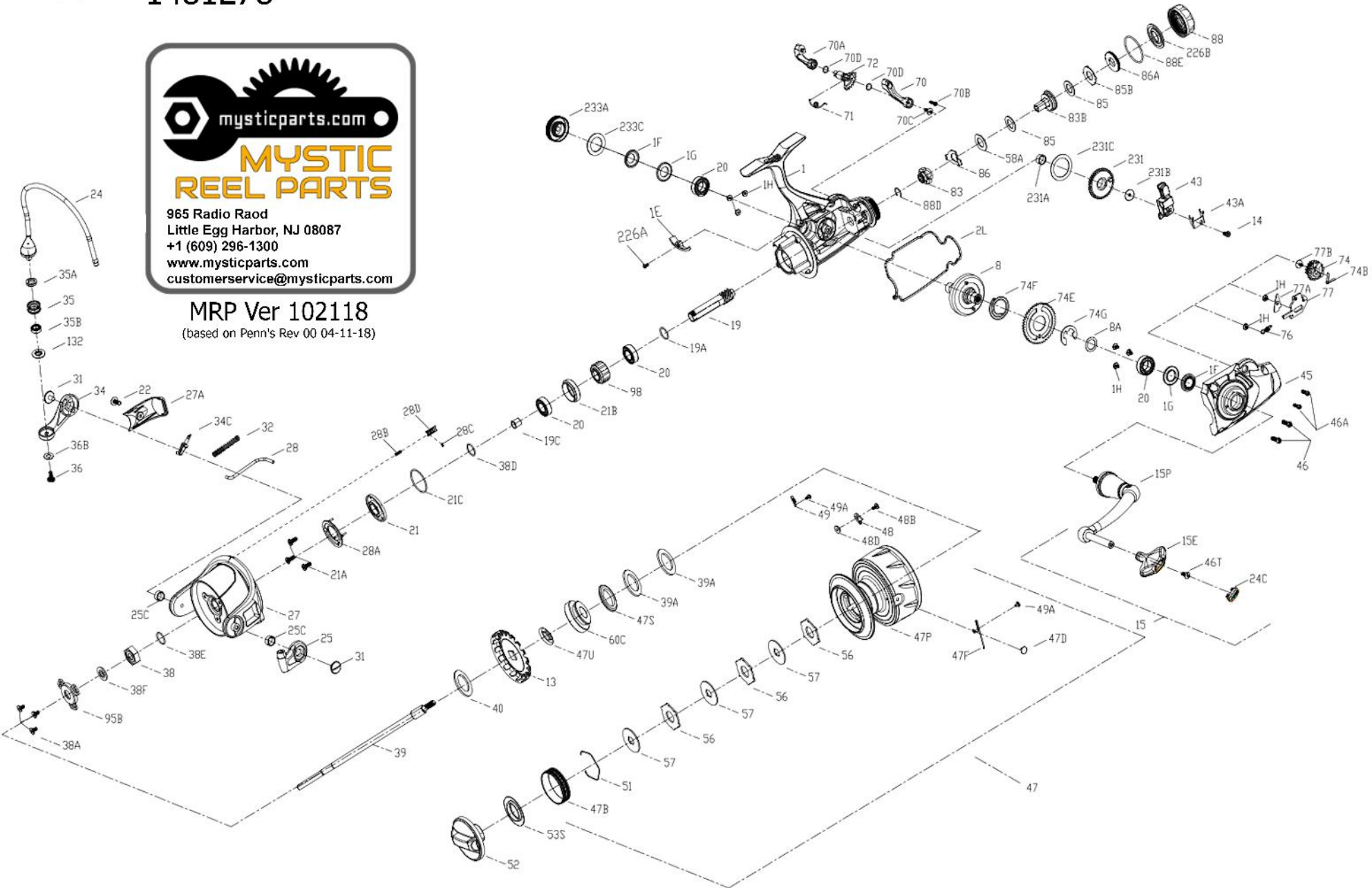

Penn Reel Parts list for Model: SSVi2500LL Spinfisher VI Live Liner (1481277)

KEY	PUREFISHING PART			DESCRIPTION
NO	NO	NO.		
1	1494674	1-SSVi2500LL		BODY/HOUSING
1E	1494675	1E-SSVi2500LL		BODY SLOPE
1F	1418955	1F-SLA3500		BODY BALL BEARING SEAL (2 REQUIRED)
1G	1418956	1G-SLA3500		BODY SIDE SEAL LOCK PLATE (2 REQUIRED)
1H	1418957	1H-SLA3500		BODY SIDE SCREW (8 REQUIRED)
2L	1494676	2L-SSVi2500LL		BODY SEAL
8	1494677	8-SSVi2500LL		DRIVE GEAR (MAIN GEAR)
8A	1418973	8A-SLA3500		DRIVE GEAR SHIM WASHER
13	1418974	13-SLA3500		CLICK GEAR
14	1276992	14-SSV6500LL		SCREW, FOR OSCILLATION SLIDER RETAINER
15	All handle components, see page 3			
19	1418977	19-SSVi2500LL		PINION GEAR
19A	1277424	19A-SLA3500		PINION GEAR WASHER
19C	1418978	19C-SLA3500		PINION GEAR BUSHING
20	SEALED BALL BEARING SEE NOTES PG 3			
21	1418979	21-SSVi2500LL		BALL BEARING RETAINER
21A	1418980	21A-SLA3500		RETAINER SCREW (3 REQUIRED)
21B	1385608	21B-CLA2000		PINION BALL BEARING COLLAR
21C	1494683	21C-SSVi2500LL		BODY HEAD SEAL
22	1092845	22-CLA2000		SCREW, FOR ROTOR COVER
24	1494684	24-SSVi2500LL		BAIL WIRE
25	1494686	25-SSVi2500LL		BAIL HOLDER
25C	1188261	25C-CLA2000		BUSHING, FOR BAIL ARM & HOLDER (2 REQUIRED)
27	1494687	27-SSVi2500LL		ROTOR
27A	1494688	27A-SSVi2500LL		ROTOR COVER
28	1494689	28-SSVi2500LL		ROTOR TRIP LEVER
28A	1494690	28A-SSVi2500LL		ROTOR BRAKE
28B	1346982	28B-CLA2000		SPRING
28C	1206550	28C-CLA2000		ROTOR BRAKE SEAL
28D	1385618	28D-CLA2000		ROTOR BRAKE (RECTANGULAR)
31	1385619	31-CLA2000		BAIL ARM SCREW (2 REQUIRED)
32	1385549	32-CLA3000		BAIL SPRING
34	1385620	34-CLA2000		BAIL ARM
34C	1385551	34C-CLA3000		PIVOT ARM
35	1494691	35-SSVi2500LL		LINE ROLLER
35A	1494692	35A-SSVi2500LL		LINE ROLLER BUSHING
35B	1385552	35A-CLA3000		LINE ROLLER BALL BEARING
36	1389419	36-CLA2000		LINE ROLLER SCREW
36B	1417809	36B-CLA6000		BAIL ARM SCREW WASHER
38	1418993	38-SLA3500		ROTOR NUT
38A	1385554	38A-CLA2000		SCREW (3 REQUIRED)
38D	1257343	38D-SLA3500		ROTOR WASHER
38E	1418958	38E-SLA3500		PINION GEAR SEAL
38F	1418959	38F-SLA3500		ROTOR-MAIN SHAFT SEAL
39	1494693	39-SSVi2500LL		MAIN SHAFT
39A	1494694	39A-SSVi2500LL		WASHER (VARIED THICKNESSES 0.012 TO 0.,040 " THICK)
40	1422917	40-SLA3500		WASHER, KEYED
43	1494695	43-SSVi2500LL		OSCILLATION SLIDER (CROSSWIND BLOCK)
43A	1276996	43A-SSV4500LL		SLIDER RETAINER PLATE
45	1494696	45-SSVi2500LL		BODY COVER ASSEMBLY

KEY	PUREFISHING PART			DESCRIPTION
NO	NO	NO.		
46	1276949	46-SSV3500		BODY COVER SCREW (2 REQUIRED)
46A	1277128	70B-SSV6500LL		DRAG SWITCH LEVER SCREW (2 REQUIRED)
47	1494697	47-SSVi2500LL		SPOOL ASSEMBLY
47B	1277076	47B-SSV5500		SPOOL BAND
47D	1276953	47D-SSV3500		LINE HOOK
47F	1385637	47F-CLA2000		LINE CLIP RETAINER
47P	1494698	47P-SSVi2500LL		SPOOL (BARE)
47S	1494699	47S-SSVi2500LL		SPOOL SEAL
47U	1494700	47U-SSVi2500LL		DRAG COVER SEAL
48	1385578	48-CLA3000		SPOOL CLICK PLATE
48B	1385581	48B-CLA3000		SPOOL CLICKER SPRING SCREW
48D	1385579	48D-CLA3000		SPOOL CLICKER SPACER RING
49	1259579	49-7000AF		SPRING
49A	1294638	49A-CLA2000		SCREW (2 REQUIRED)
51	1277085	51-SSV5500		DRAG WASHER RETAINER
52	1494701	52-SSVi2500LL		DRAG KNOB ASSEMBLY
53S	1447888	53S-CFTii3000		DRAG KNOB SEAL
56	1494702	56-SSVi2500LL		DRAG FRICTION WASHER (3 REQUIRED)
57	1494703	57-SSVi2500LL		KEYED METAL DRAG WASHER (3 REQUIRED)
58A	1494704	58A-SSVi2500LL		EARRER METAL DRAG WASHER
60C	1494705	60C-SSVi2500LL		SPOOL SUPPORT SLEEVE
70	1494706	70-SSVi2500LL		LEVER, LEFT
70A	1494707	70A-SSVi2500LL		LEVER, RIGHT
70B	1277002	70B-SSV4500LL		SCREW, FOR DRAG SWITCH LEVER
70C	1117351	70C-BTLii8000LCLL		SCREW, FOR RIGHT DRAG SWITCH LEVER
70D	1494708	70D-SSVi2500LL		O-RING (2 REQUIRED)
71	1494709	71-SSVi2500LL		SPRING
72	1494710	72-SSVi2500LL		SWITCH CAM
74	1494711	74-SSVi2500LL		CAM GEAR
74B	1494712	74B-SSVi2500LL		SPRING
74E	1494713	74E-SSVi2500LL		GEAR
74F	1494714	74F-SSVi2500LL		SPRING
74G	1277014	74G-SSV4500LL		E-CLIP, FOR THREE PAWL LEVER
76	1277134	76-SSV6500LL		LIVE LINER CLAW SPRING
77	1494715	77-SSVi2500LL		STOP CLAW
77A	1494716	77A-SSVi2500LL		PLATE
77B	1418982	22A-SLA3500		SCREW, FOR DRAG COVER
83	1494717	83-SSVi2500LL		RATCHET
83B SUPPORT ASSEMBLY - SEE PG 3 NOTES				
85	1494719	85-SSVi2500LL		WASHER (2 REQUIRED)
85B	1494720	85B-SSVi2500LL		EARRER METAL WASHER
86	1494721	86-SSVi2500LL		SPRING
86A	1494722	86A-SSVi2500LL		NUT
88	1494723	88-SSVi2500LL		KNOB
88D	1494725	88D-SSVi2500LL		RETAINER
88E	1494724	88E-SSVi2500LL		O-RING
95B	1419009	95B-SLA3500		ROTOR NUT LOCKING PLATE
98	1257345	98-CLA2000		CLUTCH/SLEEVE ASSEMBLY
132	1494726	132-SSVi2500LL		LINE ROLLER COLLAR

KEY PUREFISHING PART

<u>NO</u>	<u>NO</u>	<u>NO.</u>	<u>DESCRIPTION</u>
226A	1385651	226A-CLA2000	REAR COVER SCREW (3 REQUIRED)
226B	1494727	226B-SSVi2500LL	KNOB SEAL
231	1494728	231-SSVi2500LL	OSCILLAION GEAR (CROSSWIND GEAR)
231A	1385595	231A-CLA2000	OSCILLATION GEAR BUSHING
231B	1307857	231B-SSV3500	OSCILLATION GEAR SCREW

PROBLEMS FOUND WHEN TAKING NEW EARLY REELS APART:

20	1385530	20A-CLA3000	SEALED BALL BEARING (TOO SMALL FOR PINION AND PINION COLLAR - BAD # HERE)
USE:	1308050	20-CFT3000	SEALED BALL BEARING (4 REQUIRED) Same for all 4 locations in reel.

NOTES

83B	1494718	83B-SSVi2500LL	SUPPORT ASSEMBLY (SEE SPRING BELOW)
*	??	83B-SSVi2500LL-1	SUPPORT PIECE BY ITSELF, WE ASSIGNED THIS NUMBER
83C	??	83C-SSVi2500LL	SPRING FOUND ON ASSEMBLY, WE ASSIGNED THIS NUMBER
83D??	??	83D-SSVi2500LL	KEYED RETAINING WASHER, WE ASSIGNED THIS NUMBER

83B is only available as an assembly at this time. The other #s are temporary and not available.

KEY PUREFISHING PART

<u>NO</u>	<u>NO</u>	<u>NO.</u>	<u>DESCRIPTION</u>
231C	1385594	231C-CLA2000	OSCILLATION GEAR WASHER
233A	1419015	233A-SLA3500	HANDLE CAP
233C	1419016	233C-SLA3500	HANDLE CAP WASHER

HANDLE COMPONENTS

15	1494678	15-SSVi2500LL	HANDLE ASSEMBLY (RUBBER KNOB)
15E	1494679	15E-SSVi2500LL	HANDLE KNOB (METAL)
15P	1494680	15P-SSVi2500LL	SUB-HANDLE ASSEMBLY
24C	1494685	24C-SSVi2500LL	HANDLE KNOB CAP (FOR METAL KNOB)
46T	1277046	22-SSV5500	SCREW
15F	N/A	15F-SSVi2500LL	WASHER FOUND BETWEEN 15E + 46T (WAS NOT ON REV 00 SCHEM)

MYSTIC REEL PARTS REVISION!**NOTE:**

Many of www.mysticparts.com schematics include changes that were either made by Penn, or errors found and corrected by our parts dept.
MRP Ver 102118 (Based on Penn's Rev. 00 , 04-1-18)