

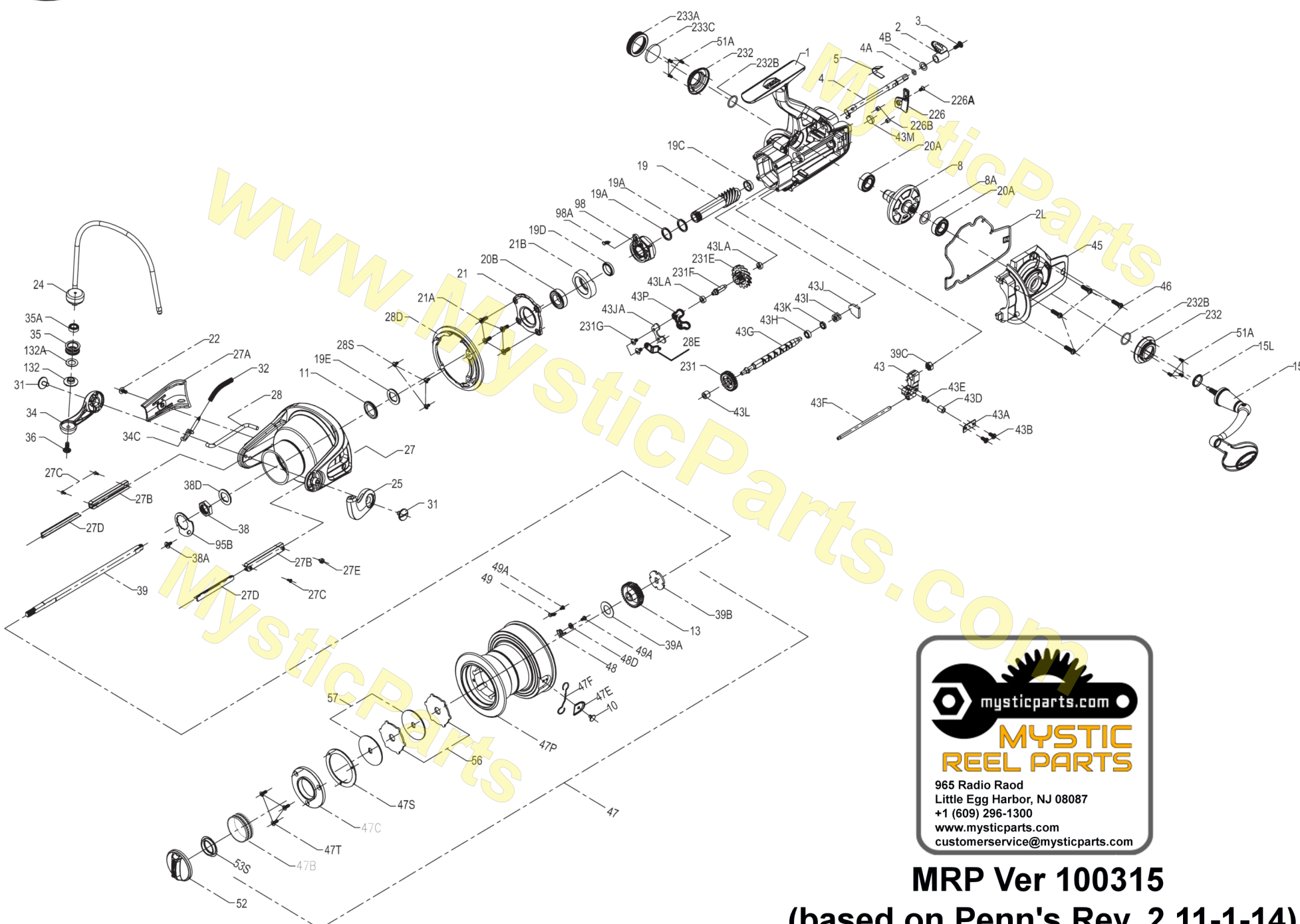

# PARTS LIST FOR MODEL SSV7500LC-USA / SSV7500LC-EU



mysticparts.com  
**MYSTIC REEL PARTS**  
965 Radio Raod  
Little Egg Harbor, NJ 08087  
+1 (609) 296-1300  
www.mysticparts.com  
customerservice@mysticparts.com

**MRP Ver 100315**  
**(based on Penn's Rev. 2 11-1-14)**

# Penn Reel Parts list for Model: SSV7500LC (USA and EU) Spinfisher V Long Cast

KEY	PUREFISHING	PENN PART	DESCRIPTION	KEY	PUREFISHING	PENN PART	DESCRIPTION
NO	NO.	NO.		NO	NO.	NO.	
2	1341498	2-SSV7500LC	A/R BUTTON	38D	1341521	38D-SSV7500LC	ROTOR WASHER
2L	1341499	2L-SSV7500LC	HOUSING BODY SEAL	39A	1341524	39A-SSV7500LC	SPOOL ADJUST WASHER (USES 1 OR 2)
3	1341500	3-SSV7500LC	A/R BUTTON SCREW	39B	1341525	39B-SSV7500LC	MAIN SHAFT WASHER
4	1341501	4-SSV7500LC	A/R LEVER	39C	1259637	39B-SSV7500LC	MAIN SHAFT WASHER
4A	1341502	4A-SSV7500LC	A/R LEVER SEAL	43	1341526	43-SSV7500LC	OSCILLATION SLIDER (CROSSWIND BLOCK)
4B	1361929	4B-SSV7500LC	A/R LEVER WASHER	43A	1259635	43A-7000AF	OSCILLATION SLIDER (CROSSWIND PLATE)
5	1341503	5-SSV7500LC	A/R PAWL SPRING	43B	1276992	14-SSV65000LL	CROSSWIND OSCILLATION SLIDER GUIDE SCREW (2 REQUIRED)
8	1341504	8-SSV7500LC	MAIN DRIVE GEAR	43D	1122193	43D-7000AF	GUIDE CLAW BUSHING
8A	1277146	8A-SSV7500	DRIVE GEAR SHIM WASHER (USES 1 OR 2)	43E	1122192	43E-7000AF	GUIDE CLAW
10	1259574	10-7000AF	LINE CLIP	43F	1341527	43F-SSV7500LC	GUIDE SHAFT
11	1341505	11-SSV7500LC	ROTOR SEAL	43G	1341528	43G-SSV7500LC	WORM SHAFT
13	1347065	13-SSV7500LC	SPOOL CLICKER GEAR	43H	1341529	43H-SSV7500LC	WORM SHAFT BALL BEARING
15	1341506	15-SSV7500LC	HANDLE ASSEMBLY	43i	1341530	43i-SSV7500LC	COMPRESSION SPRING
15L	1292783	15L-SSV5500	HANDLE SEAL	43J	1259620	43J-7000AF	WORM SHAFT TOP RETAINER PLATE
19	1341507	19-SSV7500LC	PINION GEAR	43JA	1341531	43J-SSV7500LC	REAR RETAINER PLATE
19A	1259612	19A-SSV7500LC	PINION GEAR WASHER (2 REQUIRED)	43K	1341532	43K-SSV7500LC	WORM SHAFT WASHER
19C	1341508	19C-SSV7500LC	PINION GEAR POM BUSHING	43L	1341533	43L-SSV7500LC	WORM SHAFT BUSHING
19D	1341509	19D-SSV7500LC	PINION GEAR BRASS BUSHING	43LA	1122132	43L-7000AF	WORM SHAFT BUSHING (2 REQUIRED)
19E	1341608	19E-SSV7500LC	PINION GEAR KEY WASHER	43M	1341534	43M-SSV7500LC	WORM SHAFT SEAL
20A	1277042	20A-SSV5500	BALL BEARING (2 REQUIRED)	43P	1361931	43P-SSV7500LC	WORM SHAFT RETAINER SEAL
20B	1344681	20B-SSV7500	SEALED BALL BEARING	45	1341535	45-SSV7500LC	HOUSING / BODY COVER
21	1341510	21-SSV7500LC	PINION BEARING RETAINER	46	1277074	46-SSV5500	HOUSING / BODY COVER SCREW (4 REQUIRED)
21A	1277044	21A-SSV5500	PINION RETAINER SCREW (4 REQUIRED)	47C	1341540	47C-SSV7500LC	DRAG COVER
21B	1341511	21B-SSV7500LC	PINION BALL BEARING COLLAR	47E	1277079	47E-SSV5500	LINE CLIP BUSHING
22	1276928	22-SSV3500	ROTOR COVER SCREW	47F *	<i>see corrections page 3</i>		
24	1341512	24-SSV7500LC	BAIL ASSEMBLY	47S	1341543	47S-SSV7500LC	DRAG COVER / DRIVE PLATE SEAL
25	1277157	25-SSV7500	BAIL HOLDER (BAIL CAM)	47T	1341544	47T-SSV7500LC	DRAG COVER SCREW (3 REQUIRED)
27	1341513	27-SSV7500LC	ROTOR	48	1259577	48-7000AF	SPOOL CLICK PLATE
27A	1341514	27A-SSV7500LC	ROTOR COVER	48D	1341546	48D-SSV7500LC	SPOOL CLICKER SPACER RING
27B	1341515	27B-SSV7500LC	LINE GUARD HOLDER (2 REQUIRED)	49	1259579	49-7000AF	SPOOL CLICK SPRING
27C	1341516	27C-SSV7500LC	LINE GUARD HOLDER SCREW (3 REQUIRED)	49A	1341547	49A-SSV7500LC	SPOOL CLICKER SPRING SCREW (2 REQUIRED)
27E	1341517	27E-SSV7500LC	LINE GUARD HOLDER SCREW	51A	1277086	51A-SSV5500	BEARING RETAINER SCREW (6 REQUIRED)
27D	1259583	27D-7500AF	LINE GUARD (2 REQUIRED)	53S	1293252	53S-SSV5500	DRAG KNOB SEAL
28	1341518	28-SSV7500LC	BAIL TRIP LEVER	56	1341550	56-SSV7500LC	DRAG FRICTION WASHER HT100 (2 REQUIRED)
28D	1341519	28D-SSV7500LC	ROTOR BRAKE	57	1341551	57-SSV7500LC	KEYED METAL DRAG WASHER (2 REQUIRED)
28E	1341520	28E-SSV7500LC	BRAKE RETAINER PLATE	95B	1277189	95B-SSV7500	ROTOR NUT LOCKING PLATE
28S	1277054	28S-SSV5500	ROTOR BRAKE SCREW (3 REQUIRED)	98	1259618	98-7000AF	CLUTCH / SLEEVE ASSEMBLY
31	1277055	31-SSV5500	BAIL ARM SCREW (2 REQUIRED)	98A	1361930	98A-SSV7500LC	CLUTCH ASSEMBLY SPRING
32	1259546	32-7000AF	BAIL SPRING	132	1277192	132-SSV7500	LINE ROLLER COLLAR
34	1277163	34-SSV7500	BAIL ARM	132A	1277097	132A-SSV5500	LINE ROLLER WASHER
34C	1277164	34C-SSV7500	PIVOT ARM	226	1341552	226-SSV7500LC	REAR COVER
35	1277165	35-SSV7500	LINE ROLLER	226A	1341553	226A-SSV7500LC	REAR COVER SCREW
35A	1277060	35A-SSV5500	LINE ROLLER BALL BEARING	226B	1341554	226B-SSV7500LC	BODY REAR SEAL (2 REQUIRED)
36	1277166	36-SSV7500	LINE ROLLER SCREW	231	1341555	231-SSV7500LC	CROSSWIND OSCILLATION GEAR
38A	1277063	38A-SSV5500	ROTOR NUT LOCK PLATE SCREW				

KEY	PUREFISHING	PENN PART	DESCRIPTION
NO	NO.	NO.	
231E	1341556	231E-SSV7500LC	SLOW OSCILLATION GEAR
231F	1259621	231F-7000AF	SLOW OSCILLATION GEAR PIN
231G	1277070	43B-SSV5500	OSCILLATION GEAR PIN SCREW (2 REQUIRED)
232	1341557	232-SSV7500LC	BEARING RETAINER (2 REQUIRED)
232B	1302502	232B-SSV3500	BEARING RETAINER O'RING (2 REQUIRED)
233A	1277103	233A-SSV5500	HANDLE CAP
233C	1277107	233C-SSV5500	HANDLE CAP WASHER

**USA Version Different Parts**

1	1341497	1-SSV7500LC	HOUSING, BODY ASSEMBLY (USA)
39	1341522	39-SSV7500LC-USA	MAIN SPOOL SHAFT
47	1341536	47-SSV7500LC-USA	SPOOL ASSEMBLY
47B	1341538	47B-SSV7500LC-USA	SPOOL BAND
47P	1341541	47P-SSV7500LC-USA	SPOOL, BARE
52	1341548	52-SSV7500LC-USA	DRAG KNOB ASSEMBLY

**CORRECTIONS:**

38	<b>1309004</b>	<b>38-SSV9500</b>	<b>ROTOR NUT (REV. 2) ** USE this! **</b>
	1277467	<del>38-SSV7500</del>	ROTOR NUT (REV. 1 - INCORRECT #!!!)
47F	<b>1259575</b>	<b>47F-7000AF</b>	<b>LINE CLIP RETAINER *** USE THIS! ***</b>
	1277442	<del>47F-SSV6500</del>	LINE CLIP RETAINER (incorrectly listed)

corrected 5/17/23

<https://www.mysticparts.com/PennParts/PennSSV7500LC.aspx>

KEY	PUREFISHING	PENN PART	DESCRIPTION
NO	NO.	NO.	

**MYSTIC REEL PARTS REVISION!**

**NOTE:**

Many of www.mysticparts.com schematics include changes that were either made by Penn, or errors found and corrected by our parts dept.

**MRP Ver 051423 (based on Penn's Rev 4 4-17-2015)**

**MRP Ver 032924 (The SSV design change issues with Housings/CrosswindGear/Plate DOES NOT APPLY to the LC reel)**

**European Version Different Parts**

1	1344371	1-SSV7500LC	HOUSING, BODY ASSEMBLY (EU)
39	1341523	39-SSV7500LC-EU	MAIN SPOOL SHAFT
47	1341537	47-SSV7500LC-EU	SPOOL ASSEMBLY
47B	1341539	47B-SSV7500LC-EU	SPOOL BAND
47P	1341542	47P-SSV7500LC-EU	SPOOL, BARE
52	1341549	52-SSV7500LC-EU	DRAG KNOB ASSEMBLY