

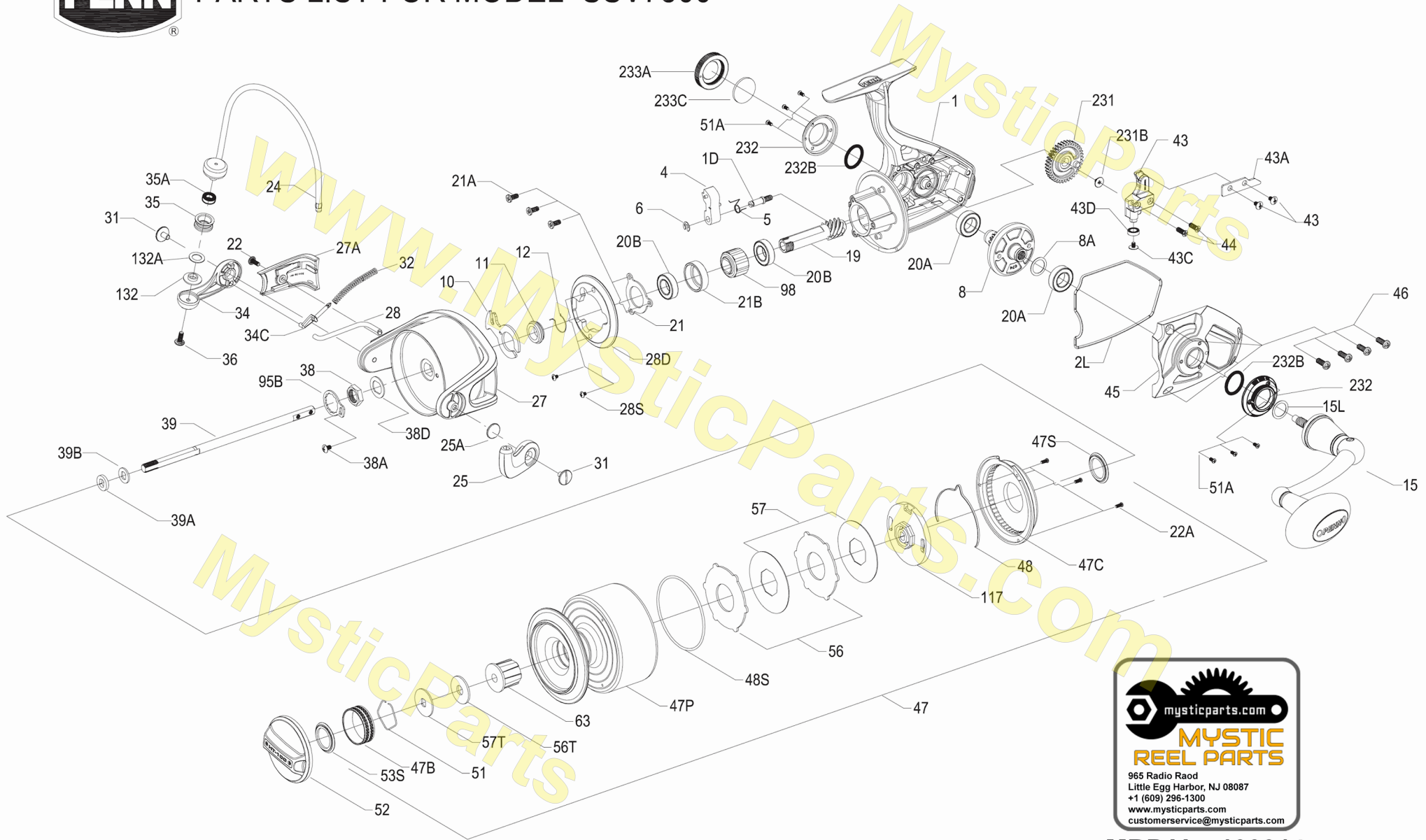

PARTS LIST FOR MODEL SSV7500



MRP Ver 100314
(based on Penn's Rev. 4 10-01-14)

Penn Reel Parts list for Model: SSV7500 Spinfisher V

KEY	PUREFISHING	PENN PART		
NO	NO.	NO.	DESCRIPTION	
1 SEE PAGE 3				
1D	1277140	1D-SSV7500	A/R PAWL POST	
2L	1277141	2L-SSV7500	HOUSING BODY SEAL	
4	1277142	4-SSV7500	A/R PAWL	
5	1277143	5-SSV7500	A/R PAWL SPRING	
5	1277144	6-SSV7500	RETAINER CLIP	
8	1277145	8-SSV7500	MAIN DRIVE GEAR	
8A	1277146	8A-SSV7500	DRIVE GEAR SHIM WASHER (USES 1 OR 2)	
10	1277147	10-SSV7500	A/R PAWL HOLDER	
11	1277148	11-SSV7500	A/R BUSHING	
12	1277149	12-SSV7500	A/R BUSHING SPRING	
15	1277150	15-SSV7500	HANDLE ASSEMBLY	
15L	1292784	15L-SSV7500	HANDLE SEAL	
15M	1276922	15M-SSV3500	HANDLE CAP LOCK PIN (2 REQUIRED)	
15N	1277040	15N-SSV5500	HANDLE CAP LOCK PIN SPRING (2 REQUIRED)	
19	1277151	19-SSV7500	PINION GEAR	
20A, 20B SEE PAGE 3				
21	1277153	21-SSV7500	PINION BEARING RETAINER	
21A	1277154	21A-SSV7500	PINION RETAINER SCREW (3 REQUIRED)	
21B	1277155	21B-SSV7500	PINION BALL BEARING COLLAR	
22	1277046	22-SSV5500	ROTOR COVER SCREW	
22A	1277047	22A-SSV5500	DRAG COVER SCREW (3 REQUIRED)	
24	1277156	24-SSV7500	BAIL ASSEMBLY	
25	1277157	25-SSV7500	BAIL HOLDER (BAIL CAM)	
25A	??	25A-SSV3500	SHIM	
27	1277158	27-SSV7500	ROTOR	
27A	1277159	27A-SSV7500	ROTOR COVER	
28	1277160	28-SSV7500	BAIL TRIP LEVER	
28D	1277161	28D-SSV7500	ROTOR BRAKE	
28S	1277054	28S-SSV5500	ROTOR BRAKE SCREW (2 REQUIRED)	
31	1277055	31-SSV5500	BAIL ARM SCREW (2 REQUIRED)	
32	1277162	32-SSV7500	BAIL SPRING	
34	1277163	34-SSV7500	BAIL ARM	
34C	1277164	34C-SSV7500	PIVOT ARM	
35	1277165	35-SSV7500	LINE ROLLER	
35A	1277060	35A-SSV5500	LINE ROLLER BALL BEARING	
36	1277166	36-SSV7500	LINE ROLLER SCREW	
38	1277167	38-SSV7500	ROTOR NUT	
38A	1277063	38A-SSV5500	ROTOR NUT LOCK PLATE SCREW	

KEY	PUREFISHING	PENN PART		
NO	NO.	NO.	DESCRIPTION	
38D	1277168	38D-SSV7500	ROTOR WASHER	
39	1277169	39-SSV7500	MAIN SPOOL SHAFT	
39A	1277170	39A-SSV7500	SPOOL ADJUST WASHER (USES 1 OR 2)	
39B	1277171	39B-SSV7500	MAIN SHAFT WASHER	
43	1277172	43-SSV7500	OSCILLATION SLIDER (CROSSWIND BLOCK)	
43A	1277173	43A-SSV7500	OSCILLATION SLIDER GUIDE (CROSSWIND PLATE)	
43B	1277070	43B-SSV5500	CROSSWIND OSCILLATION SLIDER GUIDE SCREW (2 REQUIRED)	
43C	1277071	43C-SSV5500	CROSSWIND OSCILLATION SLIDER BUSHING SCREW	
43D	1279457	43D-SSV3500	CROSSWIND OSCILLATION SLIDER BUSHING	
44	1277174	44-SSV7500	MAIN SHAFT SCREW (2 REQUIRED)	
45 SEE PAGE 3				
46	1277176	46-SSV7500	HOUSING / BODY COVER SCREW (4 REQUIRED)	
47	1277177	47-SSV7500	SPOOL ASSEMBLY	
47B	1277076	47B-SSV5500	SPOOL BAND	
47C	1277178	47C-SSV7500	DRAG COVER	
47P	1277180	47P-SSV7500	SPOOL, BARE	
47S	1277082	47S-SSV5500	DRAG COVER / DRIVE PLATE SEAL	
48	1277181	48-SSV7500	SPOOL CLICKER	
48S	1277182	48S-SSV7500	DRAG COVER SEAL	
51	1277085	51-SSV5500	DRAG WASHER RETAINING RING	
51A	1277183	51A-SSV7500	BEARING RETAINER SCREW (6 REQUIRED)	
52	1277184	52-SSV7500	DRAG KNOB ASSEMBLY	
53S	1293253	53S-SSV7500	DRAG KNOB SEAL	
56	1277185	56-SSV7500	DRAG FRICTION WASHER HT100 (2 REQUIRED)	
56T	1277089	56T-SSV5500	DRAG FRICTION WASHER HT100	
57	1277186	57-SSV7500	KEYED METAL DRAG WASHER (2 REQUIRED)	
57T	1277187	57T-SSV7500	KEYED METAL DRAG WASHER	
63	1277188	63-SSV7500	SPOOL BUSHING	
95B	1277189	95B-SSV7500	ROTOR NUT LOCKING PLATE	
98	1277190	98-SSV7500	CLUTCH / SLEEVE ASSEMBLY	
117	1277191	117-SSV7500	DRAG DRIVE PLATE	
132	1277192	132-SSV7500	LINE ROLLER COLLAR	
132A	1277097	132A-SSV5500	LINE ROLLER WASHER	
231 SEE PAGE 3				
231B SEE PAGE 3				
232	1277194	232-SSV7500	BEARING RETAINER (2 REQUIRED)	
232B	1302503	232B-SSV7500	BEARING RETAINER O'RING (2 REQUIRED)	
233A	1277196	233A-SSV7500	HANDLE CAP	
233C	1277197	233C-SSV7500	HANDLE CAP WASHER	

MYSTIC REEL PARTS REVISION!

NOTE:

Many of www.mysticparts.com schematics include changes that were either made by Penn, or errors found and corrected by our parts dept.

MRP Ver 100314 (Based on Penn's Rev. 4, 10-01-14)

MRP Ver 032924 (Parts List updated to clarify housing/gearing design changes sizing)

DESIGN CHANGES

KEY NO.	PUREFISHING NO.	PENN PART NO.	DESCRIPTION
---------	-----------------	---------------	-------------

KEY NO.	PUREFISHING NO.	PENN PART NO.	DESCRIPTION
---------	-----------------	---------------	-------------

REV 1. Bearing number changes

20A	1277152	20A-SSV7500	BALL BEARING (4 REQUIRED)
-----	---------	-------------	---------------------------

REV. 4 Bearings

20A	1277152	20A-SSV7500	BALL BEARING (2 REQUIRED)
20B	1344681	20B-SSV7500	BALL BEARING, SEALED (2 REQUIRED)

We are assuming there were errors with the bearing part numbers on the schematic, rather than that they actually changed the bearings.

RECOMMEND TO USE THE REVISION 4 NUMBERS

******* DESIGN CHANGE WARNING *******

Early SSV reels when released had a slightly different housing, crosswind gear and housing cover

The diameter of the CW gear hole and post was CHANGED and the pin/pin hole diameters on the 45- cover were changed as well

THIS DESIGN CHANGE affects the housing, crosswind gear, and housing cover

MEASURE YOUR HOUSING/GEAR

At the post where the crosswind sits or the hole in the center of the crosswind gear.

Parts that you order MUST MATCH EACH OTHER

Some parts may no longer be available, so check all three parts for availability and matching size

******* BEFORE YOU PLACE AN ORDER! *******

MEASURE and CHECK STOCK FIRST! .23 peg (1/4") SIZE

1	NLA **	1-SSV7500	HOUSING, BODY ASSEMBLY with .23 peg (1/4")
231	1277193	231-SSV7500	CROSSWIND OSCILLATION GEAR 0.23" I.D. (1/4")
45	NLA **	45-SSV6500	HOUSING / BODY COVER to match (1/4")
231B	1307857	231B-SSV3500	CROSSWIND OSCILLATION GEAR SCREW (1/4")

MEASURE and CHECK STOCK FIRST! .309 peg (5/16")

1	1277139	1-SSV7500	HOUSING, BODY ASSEMBLY with .309 peg (5/16")
231	1277193	231-SSV7500	CROSSWIND OSCILLATION GEAR 1st run 0.309" I.D. (5/16")
45	1277175	45-SSV7500	HOUSING / BODY COVER to match (5/16")
231B	1277100	231B-SSV5500	CROSSWIND OSCILLATION GEAR SCREW (5/16")

**** NLA = NOT AVAILABLE as of 2024 updates (design changes were first noted back in 2014)**

<https://www.mysticparts.com/PennParts/PennSSV7500.aspx>