

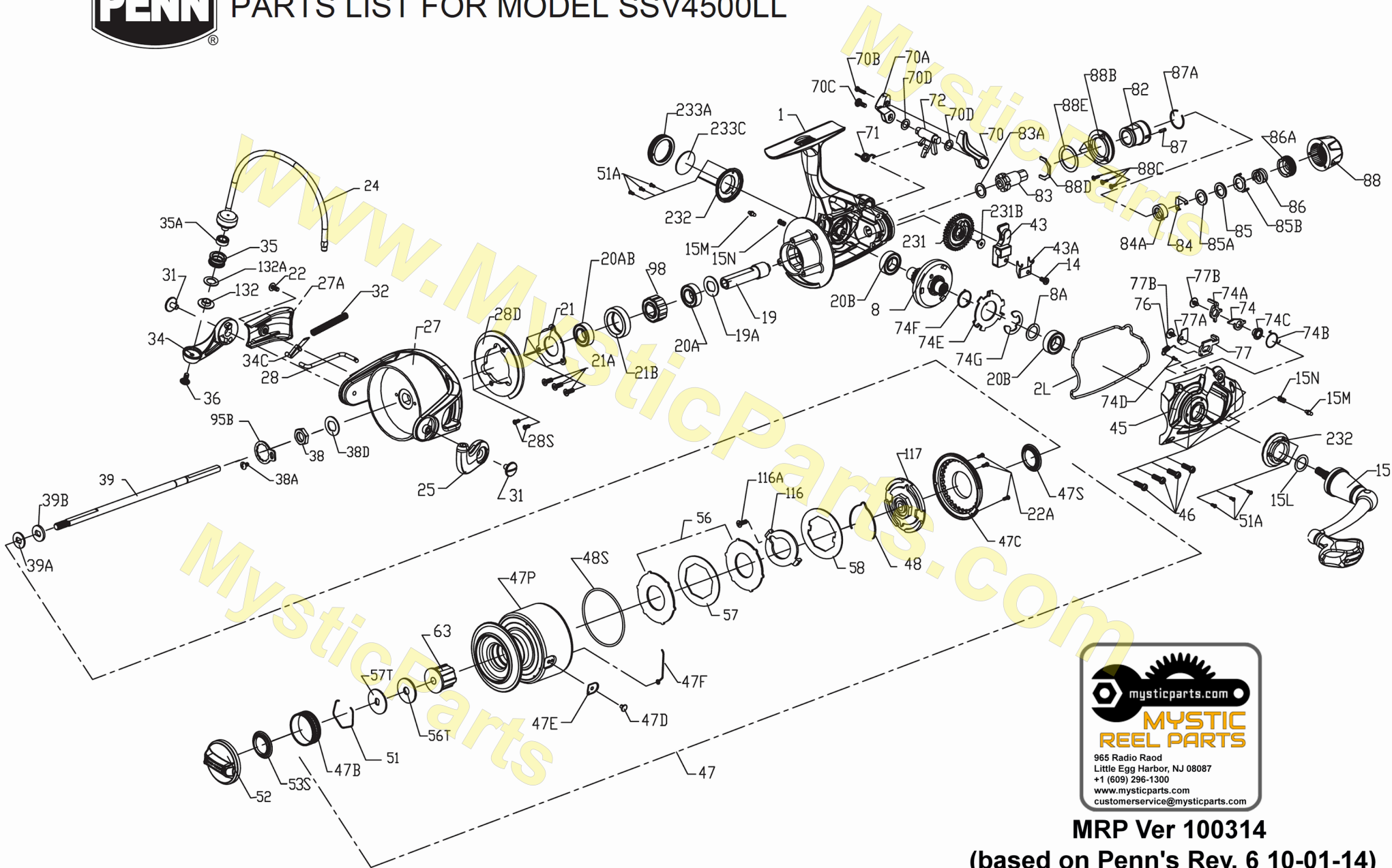

# PARTS LIST FOR MODEL SSV4500LL



**MRP Ver 100314**  
**(based on Penn's Rev. 6 10-01-14)**

## Penn Reel Parts list for Model: SSV4500LL Spinfisher V Live Liner

KEY NO	PUREFISHING NO.	PENN PART NO.	DESCRIPTION	KEY NO	PUREFISHING NO.	PENN PART NO.	DESCRIPTION
<b>1</b>	<b>SEE PAGE 3</b>			<b>52, 53S</b>	<b>SEE PAGE 3</b>		
2L	1276990	2L-SSV4500LL	HOUSING BODY SEAL	51A	1277086	51A-SSV5500	BEARING RETAINER SCREW (6 REQUIRED)
8	1276991	8-SSV4500LL	MAIN DRIVE GEAR	56	1276961	56-SSV3500	DRAG FRICTION WASHER HT100 (2 REQUIRED)
8A	1276920	8A-SSV3500	DRIVE GEAR SHIM WASHER	56T	1277089	56T-SSV5500	DRAG FRICTION WASHER HT100
14	1276992	14-SSV6500LL	OSCILLATION SLIDER RETAINER SCREW	57	1276963	57-SSV3500	KEYED METAL DRAG WASHER
15	1276921	15-SSV3500	HANDLE ASSEMBLY	57T	1276985	57T-SSV4500	KEYED METAL DRAG WASHER
15L	1292782	15L-SSV3500	HANDLE SEAL	58	1290705	58-SSV3500	EARED METAL DRAG WASHER
19	1276923	19-SSV4500LL	PINION GEAR	63	1276986	63-SSV4500	SPOOL BUSHING
19A	1277424	19A-SSV3500	PINION GEAR WASHER	70	1277000	70-SSV4500LL	LIVE LINER DRAG SWITCH LEVER (LEFT)
<b>20A, 20B, 20AB</b>	<b>SEE PAGE 3</b>			70A	1277001	70A-SSV4500LL	LIVE LINER DRAG SWITCH LEVER (RIGHT)
21	1276925	21-SSV3500	PINION BEARING RETAINER	70B	1277002	70B-SSV4500LL	LIVE LINER DRAG SWITCH LEVER SCREW
21A	1276926	21A-SSV3500	PINION RETAINER SCREW (3 REQUIRED)	70C	1277003	70C-SSV4500LL	LIVE LINER DRAG SWITCH LEVER SCREW
21B	1276927	21B-SSV3500	PINION BALL BEARING COLLAR	70D	1277004	70D-SSV4500LL	LIVE LINER DRAG SWITCH LEVER SEAL (2 REQUIRED)
22	1276928	22-SSV3500	ROTOR COVER SCREW	71	1277005	71-SSV4500LL	LIVE LINER LEVER SPRING
22A	1277047	22A-SSV5500	DRAG COVER SCREW (3 REQUIRED)	72	1277006	72-SSV4500LL	LIVE LINER DRAG SWITCH CAM
24	1276975	24-SSV4500	BAIL ASSEMBLY	74	1277007	74-SSV4500LL	LIVE LINER TRIP LEVER (A)
25	1276930	25-SSV3500	BAIL HOLDER (BAIL CAM)	74A	1277008	74A-SSV4500LL	LIVE LINER TRIP LEVER (B)
27	1276976	27-SSV4500	ROTOR	74B	1277009	74B-SSV4500LL	LIVE LINER TRIP LEVER SPRING
27A	1276977	27A-SSV4500	ROTOR COVER	74C	1277010	74C-SSV4500LL	LIVE LINER TRIP LEVER BUSHING
28	1276978	28-SSV4500	BAIL TRIP LEVER	74D	1277011	74D-SSV4500LL	LIVE LINER STOP CLAW SPRING SCREW
28D	1276979	28D-SSV4500	ROTOR BRAKE	74E	1277012	74E-SSV4500LL	LIVE LINER THREE PAWL LEVER
28S	1276935	28S-SSV3500	ROTOR BRAKE SCREW (2 REQUIRED)	74F	1277013	74F-SSV4500LL	LIVE LINER THREE PAWL LEVER SPRING
31	1276936	31-SSV3500	BAIL ARM SCREW (2 REQUIRED)	74G	1277014	74G-SSV4500LL	LIVE LINER THREE PAWL LEVER E-CLIP
32	1276937	32-SSV3500	BAIL SPRING	76	1277134	76-SSV6500LL	LIVE LINER CLAW SPRING
34	1276938	34-SSV3500	BAIL ARM	77	1277015	77-SSV4500LL	LIVE LINER STOP CLAW
34C	1277058	34C-SSV5500	PIVOT ARM	77A	1277016	77A-SSV4500LL	LIVE LINER PLATE
35	1276939	35-SSV3500	LINE ROLLER	77B	1289972	77B-SSV4500LL	LIVE LINER PLATE SCREW (2 REQUIRED)
35A	1276940	35A-SSV3500	LINE ROLLER BALL BEARING	82	1277017	82-SSV4500LL	REAR DRAG HOUSING
36	1277061	36-SSV5500	LINE ROLLER SCREW	83	1277018	83-SSV4500LL	REAR DRAG RATCHET
38	1276941	38-SSV3500	ROTOR NUT	83A	1277019	83A-SSV4500LL	REAR DRAG RATCHET WASHER
38A	1277063	38A-SSV5500	ROTOR NUT LOCK PLATE SCREW (3 REQUIRED)	84	1277020	84-SSV4500LL	REAR DRAG CLICKER
38D	1276942	38D-SSV3500	ROTOR WASHER	84A	1277021	84A-SSV4500LL	REAR DRAG CLICKER RETAINER
39	1276994	39-SSV4500LL	MAIN SPOOL SHAFT	85	1277022	85-SSV4500LL	REAR DRAG WASHER
39A	1276944	39A-SSV3500	SPOOL ADJUST WASHER	85A	1277023	85A-SSV4500LL	REAR DRAG KEYED WASHER
39B	1276945	39B-SSV3500	MAIN SHAFT WASHER	85B	1277024	85B-SSV4500LL	REAR DRAG EARED WASHER
43	1276995	43-SSV4500LL	OSCILLATION SLIDER (CROSSWIND BLOCK)	86	1277025	86-SSV4500LL	REAR DRAG SPRING
43A	1276996	43A-SSV4500LL	OSCILLATION SLIDER GUIDE (CROSSWIND PLATE)	86A	1277026	86A-SSV4500LL	REAR DRAG NUT
<b>45</b>	<b>SEE PAGE 3</b>			87	1277027	87-SSV4500LL	REAR DRAG KNOB CLICKER
46	1276949	46-SSV3500	HOUSING / BODY COVER SCREW (4 REQUIRED)	87A	1277028	87A-SSV4500LL	REAR DRAG KNOB CLICKER RING
47	1276998	47-SSV4500LL	SPOOL ASSEMBLY	88	1277029	88-SSV4500LL	REAR DRAG KNOB
47B	1277076	47B-SSV5500	SPOOL BAND	88B	1277030	88B-SSV4500LL	REAR DRAG KNOB RING
47C	1276952	47C-SSV3500	DRAG COVER	88C	1277031	88C-SSV4500LL	REAR DRAG KNOB RING SCREW (3 REQUIRED)
47D	1276953	47D-SSV3500	LINE CLIP	88D	1277032	88D-SSV4500LL	REAR DRAG KNOB RETAINER
47E	1276954	47E-SSV3500	LINE CLIP BUSHING	88E	1277033	88E-SSV4500LL	REAR DRAG KNOB SEAL
47F	1276983	47F-SSV4500	LINE CLIP RETAINER	95B	1277093	95B-SSV5500	ROTOR NUT LOCKING PLATE
47P	1276999	47P-SSV4500LL	SPOOL, BARE	98	1276966	98-SSV3500	CLUTCH / SLEEVE ASSEMBLY
47S	1277082	47S-SSV5500	DRAG COVER / DRIVE PLATE SEAL	116	1279458	116-SSV3500	KEYED DRAG WASHER LOCK PLATE
48	1276957	48-SSV3500	SPOOL CLICKER	116A	1279509	116A-SSV3500	KEYED DRAG WASHER LOCK PLATE SCREW
48S	1276958	48S-SSV3500	DRAG COVER SEAL	117	1276967	117-SSV3500	DRAG DRIVE PLATE
51	1277085	51-SSV5500	DRAG WASHER RETAINING RING				

MysticParts

[www.MysticParts.com](http://www.MysticParts.com)

MysticParts

KEY NO	PUREFISHING NO.	PENN PART NO.	DESCRIPTION
132	1277096	132-SSV5500	LINE ROLLER COLLAR
132A	1277097	132A-SSV5500	LINE ROLLER WASHER

231 SEE PAGE 3

231B SEE PAGE 3

232	1276988	232-SSV4500	BEARING RETAINER (2 REQUIRED)
232B	1302502	232B-SSV3500	BEARING RETAINER O-RING (2 REQUIRED)
233A	1276972	233A-SSV3500	HANDLE CAP
233C	1276973	233C-SSV3500	HANDLE CAP WASHER

### Design Changes

231B	1307857	231B-SSV3500	CROSSWIND OSCILLATION GEAR SCREW (EARLY SCHEMATICS LISTED 231B-SSV5500)
------	---------	--------------	--

KEY NO	PUREFISHING NO.	PENN PART NO.	DESCRIPTION
--------	-----------------	---------------	-------------

### MYSTIC REEL PARTS REVISION!

NOTE:

Many of www.mysticparts.com schematics include changes that were either made by Penn, or errors found and corrected by our parts dept.

MRP Ver 020123 (Based on Penn's Rev. 6, 10-01-14)

**MRP Ver 032924 (Parts List updated to clarify housing/gearing design changes sizing)**

15M,15N REMOVED (NOT PURCHASABLE?)

1276922	15M-SSV3500	HANDLE CAP LOCK PIN (2 REQUIRED)
1277040	15N-SSV3500	HANDLE CAP LOCK PIN SPRING (2 REQUIRED)

### Rev. 4 CHANGED BEARING INFORMATION ----->

20A	1276924	20A-SSV3500	BALL BEARING (2 REQUIRED) THIS WAS UPPER AND LOWER PINION BEARING
20B	1192619	20B-3000SG	BALL BEARING (2 REQUIRED)

We are assuming there were errors with the bearing part numbers on the schematic, rather than that they actually changed the bearings.

### Revision 6 Bearings

20A	1276924	20A-SSV3500	BALL BEARING
20AB	1308051	20A-CFT3000	UPPER PINION BALL BEARING
20B	1317496	20B-SSV3500	BALL BEARING (2 REQUIRED)

**RECOMMEND TO USE THE REVISION 6 NUMBERS**

### DRAG KNOB SEAL ISSUE on SSV4500 and SSV4500LL reels

52	1276960	52-SSV3500	DRAG KNOB ASSEMBLY Sold by Penn w/Seal 53S-SSV3500 included
53S	<b>1293252</b>	<b>53S-SSV5500</b>	Actual DRAG KNOB SEAL that is on the SSV4500 and SSV4500LL reels (ERROR Penns schematics list the 53S-SSV3500 which is the smaller seal NOT used on these models) So if you want the correct size seal you need to order that part separately

### \*\*\*\*\* DESIGN CHANGE WARNING \*\*\*\*\*

Early SSV reels when released had a slightly different housing, crosswind gear and housing cover

The diameter of the CW gear hole and post was CHANGED and the pin/pin hole diameters on the 45- cover were changed as well

THIS DESIGN CHANGE affects the housing, crosswind gear, and housing cover

### MEASURE YOUR HOUSING/GEAR

At the post where the crosswind sits or the hole in the center of the crosswind gear.

**Parts that you order MUST MATCH EACH OTHER**

**Some parts may no longer be available, so check all three parts for availability and matching size**

**\*\*\*\*\* BEFORE YOU PLACE AN ORDER! \*\*\*\*\***

### MEASURE and CHECK STOCK FIRST! .23 peg (1/4") SIZE

1	1276989	1-SSV4500LL	HOUSING, BODY ASSEMBLY with .23 peg (1/4")
231	1276987	231-SSV4500	CROSSWIND OSCILLATION GEAR 0.23" I.D. (1/4")
45	1276997	45-SSV4500LL	HOUSING / BODY COVER to match (1/4")
231B	1307857	231B-SSV3500	CROSSWIND OSCILLATION GEAR SCREW (1/4")

### MEASURE and CHECK STOCK FIRST! .309 peg (5/16")

1	<b>NLA **</b>	1-SSV4500LL	HOUSING, BODY ASSEMBLY with .309 peg (5/16")
231	<b>NLA **</b>	231-SSV4500	CROSSWIND OSCILLATION GEAR 1st run 0.309" I.D. (5/16")
45	<b>NLA **</b>	45-SSV4500LL	HOUSING / BODY COVER to match (5/16")
231B	1277100	231B-SSV5500	CROSSWIND OSCILLATION GEAR SCREW (5/16")

**NOTE: We never received or saw anything for this SSV4500LL reel in 5/16" 2014 - 2024**

**\*\* NLA = NOT AVAILABLE as of 2024 updates (design changes were first noted back in 2014)**