

18-WASHER
ORIENTATION

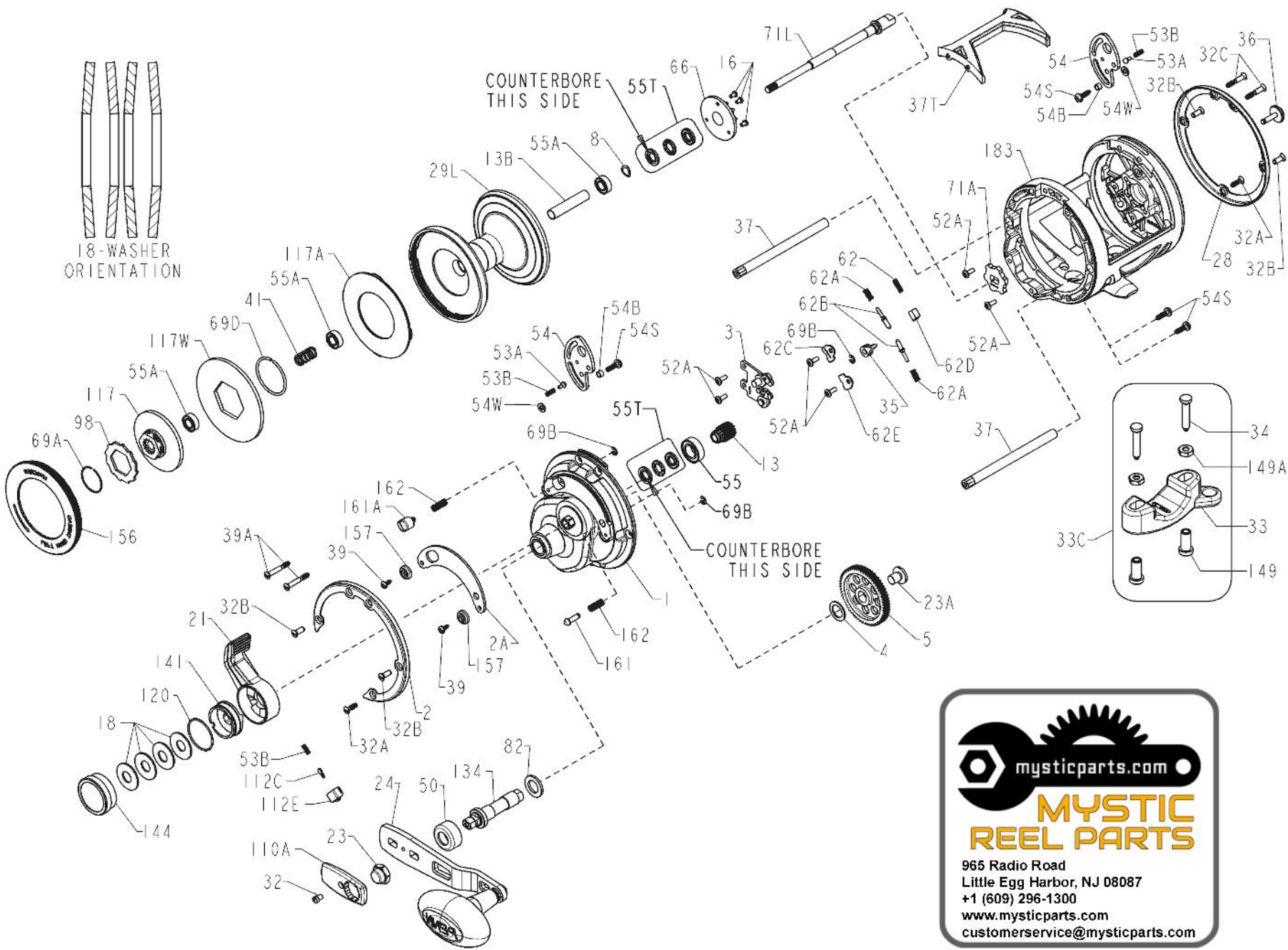

mysticparts.com

MYSTIC REEL PARTS

965 Radio Road
Little Egg Harbor, NJ 08087
+1 (609) 296-1300
www.mysticparts.com
customerservice@mysticparts.com

MRP VER. 01/31/21
(Based on Penn's Rev 2 9-25-2013)



PARTS LIST FOR MODEL SQL60LDLH

REELASM NO 1238642

Penn Reel Parts list for Model: SQL60LDLH Squall 60 Leverdrag (LEFT HAND)

KEY	Penn Part	PureFishing		KEY	Penn Part	PureFishing
NO	Number	Part#	DESCRIPTION	NO	Number	Part#
1	1-60SLDLH	1260188	HANDLE SIDE PLATE (LEFT HAND)	54W	54W-50SLD	1239365
2	2-60SLDLH	1260190	RING, RIGHT SIDE PLATE (LEFT HAND)	55	55-50SLD	1239366
2A	2A-50SLD	1239333	RING, RIGHT SIDE PLATE	55A	55A-50SLD	1238912
3	3-60SLDLH	1260192	DOG BRIDGE ASSM. (LEFT HAND)	62	62-TRQ40	1236596
4	4-25	1180750	FIBER WASHER	62A	62A-310	1184033
5	5-50SLD	1239349	MAIN GEAR	62B	62B-525	1184037
8	8-30SLD	1257843	WASHER, CRESCENT (TENSION)	62C	62C-30SLD	1238914
13	13-60SLD	1257838	PINION GEAR	62D	62A-TRQ40	1230189
13B	13B-50SLD	1257834	SLEEVE, SPINDLE	62E	62C-321LH	1184041
16	16-975LD	1181587	SCREW (3 REQ.)	66	66-30SLD	1238915
18	18-60SLD	1239425	TENSION SPRING (4 REQ.)	69A	69A-30SLD	1238916
21	21-60SLDLH	1260194	LEVER, DRAG (LEFT HAND)	69B	69B-50	1184125
23	23-TRQ40	1229462	NUT, HANDLE	69D	69D-50SLD	1239369
23A	23-6CH	1181930	SCREW, F/MAIN GEAR	71A	71A-50SLD	1239370
24	24-TRQ40	1229501	HANDLE	71L	71L-60SLD	1239428
28	28-50SLD	1239357	LEFT SIDE RING	82	82-25	1184220
29L	29L-60SLDLH	1260196	ALUMINUM SPOOL (LEFT HAND)	98	98-30SLD	1238980
32	32-15	1182708	SCREW, HANDLE LOCK	110A	110A-30SLD	1238983
32A	32-30SLD	1238924	SCREW (2 REQ.)	112C	112C-30SLD	1238984
32B	32-310	1182722	SCREW (4 REQ.)	112E	112E-30SLD	1238985
32C	32-50SLD	1239359	SCREW (2 REQ.)	117	117-50SLD-1	1239375
33	33-114H2	1197532	ROD CLAMP	117A	117A-50SLD	1239402
33C	33C-114H2	1197534	ROD CLAMP KIT	117W	117W-50SLD	1239406
34	34-16VS	1182786	ROD CLAMP SCREW (2 REQ.)	120	120-50SLD	1239407
34C	34C-16VS	??	ROD CLAMP SCREWS W/ NUTS	134	134-50SLD	1239408
35	35-30SLD	1238939	CLICK TONGUE	141	141-60SLDLH	1260198
36	36-30SLD	1238940	CLICK BUTTON	144	144-50SLD	1239414
37	37-60SLD	1239426	SPACER BAR (2 REQ.)	149	149-45	1184702
37T	37T-60SLD	1239427	BAR, TOP SPACER	149A	149-200	1184706
39	39-30SLD	1238942	SCREW, THREAD CUTTING (2 REQ.)	156	156-60SLDLH	1260200
39A	39-50SLD	1239362	SCRWE (2 REQ.)	157	157-30SLD	1239002
41	41-30SLD	1238943	SPRING	161	161-30SLD	1239011
50	50-30SLD	1238944	SHIELD, GEAR STUD	161A	161-40	1184787
52A	52A-260	1183843	SCREW (6 REQ.)	162 see below		
53A	53A-5600	1183846	PIN, LUG LOCATING (2 REQ.)	183	183-60SLDLH	1260202
53B	53B-5600	1183848	SPRING, LUG (2) & DRAG CLICK (1)	252-253 SEE BELOW		
54	54-50SLD	1239363	LUG, HARNES (2 REQ.)	MYSTIC REEL PARTS REVISION!		
54B	54B-50SLD	1239364	BUSHING, LUG (2 REQ.)	NOTE:		
54S	54S-50SLD	1238946	SCREW, THREAD CUTTING (4 REQ.)	Many of www.mysticparts.com schematics incl made by Penn, or errors found and corrected b MRP VER. 01/31/21 (Based on Penn's Rev 2)		

These Three parts: ----->

Became this assembly

KEY	Penn Part	PureFishing	
<u>NO</u>	<u>Number</u>	<u>Part#</u>	<u>DESCRIPTION</u>
252	252-30SLD	1257817	WASHER, THRUST (3 REQ.)
252	252A-30SLD	1257818	WASHER, C'BORE THRUST (2 REQ.)
253	253-30SLD	1257829	ASSEMBLY, BALL AND CAGE (2 REQ.)

KEY	Penn Part	PureFishing
<u>NO</u>	<u>Number</u>	<u>Part#</u>
55T	55T-30SLD	1238913

RRORS

162	162-50	1184795	SPRING wrong info on Penn's Rev1
USE:	162-TRQ40NLD2	1318280	SPRING (2 REQ.)

(1238642)

DESCRIPTION

WASHER, LUG (2 REQ.)
BALL BEARING (17X9X5)
BALL BEARING (12X6X4)(3 REQ.)
SPRING
SPRING (2 REQ.)
PIN, CLICK (2 REQ.)
PLATE, CLICK RETAINING
CLICK, CLICK BUTTON LOCATOR
PLATE, CLICK RETAINING
RATCHET, CLICK
RING, RETAINING, ROUND
RING, RETAINING, "E" (3 REQ.)
RING, RETAINING, ROUND
PLATE, SPINDLE LOCKING
SPOOL SPINDLE
WASHER
RATCHET
PLATE, HANDLE NUT LOCKING
PIN, CLICK
HOUSING LEVER CLICK
DRIVE PLATE
DRAG WASHER ASSEMBLY
DRAG WASHER, METAL
O-RING
GEAR STUD
FOLLOWER, CAM (LEFT HAND)
KNOB, PRESET
ROD CLAMP NUT (2 REQ.)
ROD CLAMP HEX NUT (2 REQ.)
COVER, DRAG (LEFT HAND)
BUSHING, QUADRANT (2 REQ.)
BUTTON, FREE SPOOL
BUTTON, STRIKE

FRAME (LEFT HAND)

Some changes that were either
by our parts dept.
(3-25-2013)

1:

DESCRIPTION

BEARING ASSEMBLY (2 REQ.)

Mystic Reel Parts