

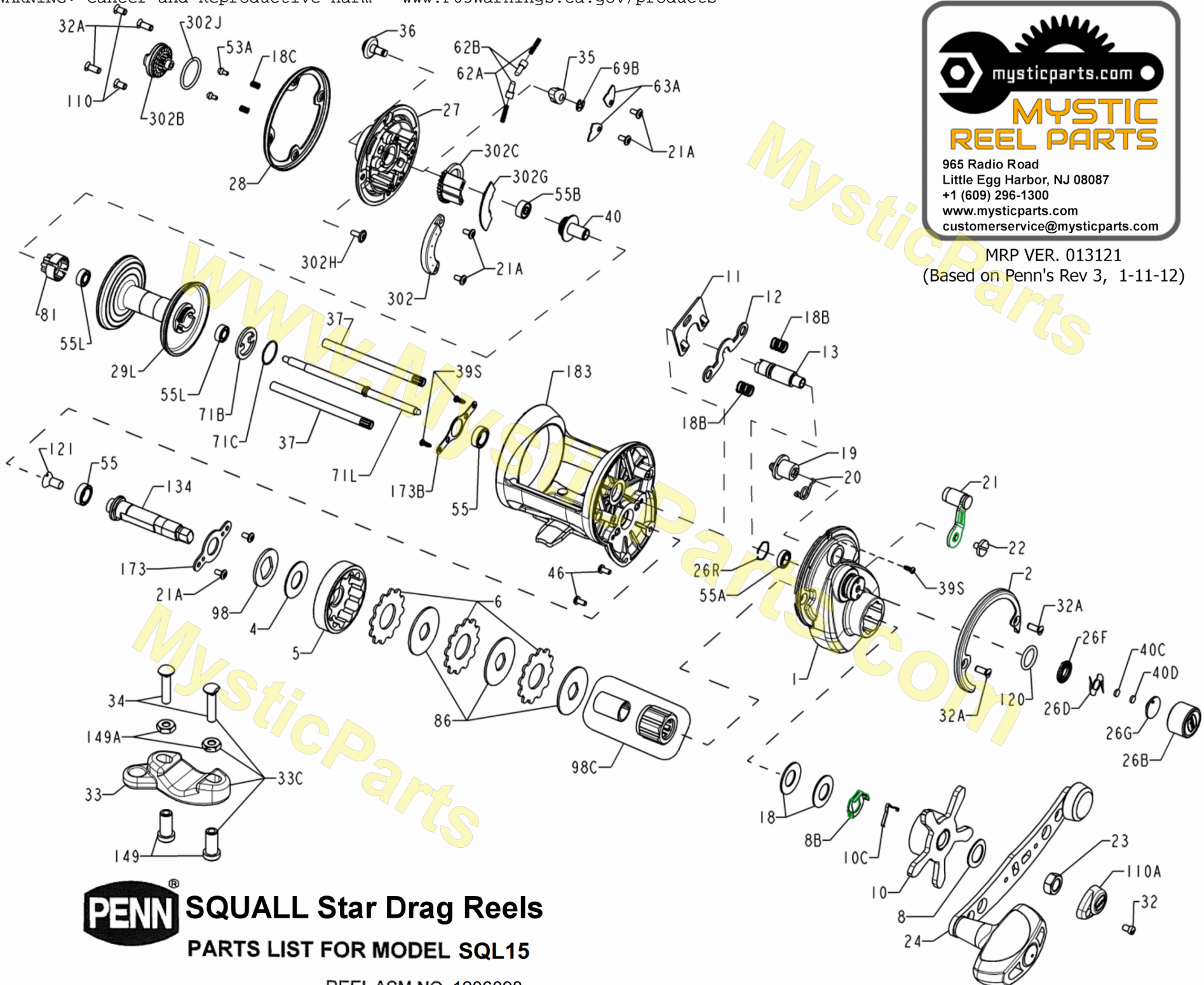

mysticparts.com
**MYSTIC
REEL PARTS**

965 Radio Road
Little Egg Harbor, NJ 08087
+1 (609) 296-1300
www.mysticparts.com
customerservice@mysticparts.com

MRP VER. 013121
(Based on Penn's Rev 3, 1-11-12)



PENN[®] SQUALL Star Drag Reels
PARTS LIST FOR MODEL SQL15

REEL ASM NO. 1206098

Penn Reel Parts list for SQL15 Squall (1206098)

| KEY | Penn Part | PureFishing | DESCRIPTION | KEY | Penn Part | PureFishing | DESCRIPTION |
|-----|-------------|-------------|--------------------------------|------|--------------|-------------|-----------------------------|
| NO | Number | Part# | | NO | Number | Part# | |
| 1 | 1-525MAG2 | 1214640 | HANDLE SIDE PLATE | 37 | 37-525MAG2 | 1214662 | FRAME POST (2 REQ.) |
| 2 | 2-525MAG2 | 1214523 | RING, RIGHT SIDE PLATE | 39S | 39-525 | 1183220 | RIGHT SIDE PLATE SCREW |
| 4 | 4-60 | 1180755 | FIBER WASHER | 40 | 40-525MAG2 | 1214664 | BUSHING, LEFT SIDE SPINDLE |
| 5 | 5-525MAG2 | 1214524 | MAIN GEAR | 40C | 40C-525MAG2 | 1208115 | METAL THRUST WASHER |
| 6 | 6-TRQ40 | 1237037 | FRICITION DRAG WASHER (3 REQ.) | 40D | 40D-525MAG2 | 1125771 | RUBBER THRUST WASHER |
| 8 | 8-60 | 1181056 | TENSION SPRING WASHER | 46 | 46A-4300 | 1183585 | SIDE PLATE SCREW (2 REQ.) |
| 8 | 8-525MAG2 | 1214525 | TENSION SPRING WASHER | 53A | 53A-5600 | 1183846 | PIN, CLICK (2 REQ.) |
| 10 | 10-525MAG2 | 1214526 | STAR DRAG | 55 | 55-525MAG2 | 1214665 | BALL BEARING (2 REQ.) |
| 10C | 10C-525MAG2 | 1214527 | DETENT SPRING | 55A | 55A-525MAG2 | 1214666 | BALL BEARING |
| 11 | 11-525MAG2 | 1214528 | ECCENTRIC JACK | 55B | 55-113H | 1183880 | BALL BEARING |
| 12 | 12-525MAG2 | 1214649 | PINION YOKE | 55L | 55L-965 | 1192031 | BALL BEARING (2 REQ.) |
| 13 | 13-525MAG2 | 1214650 | PINION GEAR | 62A | 62A-525MAG2 | 1214667 | CLICK SPRING (2 REQ.) |
| 18 | 18-525MAG2 | 1214651 | TENSION SPRING(2 REQ.) | 62B | 62B-525MAG | 1184038 | CLICK PIN (2 REQ.) |
| 18B | 18-525 | 1181624 | CLUTCH SPRING (2 REQ.) | 63A | 63A-525MG2 | 1214668 | CLICK SPRING COVER (2 REQ.) |
| 18C | 18C-15KG | 1181632 | SPRING (2 REQ.) | 69B | 69B-600 | 1184129 | RETAINING RING |
| 19 | 19-525MAG2 | 1216239 | ECCENTRIC | 71B | 71B-525MAG2 | 1214669 | CLUTCH PLATE |
| 20 | 20-525 | 1181785 | ECCENTRIC | 71C | 71C-525MAG2 | 1214670 | CLUTCH PLATE RETAINER |
| 21 | 21-525MAG2 | 1214704 | ECCENTRIC LEVER | 71L | 71L-525MAG2 | 1214671 | SPOOL SPINDLE |
| 21A | 21A-420G | 1214652 | SCREW (6 REQ.) | 81 | 81-525MAG | 1184210 | CLICK RATCHET |
| 22 | 22-525MAG2 | 1214705 | ECCENTRIC SCREW | 86 | 86-49L | 1184251 | WASHER, KEYED DRAG (3 REQ.) |
| 23 | 23-555 | 1181950 | HANDLE NUT | 98 | 98-525MAG2 | 1214673 | SPACER |
| 24 | 24A-525MAG2 | 1214653 | HANDLE | 98C | 98C-525MAG2 | 1216190 | CLUTCH / SLEEVE ASSEMBLY |
| 26B | 26B-525MAG2 | 1214706 | SPOOL TENSION CAP | 110 | 110-50 | 1184436 | SIDE PLATE SHORT SCREW |
| 26D | 26D-525MAG2 | 1125769 | CLICK SPRING | 110A | 110A-525MAG2 | 1214675 | HANDLE NUT LOCK CAP |
| 26F | 26F-525MAG2 | 1125768 | CLICK PLATE "INNER" | 120 | 120-113H | 1184522 | O-RING |
| 26G | 26G-525MAG2 | 1125772 | CLICK PLATE "OUTER" | 121 | 121-525 | 1184529 | BEARING SCREW |
| 26R | 26R-525MAG2 | 1214654 | RETAINING RING | 134 | 134-525MAG2 | 1214676 | GEAR STUD |
| 27 | 27-SQL15 | 1214627 | LEFT SIDE PLATE | 149 | 149-45 | 1184702 | ROD CLAMP NUT (2 REQ.) |
| 28 | 28-525MAG2 | 1214657 | LEFT SIDE RING | 149A | 149-200 | 1184706 | ROD CLAMP HEX NUT (2 REQ.) |
| 29L | 29L-525MAG2 | 1214658 | ALUMINUM SPOOL | 173 | 173-525MAG2 | 1214677 | BEARING RETAINER |
| 32 | 32-15 | 1182708 | HANDLE LOCK SCREW | 173B | 173B-525MAG2 | 1214678 | BEARING RETAINER |
| 32A | 32-310 | 1182722 | SCREW (4 REQ.) | 183 | 183-SQL15 | 1214629 | FRAME |
| 33 | 33N-113 | 1182754 | ROD CLAMP | 302 | 302-525MAG2 | 1214681 | ASSEMBLY, MAGNET HOUSING |
| 33C | 33C-525MAG2 | 1214659 | ROD CLAMP KIT | 302B | 302B-525MAG2 | 1214682 | DIAL, BRAKE ADJUSTMENT |
| 34 | 34-45 | 1182788 | ROD CLAMP SCREW (2 REQ.) | 302C | 302C-525MAG2 | 1214683 | CARRIER, MAGNET SHIELD |
| 34C | 34C-45 | 1182862 | ROD CLAMP SCREWS W/ NUTS | 302G | 302G-525MAG2 | 1214684 | SHIELD, ADJUSTABLE MAGNET |
| 35 | 35-525MAG2 | 1214660 | CLICK TONGUE | 302H | 302H-525MAG2 | 1214685 | SCREW |
| 36 | 36-525MAG2 | 1214661 | CLICK BUTTON | 302J | 302J-525MAG2 | 1214686 | O-RING |

NOTES:

On Rev. 0 of these schematics, there was key #39, part #39-525mag2
As of Rev. 2, this part is renumbered key #32A and part #32-310

MYSTIC REEL PARTS REVISION!

NOTE:

Many of www.mysticparts.com schematics include changes that were either made by Penn, or errors found and corrected by our parts dept.
MRP VER. 013121(Based on Penn's Rev3, 1-11-12)

Order parts here: <https://www.mysticparts.com/PennParts/PennSQL15.aspx>