

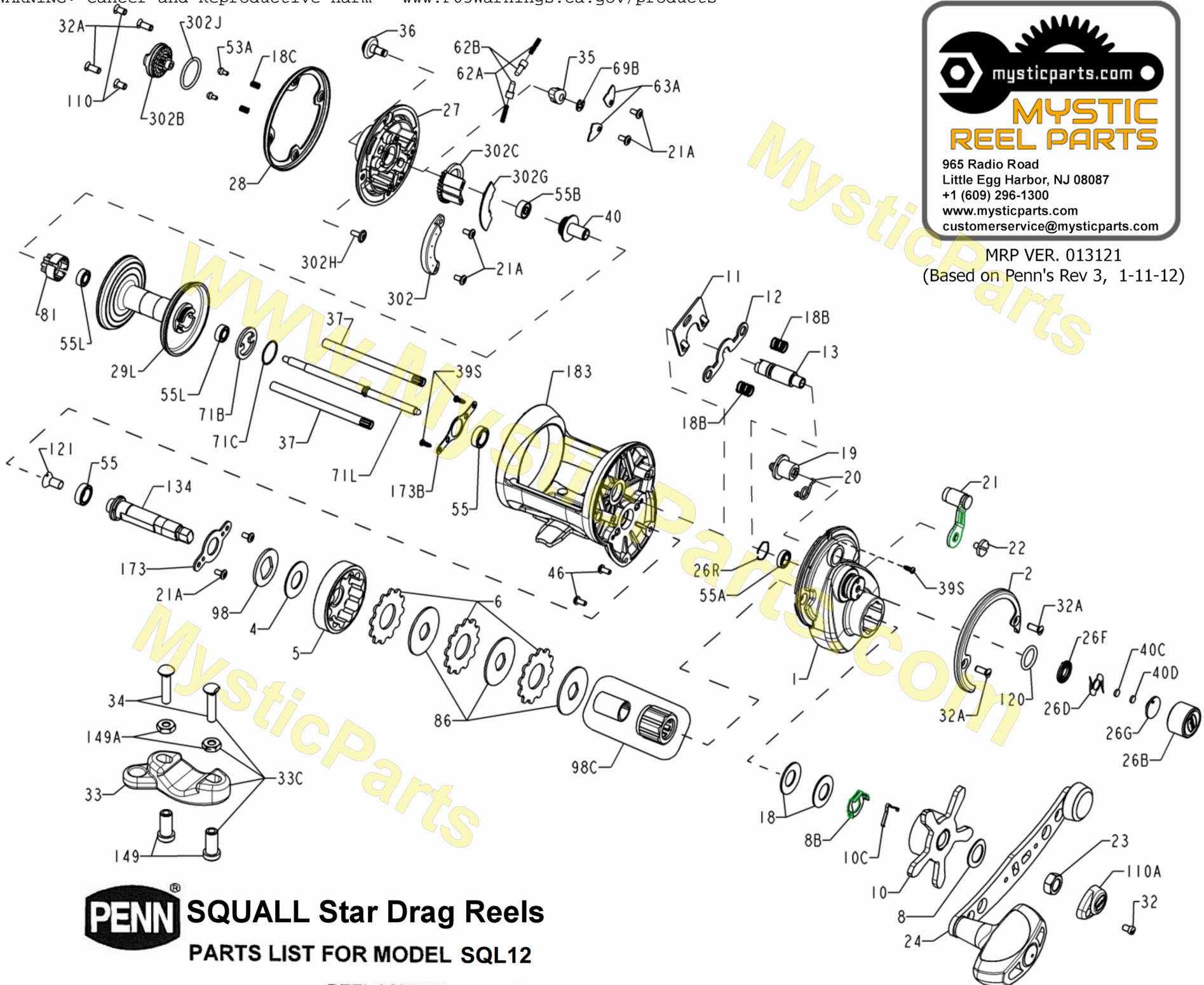

mysticparts.com
MYSTIC REEL PARTS
 965 Radio Road
 Little Egg Harbor, NJ 08087
 +1 (609) 296-1300
 www.mysticparts.com
 customerservice@mysticparts.com

MRP VER. 013121
(Based on Penn's Rev 3, 1-11-12)



PENN SQUALL Star Drag Reels
 PARTS LIST FOR MODEL SQL12

REEL ASM NO. 1206097

Penn Reel Parts list for SQL12 Squall (1206097)

KEY	Penn Part	PureFishing	DESCRIPTION	KEY	Penn Part	PureFishing	DESCRIPTION
NO	Number	Part#		NO	Number	Part#	
1	1-525MAG2	1214640	HANDLE SIDE PLATE	37	37-515MAG2	1214663	FRAME POST (2 REQ.)
2	2-525MAG2	1214523	RING, RIGHT SIDE PLATE	39S	39-525	1183220	RIGHT SIDE PLATE SCREW
4	4-60	1180755	FIBER WASHER	40	40-525MAG2	1214664	BUSHING, LEFT SIDE SPINDLE
5	5-525MAG2	1214524	MAIN GEAR	40C	40C-525MAG2	1208115	METAL THRUST WASHER
6	6-TRQ40	1237037	FRICTION DRAG WASHER (3 REQ.)	40D	40D-525MAG2	1125771	RUBBER THRUST WASHER
8	8-60	1181056	TENSION SPRING WASHER	46	46A-4300	1183585	SIDE PLATE SCREW (2 REQ.)
8	8-525MAG2	1214525	TENSION SPRING WASHER	53A	53A-5600	1183846	PIN, CLICK (2 REQ.)
10	10-525MAG2	1214526	STAR DRAG	55	55-525MAG2	1214665	BALL BEARING (2 REQ.)
10C	10C-525MAG2	1214527	DETENT SPRING	55A	55A-525MAG2	1214666	BALL BEARING
11	11-525MAG2	1214528	ECCENTRIC JACK	55B	55-113H	1183880	BALL BEARING
12	12-525MAG2	1214649	PINION YOKE	55L	55L-965	1192031	BALL BEARING (2 REQ.)
13	13-525MAG2	1214650	PINION GEAR	62A	62A-525MAG2	1214667	CLICK SPRING (2 REQ.)
18	18-525MAG2	1214651	TENSION SPRING(2 REQ.)	62B	62B-525MAG	1184038	CLICK PIN (2 REQ.)
18B	18-525	1181624	CLUTCH SPRING (2 REQ.)	63A	63A-525MG2	1214668	CLICK SPRING COVER (2 REQ.)
18C	18C-15KG	1181632	SPRING (2 REQ.)	69B	69B-600	1184129	RETAINING RING
19	19-525MAG2	1216239	ECCENTRIC	71B	71B-525MAG2	1214669	CLUTCH PLATE
20	20-525	1181785	ECCENTRIC	71C	71C-525MAG2	1214670	CLUTCH PLATE RETAINER
21	21-525MAG2	1214704	ECCENTRIC LEVER	71L	71L-515MAG2	1214672	SPOOL SPINDLE
21A	21A-420G	1214652	SCREW (6 REQ.)	81	81-525MAG	1184210	CLICK RATCHET
22	22-525MAG2	1214705	ECCENTRIC SCREW	86	86-49L	1184251	WASHER, KEYED DRAG (3 REQ.)
23	23-555	1181950	HANDLE NUT	98	98-525MAG2	1214673	SPACER
24	24A-525MAG2	1214653	HANDLE	98C	98C-525MAG2	1216190	CLUTCH / SLEEVE ASSEMBLY
26B	26B-525MAG2	1214706	SPOOL TENSION CAP	110	110-50	1184436	SIDE PLATE SHORT SCREW
26D	26D-525MAG2	1125769	CLICK SPRING	110A	110A-525MAG2	1214675	HANDLE NUT LOCK CAP
26F	26F-525MAG2	1125768	CLICK PLATE "INNER"	120	120-113H	1184522	O-RING
26G	26G-525MAG2	1125772	CLICK PLATE "OUTER"	121	121-525	1184529	BEARING SCREW
26R	26R-525MAG2	1214654	RETAINING RING	134	134-525MAG2	1214676	GEAR STUD
27	27-SQL12	1214626	LEFT SIDE PLATE	149	149-45	1184702	ROD CLAMP NUT (2 REQ.)
28	28-525MAG2	1214657	LEFT SIDE RING	149A	149-200	1184706	ROD CLAMP HEX NUT (2 REQ.)
29L	29L-515MAG2	1214634	ALUMINUM SPOOL	173	173-525MAG2	1214677	BEARING RETAINER
32	32-15	1182708	HANDLE LOCK SCREW	173B	173B-525MAG2	1214678	BEARING RETAINER
32A	32-310	1182722	SCREW (4 REQ.)	183	183-SQL12	1214628	FRAME
33	33N-113	1182754	ROD CLAMP	302	302-525MAG2	1214681	ASSEMBLY, MAGNET HOUSING
33C	33C-525MAG2	1214659	ROD CLAMP KIT	302B	302B-525MAG2	1214682	DIAL, BRAKE ADJUSTMENT
34	34-45	1182788	ROD CLAMP SCREW (2 REQ.)	302C	302C-525MAG2	1214683	CARRIER, MAGNET SHIELD
34C	34C-45	1182862	ROD CLAMP SCREWS W/ NUTS	302G	302G-525MAG2	1214684	SHIELD, ADJUSTABLE MAGNET
35	35-525MAG2	1214660	CLICK TONGUE	302H	302H-525MAG2	1214685	SCREW
36	36-525MAG2	1214661	CLICK BUTTON	302J	302J-525MAG2	1214686	O-RING

NOTES:

On Rev. 0 of these schematics, there was key #39, part #39-525mag2
As of Rev. 2, this part is renumbered key #32A and part #32-310

MYSTIC REEL PARTS REVISION!

NOTE:

Many of www.mysticparts.com schematics include changes that were either made by Penn, or errors found and corrected by our parts dept.

MRP VER. 013121(Based on Penn's Rev3, 1-11-12)

Order parts here: <https://www.mysticparts.com/PennParts/PennSQL12.aspx>