



PARTS LIST FOR MODEL SLAMMER IV 3500  
**SLAiV3500 (1545761)**



mysticparts.com

**MYSTIC  
REEL PARTS**

965 Radio Road  
Little Egg Harbor, NJ 08087  
+1 (609) 296-1300  
www.mysticparts.com  
customerservice@mysticparts.com

**MRP Ver. 053122**

(based on Penn's Rev. 00 4-20-21)

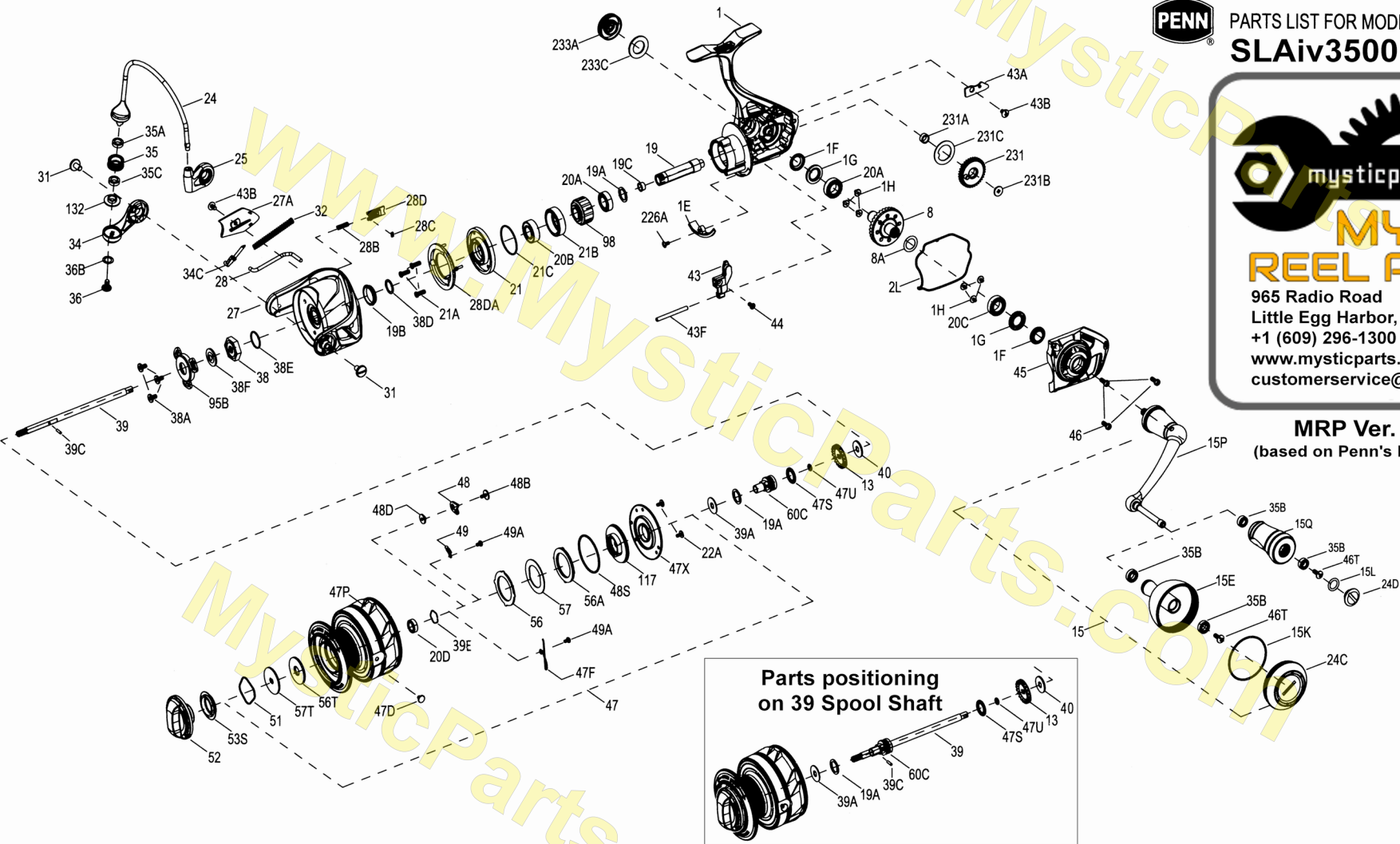

**Parts positioning  
on 39 Spool Shaft**

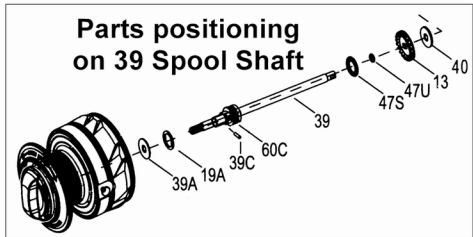

## Penn Reel Parts list for Model: SLAiv3500 (1545761) SLAMMER iv SPINNING

## \*\* AUTOMATIC BAIL TRIP \*\*

KEY	PUREFISHING PART			DESCRIPTION
NO	NO	NO.		
1	1559193	1-SLAiv3500		BODY/HOUSING
1E	1418954	1E-SLA3500		BODY SLOPE
1F	1418955	1F-SLA3500		BODY BALL BEARING SEAL (2 REQUIRED)
1G	1418956	1G-SLA3500		BODY SIDE SEAL LOCK PLATE (2 REQUIRED)
1H	1418957	1H-SLA3500		BODY SIDE SCREW (6 REQUIRED)
2L	1559194	2L-SLAiv3500		BODY SEAL
8	1418972	8-SLA3500		DRIVE GEAR (MAIN GEAR) (CNC)
8A	1257352	8A-CLA2000		DRIVE GEAR SHIM WASHER
13	1418974	13-SLA3500		CLICK GEAR
19	1559198	19-SLAiv3500		PINION GEAR (CNC) (BRASS)
19A	1277424	19A-SLA3500		WASHER, AT PINION AND SPOOL SUPPORT SLEEVE (2 REQUIRED)
19B	1559218	19B-SLAiv3500		SEAL
19C	1418978	19C-SLA3500		PINION GEAR BUSHING
20C	1385532	20C-CLA3000		SEALED BALL BEARING (3 REQUIRED)
20B	1385531	20B-CLA3000		SEALED BALL BEARING
20D	1385604	20D-CLA2000		SEALED BALL BEARING
21	1418979	21-SLA3500		BALL BEARING RETAINER
21A	1418980	21A-SLA3500		RETAINER SCREW (3 REQUIRED)
21B	1385535	21B-CLA3000		PINION BALL BEARING COLLAR
21C	1418981	21C-SLA3500		BODY HEAD SEAL
22A	1418982	22A-SLA3500		DRAG COVER SCREW (2 REQUIRED)
24	1559199	24-SLAiv3500		BAIL WIRE
25	1385539	25-CLA3000		BAIL HOLDER
27	1559201	27-SLAiv3500		ROTOR
27A	1559202	27A-SLAiv3500		ROTOR COVER
28	1559203	28-SLAiv3500		ROTOR TRIP LEVER
28B	1346982	28B-CLA2000		SPRING
28C	1385547	28C-CLA3000		ROTOR BRAKE SEAL
28D	1385545	28D-CLA3000		ROTOR BRAKE (RECTANGULAR)
28DA	1418967	28D-SLA3500		ROTOR BRAKE (ROUND)
31	1276936	31-SSV3500		BAIL ARM SCREW (2 REQUIRED)
32	1385549	32-CLA3000		BAIL SPRING
34	1385550	34-CLA3000		BAIL ARM
34C	1385551	34C-CLA3000		PIVOT ARM
35	1559204	35-SLAiv3500		LINE ROLLER
35A	1474155	35A-SLAiii3500		LINE ROLLER BUSHING
35C	1525199	35C-CLAi3000		LINE ROLLER BALL BEARING
36	1277061	36-SSV5500		LINE ROLLER SCREW
36B	1417809	36B-CLA6000		BAIL ARM SCREW WASHER
38	1418993	38-SLA3500		ROTOR NUT
<b>38A</b>	<b>SEE PROBLEMS FOUND PAGE 3</b>			
38D	1559205	38D-SLAiv3500		WASHER, ABOVE RETAINER
38E	1418958	38E-SLA3500		PINION GEAR SEAL
38F	1418959	38F-SLA3500		ROTOR-MAIN SHAFT SEAL

KEY	PUREFISHING PART			DESCRIPTION
NO	NO	NO.		
39	1559206	39-SLAiv3500		MAIN SHAFT
39A	1559275	39A-SLAiv5500		WASHER, FOR SPOOL SHAFT SLEEVE
39C	1559217	39C-SLAiv3500		PIN
39E	1559220	39E-SLAiv3500		RETAINER
40	1422917	40-SLA3500		WASHER, FOR CLICK GEAR
43	1418996	43-SLA3500		OSCILLATION SLIDER (CROSSWIND BLOCK)
43A	1418997	43A-SLA3500		SLIDER RETAINER PLATE
43B	1559161	43B-SLAiv2500		SCREW, AT ROTOR COVER AND CROSSWIND PLATE (2 REQUIRED)
43F	1385563	43F-CLA3000		GUIDE SHAFT
44	1525911	44-CLAi3000		SCREW
45	1559207	45-SLAiv3500		BODY COVER ASSEMBLY
46	1385567	46-CLA3000		BODY COVER SCREW (3 REQUIRED)
47	1559209	47-SLAiv3500		SPOOL ASSEMBLY
47D	1276953	47D-SSV3500		LINE HOOK
47F	1559209	47F-SLAiv3500		LINE CLIP RETAINER
47P	1559210	47P-SLAiv3500		SPOOL (BARE)
47S	1494699	47S-SSVi2500LL		SPOOL SEAL
47U	1494700	47U-SSVi2500LL		DRAG COVER SEAL
47X	1559221	47X-SLAiv3500		DRAG COVER
48	1419069	48-SLA5500		SPOOL CLICK PLATE
48B	1559212	48B-SLAiv3500		SPOOL CLICKER SPRING SCREW
48D	1385579	48D-CLA3000		SPOOL CLICKER SPACER RING
48S	1559211	48S-SLAiv3500		SEAL
49	1259579	49-7000AF		SPRING
49A	1559283	49A-SLAiv5500		SCREW (2 REQUIRED)
51	1277085	51-SSV5500		DRAG WASTER RETAINER
52	1559213	52-SLAiv3500		DRAG KNOB ASSEMBLY
53S	1385583	53S-CLA3000		DRAG KNOB SEAL
56	1418961	56-SLA3500		DRAG FRICTION WASHER
56A	1418962	56A-SLA3500		DRAG FRICTION WASHER
56T	1277089	56T-SSV5500		DRAG FRICTION WASHER
57	1419008	57-SLA3500		KEYED DRAG WASHER
57T	1276985	57T-SSV4500		KEYED DRAG WASHER
60C	1559214	60C-SLAiv3500		SPOOL SUPPORT SLEEVE
95B	1419009	95B-SLA3500		ROTOR NUT LOCKING PLATE
98	1276966	98-SSV3500		CLUTCH/SLEEVE ASSEMBLY
117	1559215	117-SLAiv3500		DRAG DRIVE PLATE
132	1474156	132-SLAiii3500		LINE ROLLER COLLAR
226A	1525914	226A-CLAi3000		SCREW
231	1419013	231-SLA3500		OSCILLATION GEAR (CROSSWIND GEAR)
231A	1385595	231A-CLA2000		OSCILLATION GEAR BUSHING
231B	1307857	231B-SSV3500		OSCILLATION GEAR SCREW
231C	1525915	231C-CLAi3000		OSCILLATION GEAR WASHER
233A	1559216	233A-SLAiv3500		HANDLE CAP
233C	1419016	233C-SLA3500		HANDLE CAP WASHER

See Page 3 for all handle components

**NOTE: MYSTIC REEL PARTS REVISION!**

Many of www.mysticparts.com schematics include changes that were either made by Penn, or errors found and corrected by our parts dept.

MRP Ver. 053122 (based on Penn's Rev. 00 4-20-21)

## HANDLE ASSEMBLY AND COMPONENT INFO FOR THE TWO TYPES OF HANDLES

### METAL KNOB HANDLE COMPONENTS

KEY	PUREFISHING PART			
NO	NO	NO	DESCRIPTION	
15	1559195	15-SLAiv3500	HANDLE ASSEMBLY (METAL KNOB)	
15E	1559196	15E-SLAiv3500	HANDLE KNOB (METAL)	
15K	1418968	15K-SLA3500	HANDLE KNOB CAP SEAL	
15P	1422394	15P-SLA3500	SUB-HANDLE ASSEMBLY	
24C	1559200	24C-SLAiv3500	HANDLE KNOB CAP (FOR METAL KNOB)	
35B	1418393	35B-CLA3000	BALL BEARING (2 REQUIRED)	
46T	1341500	3-SSV7500LC	SCREW	

### FOAM KNOB HANDLE COMPONENTS

KEY	PUREFISHING PART			
NO	NO	NO	DESCRIPTION	
15	N/A	N/A	FOAM HANDLE NOT AVAILABLE PRE-ASSEMBLED	
15Q	1559197	15E-SLAiv3500	HANDLE KNOB (FOAM)	
<b>15L</b>	<b>N/A</b>	<b>15L-CLA5000</b>	<b>HANDLE KNOB SEAL *** SEE NOTES BELOW! ***</b>	
15P	1422394	15P-SLA3500	SUB-HANDLE ASSEMBLY	
24D	1417806	24C-CLA3000	HANDLE KNOB CAP (FOR FOAM KNOB)	
35B	1418393	35B-CLA3000	BALL BEARING (2 REQUIRED)	
46T	1341500	3-SSV7500LC	SCREW	

#### 15L NOTES:

Penn's rev00 schematics list the 15L as 15L-CLA2000 on SLAiv2500, SLAiv2500HS, SLAiv3500, SLAiv4500 & SLAiv4500HS (INCORRECT PART#)

15L-CLA2000 are much smaller and thinner than the seal that was found on the 24C-CLA3000 caps during disassembly.

We could not identify an existing Penn number to match it to, so we have assigned the number as **15L-CLA5000** Seal (Thicker/Larger)

### PROBLEMS FOUND AND CORRECTED

38A	<del>1119121</del>	<del>20G-7000AF</del>	SCREW (3 REQUIRED) ** INCORRECT PART NUMBER DO NOT USE
	1277063	38A-SSV5500	SCREW (3 REQUIRED) ** USE THIS PART