

SBT Ver. 032914
(Based on Penn's REv 14)

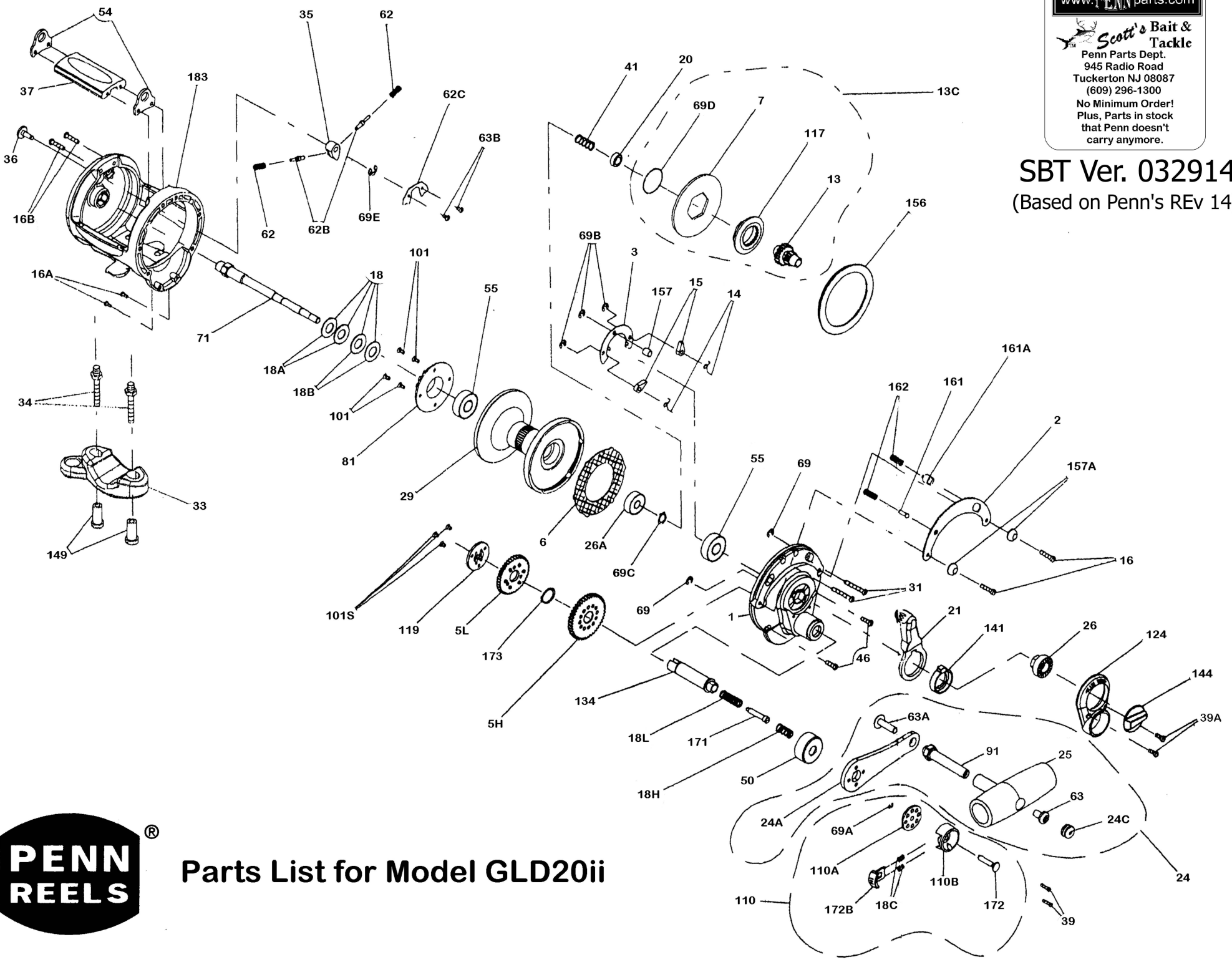

Parts List for Model GLD20ii

Penn Reel Parts list for Model: GLD20ii

KEY	PART		KEY	PART	
NO	NO.	DESCRIPTION	NO	NO.	DESCRIPTION
1	1M-15KG	RIGHT SIDE PLATE ASSEMBLY	55	55-50	BALL BEARING (2 REQ.)
2	2M-15KG	QUADRANT RING	62	62-545	CLICK SPRING
3	3-15KG	DOG BRIDGE	62B	62B-525	CLICK PIN (2 REQ.)
5H	5-15KGHS	MAIN GEAR (HIGH SPEED)	62C	62C-15KG	CLICK SPRING COVER
5L	5-15KGLS	MAIN GEAR (LOW SPEED)	63	63-50	SCREW
6	6-15KG	DRAG WASHER	63A	63A-50	HANDLE STUD SCREW
7	7-15KG	METAL DRAG WASHER	63B	63-500S	SPRING COVER SCREW (2 REQ.)
13	13-15KG	PINION GEAR	63C	63-50	SCREW
13C	13C-15KG	PINION ASSEMBLY	69	69B-50	RETAINING RING (2 REQ.)
14	14-15KG	DOG SPRING (2 REQ.)	69A	69B-30S	RETAINING RING
15	15-15KG	DOG (2 REQ.)	69B	69B-600	RETAINING RING (3 REQ.)
16	16T-60CH	SIDE PLATE SCREW (2 REQ.)	69C	69C-15KG	SPINDLE RETANING RING
18A	18-50W	LIGHT DISC CLUTCH SPRING (2 REQ.)	69D	69D-15KG	RETAINING RING
18B	18-50TW	HEAVY DISC CLUTCH SPRING (2 REQ.)	69E	69B-600	RETAINING RING
18C	18C-15KG	SHIFT BUTTON SPRING (2 REQ.)	71	71-10KG	SPOOL SPINDLE
18H	18H-15KG	SHIFT SPRING (HEAVY)	81	81-40	CLICK RATCHET
18L	18L-15KG	SHIFT SPRING (LIGHT)	91	91N-50	HANDLE RIVET
20	20-4200	SPINDLE BALL BEARING	101	101-30	RATCHET SCREW (4 REQ.)
21	21-15KG	ECCENTRIC LEVER	101S	101-50S	RETAINING PLATE SCREW (4 REQ.)
24	24M-15KG	HANDLE COMPLETE	110	110-15KG	SHIFTER ASSEMBLY
24A	24M-15KG-1	HANDLE BLANK	110A	110A-15KG	HANDLE LOCKING PLATE
24C	24C-50	HANDLE KNOB CAP	110B	110B-15KG	SHIFT HOUSING
25	25M-50	HANDLE KNOB	117	117-15KG	DRIVE PLATE
26	26-15KG	BUSHING	119	119-15KG	RETAINING PLATE
26A	26-40	SPOOL BALL BEARING	124	124-15KG	BRIDGE COVER
29	29L-10LD	SPOOL	134	134-15KG	GEAR STUD
31	31T-15KG	LONG SCREW (2 REQ.)	141	141-15KG	CAM FOLLOWER
33	33-113	ROD CLAMP	144	144M-15KG	PRESET KNOB
34	34-10KG	ROD CLAMP SCREW (2 REQ.)	149	149-45	ROD CLAMP NUT (2 REQ.)
35	35-310N	CLICK TONGUE	156	156-15KG	DRAG COVER
36	36-15KG	CLICK BUTTON	157	157-50	SPACER BUSHING
37	37EGLD-202	TOP SPACER BAR	157A	157-15KG	SPACER BUSHING
39	23-15KG	SHIFT HOUSING SCREW (2 REQ.)	161	161-25	FREE SPOOL BUTTON
39A	39T-15KG	BRIDGE SCREW (2 REQ.)	161A	161-40	STRIKE BUTTON
41	41-15KG	SPINDLE SPRING	162	162-50	BUTTON SPRING (2 REQ.)
46	46T-750	SHORT SCREW (2 REQ.)	171	171-15KG	SHIFT PLUNGER
46A	32-2	FRAME SCREW (2 REQ.)	172	172-15KG	SHIFT BUTTON (LOW)
46B	46T-9500	LONG FRAME SCREW (2 REQ.)	172B	172B-15KG	SHIFT BUTTON (HIGH)
50	50M-15KG	GEAR STUD SHIELD	173	173-15KG	RETAINING RING
54	54M-15KG	HARNES LUG (2 REQ.)	183	183M-10KG	FRAME

NOTE: Many of www.pennparts.com schematics include changes that were either made by Penn, or errors found and corrected by our parts dept.

SBT Ver 032914 (Based on Penn's Rev. 14)

TYPO Some of Penn's schematics have the 63 and 63A key numbers mis-matched on the drawing

63	63-50	HANDLE KNOB SCREW, SHORT	This schematic drawing has the numbers correctly as shown here.
63A	63A-50	HANDLE STUD SCREW, LONG	