

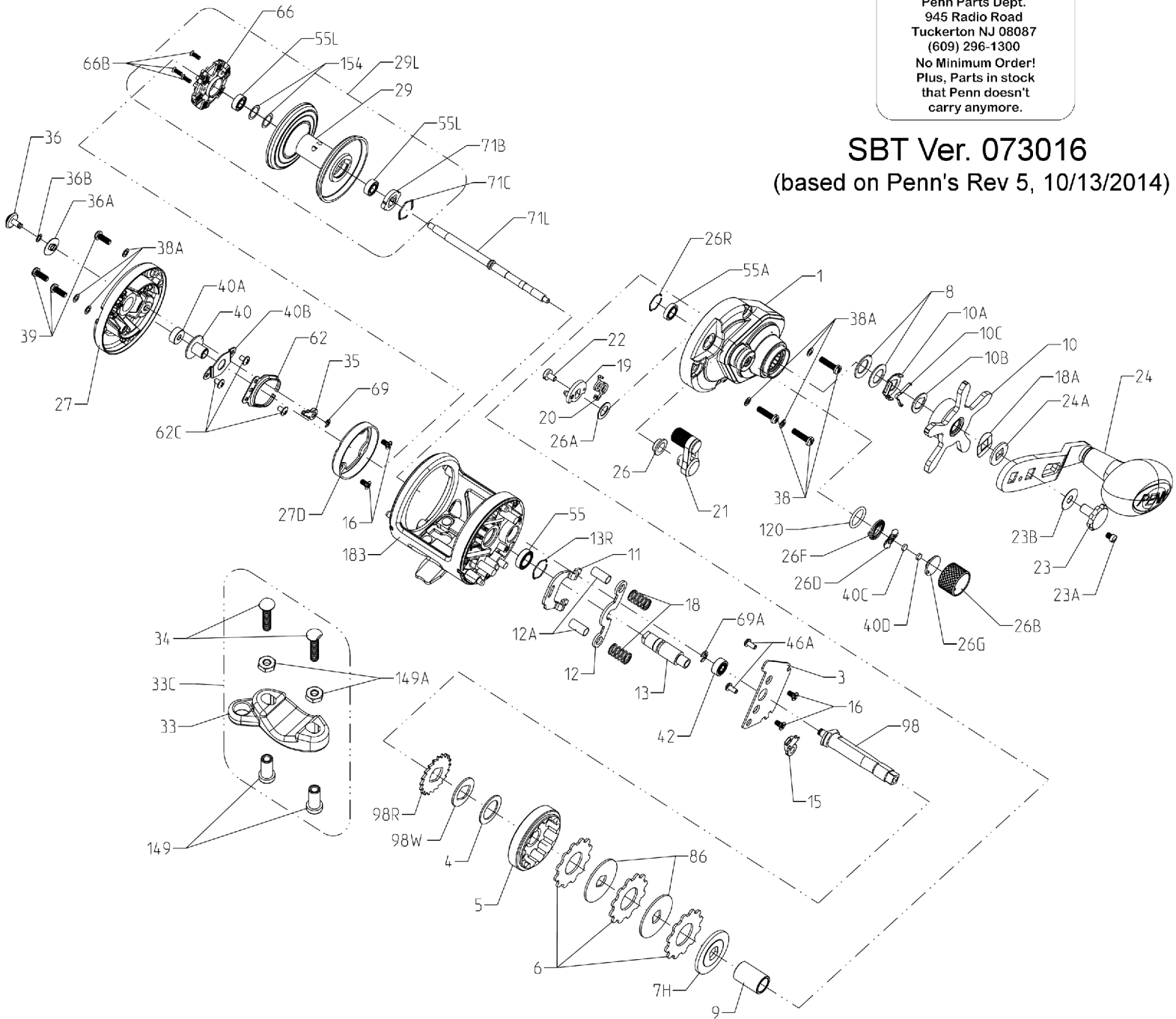

PARTS LIST FOR MODEL FATHOM SD 15
REEL ASM NO. 1238443

www.PENNparts.com
Scott's Bait & Tackle
Penn Parts Dept.
945 Radio Road
Tuckerton NJ 08087
(609) 296-1300
No Minimum Order!
Plus, Parts in stock
that Penn doesn't
carry anymore.

SBT Ver. 073016
(based on Penn's Rev 5, 10/13/2014)



Penn Reel Parts list for Model: FTHSD15 FATHOM 15 Star Drag

KEY	PUREFISHING	PENN PART		KEY	PUREFISHING	PENN PART	
NO	PART #	NO.	DESCRIPTION	NO	PART #	NO.	DESCRIPTION
1	1242807	1-FTHSD15	RIGHT SIDE PLATE ASSEMBLY	26R	1214654	26R-525MAG2	RETAINING RING
3	1242786	3-FTHSD12	BRIDGE	27	1242808	27-FTHSD15	LEFT SIDE PLATE
5	1242789	5-FTHSD12	MAIN GEAR	27D	1242794	27D-FTHSD12	CENTRIFUGAL BRAKE PATH
6	1237037	6-TRQ40	DRAG WASHER, TABBED HT 100 (3 REQUIRED)	29	1242809	29-FTHSD15	SPOOL SUB-ASSEMBLY
7H	1242788	7H-FTHSD12	HEAVY METAL DRAG WASHER	29L	1242836	29L-FTHSD15	SPOOL COMPLETE ASSEMBLY
8	1188709	8-FTH20LW	SPRING WASHER (2 REQUIRED)	33	1182754	33N-113	ROD CLAMP
9	1188708	9-FTH20LW	SPACING SLEEVE	33C	1229936	33C-TRQ40	ROD CLAMP KIT
10	1188713	10-FTH20LW	STAR DRAG	34	1182788	34-45	ROD CLAMP SCREW
10A	1188711	10A-FTH20LW	STAR CLICK RETAINER	34C	1182862	34C-45	ROD CLAMP SCREW W/NUTS
10B	1188710	10B-FTH20LW	STAR CLICK WASHER	35	1188656	35-FTH20LW	CLICK TONGUE
10C	1188712	10C-525MAG2	STAR CLICK SPRING	36	1242796	36-FTHSD12	CLICK BUTTON
11	1242791	11-FTHSD12	ECCENTRIC JACK	36A	1208113	36A-FTH20LW	CLICK WASHER
13	1242790	13-FTHSD12	PINION GEAR	36B	1188651	36B-FTH20LW	CLICK PVC WASHER
13R	1229364	13R-TRQ40	RETAINING RING	38	1188698	38-FTH20LW	SCREW M3X12 (3 REQUIRED)
15	1188675	15-FTH20LW	DOG	38A	1188649	38A-FTH20LW	FLAT WASHER (6 REQUIRED)
16	1188676	16-FTH20LW	BRIDGE SCREW (4 REQUIRED)	39	1188638	39-FTH20LW	SCREW M3X8 (3 REQUIRED)
18	1188677	18-FTH20LW	PINION YOKE SPRING (2 REQUIRED)	40	1230004	40-TRQ40	BALL BEARING
18A	1188714	18A-FTH20LW	KEYED SPRING WASHER	40A	1242804	40A-FTHSD12	BEARING
19	1188691	19-FTH20LW	ECCENTRIC	40B	1242805	40B-FTHSD12	PROTECTOR BEARING
20	1242806	20-FTHSD12	ECCENTRIC SPRING	40C	1208115	40C-525MAG2	WASHER, METAL THRUST
21	1242830	21-FTHSD12	ECCENTRIC LEVER	40D	1125771	40D-525MAG2	WASHER, RUBBER THRUST
22	1188690	22-FTH20LW	ECCENTRIC SCREW	42	1188661	40-FTH20LW	BALL BEARING
23	1208117	23-FTH20LW	HANDLE SCREW	46A	1183585	46A-4300	SCREW (2 REQUIRED)
23A	1188717	23A-FTH20LW	HANDLE LOCK SCREW	55	1214665	55-525MAG2	BALL BEARING
23B	1207784	23B-FTH20LW	HANDLE SCREW WASHER	55A	1214666	55A-525MAG2	BALL BEARING 6X10X2.5
24	1242787	24-FTHSD12	HANDLE	55L	1192031	55L-965	BALL BEARING (2 REQUIRED)
24A	1188715	24A-FTH20LW	HANDLE THRUST WASHER	62	1188664	62-FTH20LW	CLICK SPRING
26	1188692	26-FTH20LW	BUSHING	62C	1188654	62C-FTH20LW	SCREW M26.X4 (3 REQUIRED)
26A	1242792	26A-FTHSD12	WASHER	66	1242797	66-FTHSD12	CENTRIFUGAL BRAKE
26B	1208114	26B-FTH20LW	SPOOL TENSION CONTROL CAP	66B	1242798	66B-FTHSD12	SCREW (3 REQUIRED)
26D	1125769	26D-525MAG2	SPOOL TENSION CLICK SPRING	69	1188657	69-FTH20LW	RETAINER 2X5
26F	1125768	26F-525MAG2	SPOOL TENSION RATCHET, INNER	69A	1188659	69A-FTH20LW	RETAINER 3X7 (3 REQUIRED)
26G	1125772	26G-525MAG2	SPOOL TENSION RATCHET, OUTER				

71B	1230226	71B-TRQ40	SPOOL DRIVER	98W	1242801	98W-FTHSD12	RATCHET THRUST WASHER
71C	1230227	71C-TRQ40	RETAINING RING	120	1184522	120-113H	O'RING
71L	1242810	71L-FTHSD15	SPOOL SHAFT	149	1184702	149-45	ROD CLAMP LONG NUT (2 REQUIRED)
86	1184251	86-49L	DRAG WASHER KEYED (2 REQUIRED)	149A	1184706	149-200	HEX NUT (2 REQUIRED)
98	1188700	98-FTH20LW	MAIN GEAR SHAFT	154	1242803	154-FTHSD12	SHIM (AS NEEDED)
98R	1242800	98R-FTHSD12	ANTI-REVERSE RATCHET	183	1242811	183-FTHSD15	FRAME

NOTE: Many of www.pennparts.com schematics include changes that were either made by Penn, or errors found and corrected by our parts dept.
SBT Ver. 073016 (Based on Penn's Rev 5, 10/31/14)

4 1180775 4-349 FIBER WASHER (Rev 0 Schematic typo had listed 4-60, but this was incorrect)

BELOW PENN CHANGED THE DESIGN ON LATER MANUFACTURING RUNS:

AS PER REV 0 Penn schematics:

12 1181271 12-555 PINION YOKE (brass)
 12A 1208062 12A-FTH20LW YOKE POST BUSHING (2 REQUIRED)
 Opening in yoke measures .263" and brass yoke is .043" thick
 Diameter of screw holes was ALSO changed, so if changing to the yoke, you must also change the bushings.

AS PER REV 4 Penn schematics:

12 1318919 12-FTHSD12 PINION YOKE (stainless)
 12A 1372972 12A-FTHSD12 YOKE POST BUSHING (2 REQUIRED)
 Opening in yoke measures .253" and stainless? yoke is .063" thick**

**Increased thickness in the yoke in later reels sits better/snugger in the groove of the #13 pinion, so there is less slop in shifting eccentric