

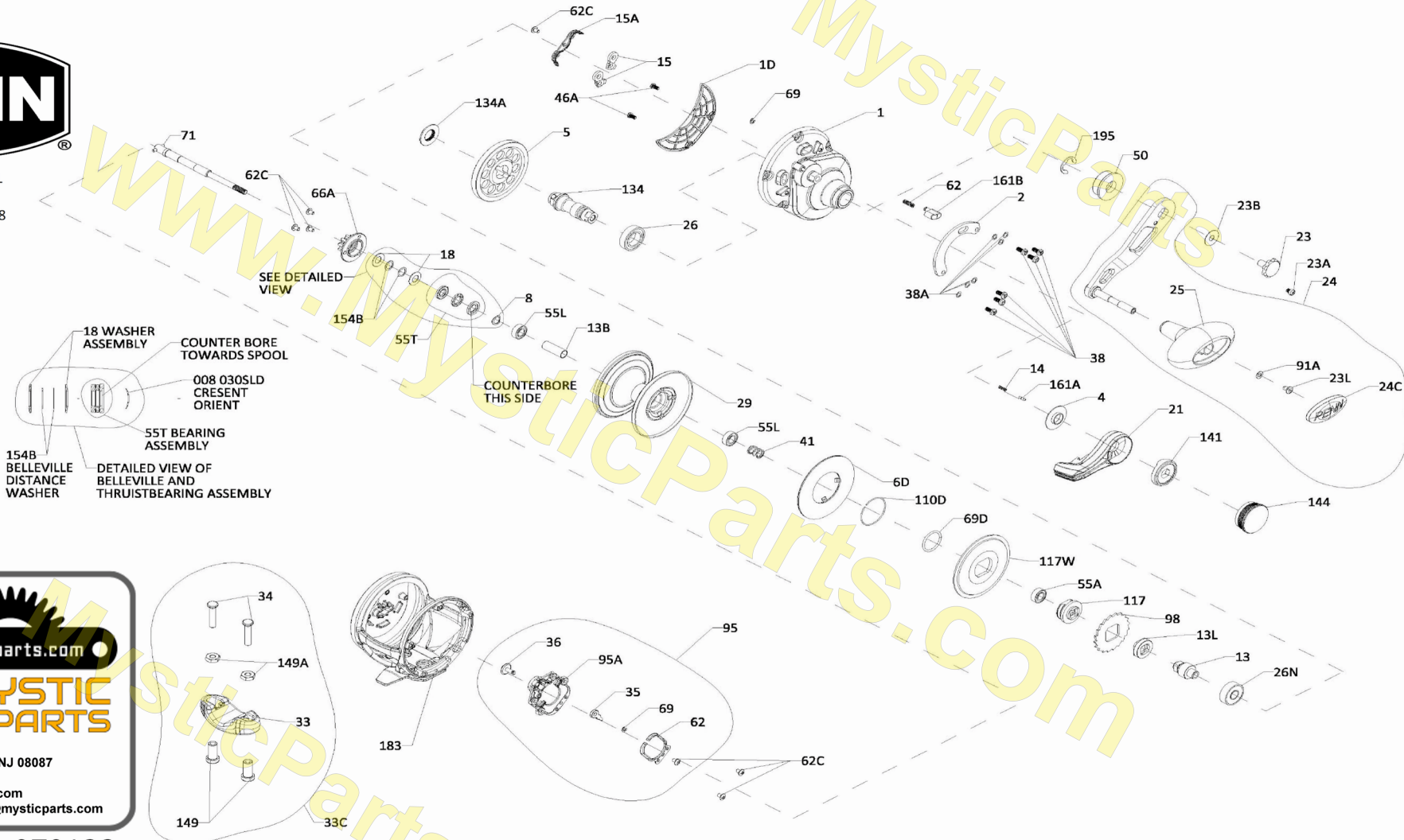

PARTS LIST FOR MODEL  
FATHOM II 25NLD  
REEL PART NO. 1563378  
FTHi25NLD



18 WASHER ASSEMBLY  
COUNTER BORE TOWARDS SPOOL  
008 030SLD CRESNET ORIENT  
55T BEARING ASSEMBLY  
154B BELLEVILLE DISTANCE WASHER  
DETAILED VIEW OF BELLEVILLE AND THRUISTBEARING ASSEMBLY  
COUNTERBORE THIS SIDE

mysticparts.com  
**MYSTIC REEL PARTS**  
965 Radio Road  
Little Egg Harbor, NJ 08087  
+1 (609) 296-1300  
www.mysticparts.com  
customerservice@mysticparts.com

MRP Ver. 070123  
(based on Penn's Rev. 0 2-17-22)

# Penn Reel Parts list for Model: Fathom Leverdrag FTHii25NLD (Silver / Black) 2nd Generation

KEY	PUREFISHING	PENN		KEY	PUREFISHING	PENN	
<u>NO</u>	<u>7 Digit PART #</u>	<u>PART #</u>	<u>DESCRIPTION</u>	<u>NO</u>	<u>7 Digit PART #</u>	<u>PART #</u>	<u>DESCRIPTION</u>
1	1580137	1-FTHii25NLD	HANDLE SIDE PLATE	46A	1488755	46A-FTHii30LW	SCREW, COVER (2 REQUIRED)
1D	1580170	1D-FTHii25NLD2	GEAR BOX COVER	50	1309888	50-FTH30LD2	GEAR SHIELD
2	1580174	2-FTHii25NLD2	QUADRANT RING	55A	1238912	55A-50SLD	BALL BEARING (NON-HANDLE SIDE PLATE)
4	1264978	4-TRQ15LD2	LEVER WASHER	<b>55L SEE CORRECTIONS</b>			
5	1338139	5-FTH30LD	MAIN GEAR	55T	1238913	55T-30SLD	BEARING ASSEMBLY
8	1257843	8-30SLD	SPRING WASHER	62	1188664	62-FTH20LW	CLICK SPRING
13	1338143	13-FTH30LD	PINION	62A	1236596	62-TRQ40	SPRING, STRICK BUTTON
13B	1309867	13B-FTH25NLD2	SPOOL SLEEVE	62C	1188654	62C-FTH20LW	SCREW (4 REQUIRED)
13L	1338146	13L-FTH40NLD	SPACER	66A	1265059	66A-FTHLD	CLICK RATCHET
14	1181406	14-535	SPRING, DRAG LEVER PIN	69	1188657	69-FTH20LW	RETAINING E-RING (3 REQUIRED)
15	1229374	15-TRQ40	DOG ASSEMBLY (2 REQUIRED)	69D	1265060	69D-FTH15LD	RETAINING RING, DRAG
15A	1580194	15A-FTHiILD	RETAINER FOR ANTI REVERSE DOG	71	1580232	71-FTHii25NLD2	SPOOL SPINDLE
18	1265001	18-TRQ40NLD2	WASHER, SPRING (2 REQUIRED)	91A	1277514	91A-TRQ40NLD2	HANDLE KNOB WASHER
21	1580196	21-FTHii30LD2	LEVER DRAG (BLACK)	95	1580237	95-FTHiILD2	CLICK MODULE ASSEMBLY
23	1208117	21-FTH20LW	HANDLE SCREW REV 0 ERROR	95A	1580238	95A-FTHiILD2	CLICK MODULE HOUSING
23A	1188717	23-FTH20LW	HANDLE LOCK SCREW REV 0 ERROR	98	1265073	98-FTH40NLD2	DOG RATCHET
23B	1207784	23B-FTH20LW	HANDLE NUT WASHER	110D	1309895	110D-FTH15LD2	RETAINING RING
23L	1191283	23L-750	HANDLE KNOB SCREW	117	1309896	117-FTH15LD2	DRIVE PLATE
24	1580204	24-FTHii25NLD	HANDLE ASSEMBLY (SILVER/BLACK)	117A	1309898	117A-FTH25NLD2	DRAG WASHER (ASSEMBLY)
24C	1191335	24C-66	HANDLE KNOB CAP	117W	1309901	117W-FTH25NLD2	DRAG WASHER, METAL
25	1240293	25-TRQ40	HANDLE KNOB	134	1338160	134-FTH40NLD	GEAR STUD
26	1265023	26-TRQ40NLD2	BALL BEARING	134A	1265086	134A-30SLD2	GEAR STUD NUT
26N	1182145	26N-25	BALL BEARING	141	1580246	141-FTHiILD	CAM FOLLOWER
29	1580212	29-FTHii25NLD2	SPOOL (SILVER/BLACK)	144	1580247	144-FTHiILD	PRESET KNOB ASSEMBLY
33	1290729	33-TRQ	ROD CLAMP ALUMINUM	149	1184702	149-45	ROD CLAMP NUT (2 REQUIRED)
33C	1580218	33C-FTHiILD2	ROD CLAMP KIT	149A	1184706	149-200	ROD CLAMP HEX NUT (2 REQUIRED)
34	1580220	34-FTHiILD2	ROD CLAMP SCREW (2 REQUIRED)	154B	1309904	154B-FTH40NLD2	BELLEVILLE DISTANCE WASHER
35	1188656	35-FTH20LW	CLICK TONGUE	154B	1309903	154B-FTH25NLD2	BELLEVILLE DISTANCE WASHER
36	1516151	36-FTHii15SD	CLICK BUTTON	161A	1265098	161A-TRQ15LD2	PIN, LEVER CLICK
38	1309885	38-FTH15LD	SCREW (5 REQUIRED)	161B	1265099	161B-TRQ40NLD2	STRIKE BUTTON
38A	1188649	38A-FTH20LW	FLAT WASHER (5 REQUIRED)	183	1580255	183-FTHii25NLD2	FRAME ASSEMBLY
41	1265056	41-TRQ40NLD2	SPRING, DRAG DISENGAGING	195	1184955	195-40	GEAR STUD RET. E-RING

## ERRORS / CORRECTIONS

**55L 1286985 55L-FTH20LD2 BALL BEARING (SPOOL) (2 REQUIRED)  
ON THE DRAWING, NOT ON REV 0 PARTS LIST**

## **MYSTIC REEL PARTS REVISION!**

### NOTE:

Many of www.mysticparts.com schematics include changes that were either made by Penn, or errors found and corrected by our parts dept.

MRP Ver. 070123 (based on Penn's Rev. 0 2-17-22)