

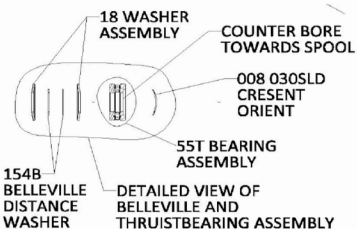

PARTS LIST FOR MODEL
Fathom II 10XNLD
REEL PART NO. 1563376
FTHii10XNLD



SEE DETAILED VIEW

COUNTERBORE THIS SIDE

mysticparts.com
MYSTIC REEL PARTS
965 Radio Road
Little Egg Harbor, NJ 08087
+1 (609) 296-1300
www.mysticparts.com
customerservice@mysticparts.com

MRP Ver. 070123

(based on Penn's Rev. 1 6-14-22)

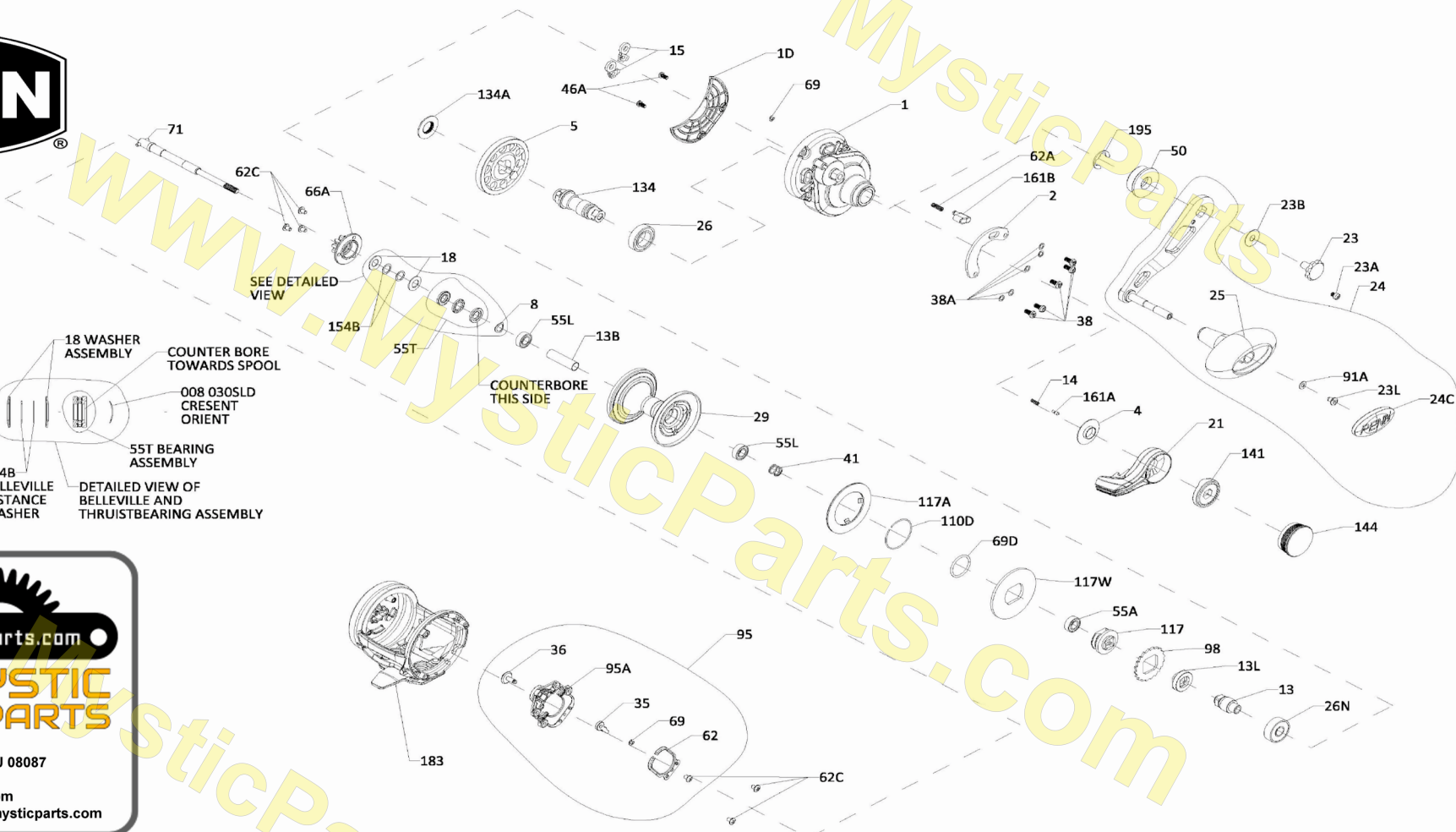

Penn Reel Parts list for Model: Fathom Leverdrag FTHii10XNLD (Silver / Black) 2nd Generation

| KEY | PUREFISHING | PENN | | KEY | PUREFISHING | PENN | |
|-------------------------------------|-----------------------|------------------|--------------------------------|-----------|-----------------------|------------------|---|
| <u>NO</u> | <u>7 Digit PART #</u> | <u>PART #</u> | <u>DESCRIPTION</u> | <u>NO</u> | <u>7 Digit PART #</u> | <u>PART #</u> | <u>DESCRIPTION</u> |
| 1 | 1580132 | 1-FTHii10XNLD | HANDLE SIDE PLATE | 46A | 1488755 | 46A-FTHii30LW | SCREW, COVER (2 REQUIRED) |
| 1D | 1580169 | 1D-FTHii15LD2 | GEAR BOX COVER | 50 | 1309888 | 50-FTH30LD2 | GEAR SHIELD |
| 2 | 1580173 | 2-FTHii15LD2 | QUADRANT RING | 55A | 1238912 | 55A-50SLD | BALL BEARING (NON-HANDLE SIDE PLATE) |
| 4 | 1264978 | 4-TRQ15LD2 | LEVER WASHER | 55L | 1286985 | 55L-FTH20LD2 | BALL BEARING (SPOOL) (2 REQUIRED) |
| 5 | 1338138 | 5-FTH15LD | MAIN GEAR | 55T | 1238913 | 55T-30SLD | BEARING ASSEMBLY |
| 8 | 1257843 | 8-30SLD | SPRING WASHER | 62 | 1188664 | 62-FTH20LW | CLICK SPRING |
| 13 | 1338142 | 13-FTH15LD | PINION | 62A | 1236596 | 62-TRQ40 | SPRING, STRICK BUTTON |
| 13B | 1580185 | 13B-FTHii10XNLD2 | SPOOL SLEEVE | 62C | 1188654 | 62C-FTH20LW | SCREW (4 REQUIRED) |
| 13L | 1338146 | 13L-FTH40NLD | SPACER | 66A | 1265059 | 66A-FTHLD | CLICK RATCHET |
| 14 | 1181406 | 14-535 | SPRING, DRAG LEVER PIN | 69 | 1188657 | 69-FTH20LW | RETAINING E-RING (3 REQUIRED) |
| 15 | 1229374 | 15-TRQ40 | DOG ASSEMBLY (2 REQUIRED) | 69D | 1265060 | 69D-FTH15LD | RETAINING RING, DRAG |
| 18 | 1265001 | 18-TRQ40NLD2 | WASHER, SPRING (2 REQUIRED) | 71 | 1580229 | 71-FTHii10XNLD2 | SPOOL SPINDLE |
| 21 | 1580195 | 21-FTHii15LD2 | LEVER DRAG (BLACK) | 91A | 1277514 | 91A-TRQ40NLD2 | HANDLE KNOB WASHER |
| 23 & 23A SEE CORRECTIONS | | | | 95 | 1580237 | 95-FTHiiLD2 | CLICK MODULE ASSEMBLY |
| 23B | 1207784 | 23B-FTH20LW | HANDLE NUT WASHER | 95A | 1580238 | 95A-FTHiiLD2 | CLICK MODULE HOUSING |
| 23L | 1191283 | 23L-750 | HANDLE KNOB SCREW | 98 | 1265072 | 98-FTH15LD2 | DOG RATCHET |
| 24 | 1580204 | 24-FTHii25NLD | HANDLE ASSEMBLY (SILVER/BLACK) | 110D | 1309895 | 110D-FTH15LD2 | RETAINING RING |
| 24C | 1191335 | 24C-66 | HANDLE KNOB CAP | 117 | 1309896 | 117-FTH15LD2 | DRIVE PLATE |
| 25 | 1240293 | 25-TRQ40 | HANDLE KNOB | 117A | 1309897 | 117A-FTH15LD2 | DRAG WASHER (ASSEMBLY) |
| 26 | 1265023 | 26-TRQ40NLD2 | BALL BEARING | 117W | 1309900 | 117W-FTH15LD2 | DRAG WASHER, METAL |
| 26N | 1182145 | 26N-25 | BALL BEARING | 134 | 1338160 | 134-FTH40NLD | GEAR STUD |
| 29 | 1580209 | 29-FTHii10XNLD2 | SPOOL (SILVER/BLACK) | 134A | 1265086 | 134A-30SLD2 | GEAR STUD NUT |
| 35 | 1188656 | 35-FTH20LW | CLICK TONGUE | 141 | 1580246 | 141-FTHiiLD | CAM FOLLOWER |
| 36 | 1516151 | 36-FTHii15SD | CLICK BUTTON | 144 | 1580247 | 144-FTHiiLD | PRESET KNOB ASSEMBLY |
| 38 | 1309885 | 38-FTH15LD | SCREW (5 REQUIRED) | 154B | 1309904 | 154B-FTH40NLD2 | BELLEVILLE DISTANCE WASHER (2 REQUIRED) |
| 38A | 1188649 | 38A-FTH20LW | FLAT WASHER (5 REQUIRED) | 161A | 1265098 | 161A-TRQ15LD2 | PIN, LEVER CLICK |
| 41 | 1309886 | 41-FTH15LD2 | SPRING, DRAG DISENGAGING | 161B | 1265099 | 161B-TRQ40NLD2 | STRIKE BUTTON |
| | | | | 183 | 1580251 | 183-FTHii10XNLD2 | FRAME ASSEMBLY |
| | | | | 195 | 1184955 | 195-40 | GEAR STUD RET. E-RING |

ERRORS / CORRECTIONS

| | | | |
|-----|--------------------|-----------------------|---|
| 23 | 1208117 | 21-FTH20LW | HANDLE SCREW REV 0 ERROR |
| | 1589722 | 23-FTHiiLD | HANDLE SCREW (BLACK) **USE THIS** |
| 23A | 1188717 | 23-FTH20LW | HANDLE LOCK SCREW REV 0 ERROR |
| | 1589723 | 23A-FTHiiLD | HANDLE LOCK SCREW (BLACK) **USE THIS** |

MYSTIC REEL PARTS REVISION!

NOTE:

Many of www.mysticparts.com schematics include changes that were either made by Penn, or errors found and corrected by our parts dept.

MRP Ver. 070123 (based on Penn's Rev. 1 6-14-22)