

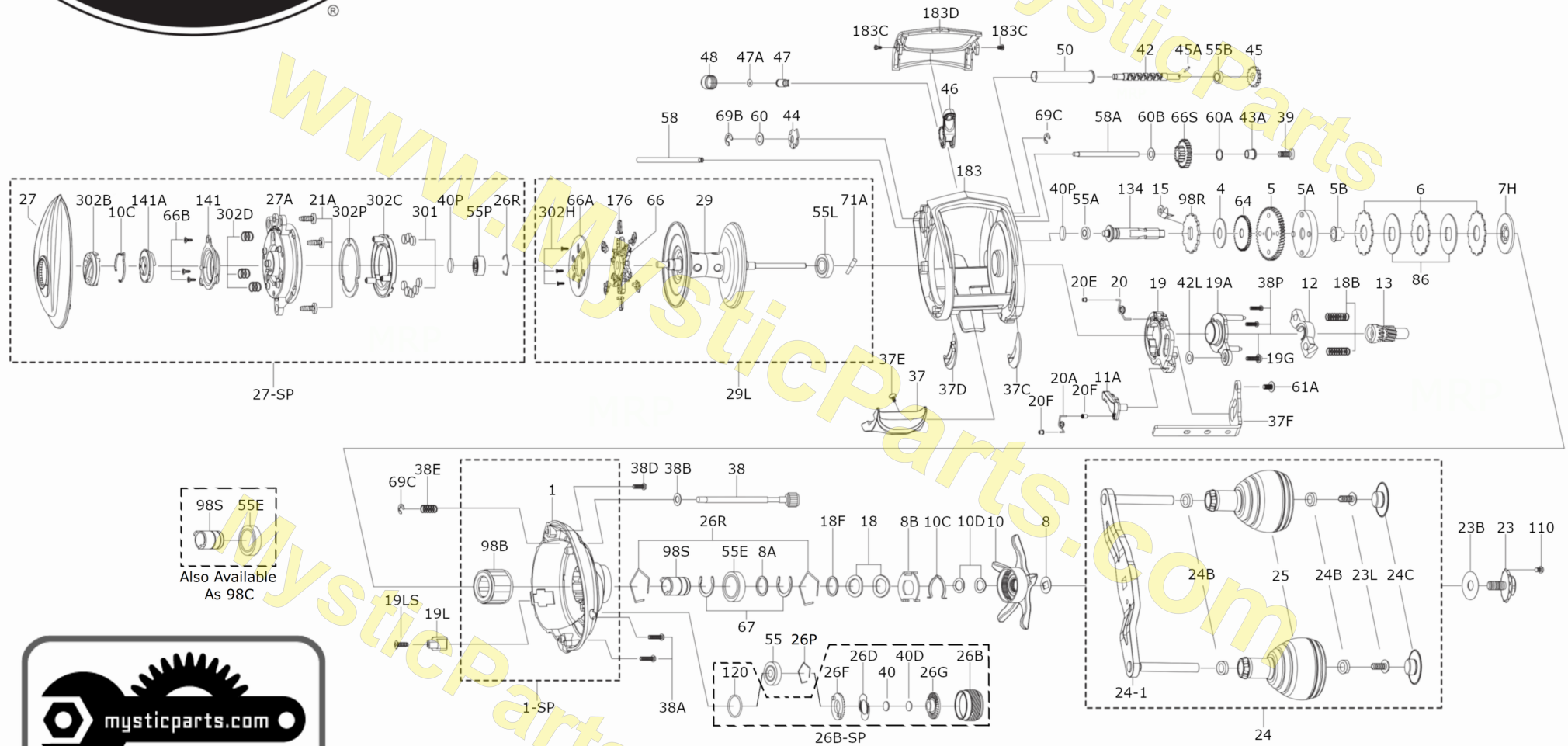

Fathom Low Profile



mysticparts.com
MYSTIC REEL PARTS
965 Radio Road
Little Egg Harbor, NJ 08087
+1 (609) 296-1300
www.mysticparts.com
customerservice@mysticparts.com

PARTS LIST FOR MODEL
FTH 400LPHS
REEL PART NO. 1525499
MRP Rev. 1-D

MODEL: Fathom Low Profile 400LPHS High Speed (FTH400LPHS)

Key No.	Pure Fishing No.	Part No.	Description	Key No.	Pure Fishing No.	Part No.	Description
1	1539041	1-FTH400LPHS	Handle Side Plate (Plate Only)	38D	1380640	38D-SQL400LP	Upper Handle Side Plate Screw
1-SP	1539048	1-FTH400LPHSSP	Handle Side Plate Assembly	38E	1144205	38E-SQL400LP	Thumb Screw Tension Spring
4	1380624	4-SQL400LP	Hard Fiber Spacer Washer	38P	1187621	50A-PUR	Upper Handle Side Plate Screw
5	1400399	5-SQL400LPHS	High Speed Main Gear	39	1380605	39-SQL400LP	Level Wind Gear Bushing Screw
5A	1380627	5A-SQL400LP	Drag Washer Drum	40	1125770	40-PUR	Friction Washer
5B	1380628	5B-FTH400LP	Bushing, Main Gear Shaft Bushing	40D	1125771	40D-525MAG2	Black Rubber Thrust Washer
6	1380629	6-SQL400LP	Notched Edge Ht100 Round Washer (Uses 2)	40P	1125797	40C-PUR	Hard Fiber Friction Thrust Washer
7H	1380631	7H-FTH400LP	Washer, Pressure Washer	42	1380598	42-FTH400LP	Shaft, Worm Shaft
8	1380647	8-SQL400LP	Round Square-Keyed Handle Washer	42L	1380614	42L-SQL400LP	Guard Post Washer
8A	1392846	8A-FTH400LP	Handle Side Plate Bearing Shim	43A	1380604	43A-SQL400LP	Level Wind Gear Bushing
8B	1380643	8B-SQL400LP	Click Spring Holder	44	1380599	44-SQL400LP	Non-Handle Side Worm Bushing
10	1539031	10-FTH400LP	Star Drag Wheel	45	1125732	45-SQL200LP	Worm Gear
10C	1380644	10C-SQL400LP	Click Spring	45A	1125733	45A-PUR	Worm Dowel Pin
10C	1125780	10B-PUR	Click Spring	46	1515955	46-FTH400LP	Guide, Line Guide
10D	1380645	10D-SQL400LP	Round Keyed Handle Washer	47	1515956	47-SQL400LP	Pawl
11A	1380608	11A-SQL400LP	Eccentric Lever	47A	1380601	47A-SQL400LP	Pawl Cover Washer
12	1380617	12-SQL400LP	Yoke	48	1129323	48-SQL200LP	Pawl Cover Screw Cap
13	1515982	13-SQL400LPHS	High Speed Pinion Gear	50	1380597	50-SQL400LP	Worm Shield
15	1380622	15-SQL400LP	Anti-Reverse Dog	55	1515959	55-SQL400LP	Handle Side Plate Bearing
18	1380642	18-SQL400LP	Spring Washer	55A	1281216	55A-SQL200LP	Handle Side Frame Bearing
18B	1380618	18B-SQL400LP	Yoke Spring	55B	1132853	55B-SQL200LP	Handle Side Worm Bearing
18F	1380641	18F-SQL400LP	Star Drag Wheel Spacer Washer	55E	1380639	55E-SQL400LP	Handle Side Plate Bearing
19	1380609	19-SQL400LP	Eccentric Cam	55L	1380657	55L-SQL400LP	Handle Side Spool Bearing
19A	1380615	19A-SQL400LP	Eccentric Cam Plate	55P	1128194	55-PUR	Ball Bearing
19G	1380616	19G-SQL200LP	Eccentric Cam Plate Screw	58	1380600	58-SQL400LP	Line Guide Post
19L	1539030	19L-SQL400LP	Lube Port Cover	58A	1380602	58A-SQL400LP	Level Wind Guard Post
19LS	1252079	19LS-SQL400LP	Lube Port Cover Screw	60	1490867	60-SQL200LP	Worm Shaft Washer
20	1380607	20-SQL400LP	Eccentric Cam Spring	60A	1144184	60A-SQL400LP	Idler Gear Spacer Shim
20A	1125742	20A-SQL400LP	Eccentric Lever Spring	60B	1124178	60B-SQL400LP	Idler Gear Spacer Shim
20E	1380606	20E-SQL300LP	Clutch Spring Bushing	61A	1125822	61A-PUR	Thumb Bar Clutch Link Screw
20F	1116230	19B-PUR	Insert	64	1380603	64-SQL400LP	Idler Gear
21A	1124746	37E-PUR	Screw	66	1380659	66-FTH400LP	Holder, Brake Weight Holder
23	1380666	23-SQL400LP	Handle Nut	66A	1380661	66A-FTH400LP	Cover, Brake Weight Cover
23B	1380665	23B-SQL400LP	Handle Screw Washer	66B	1380655	66B-SQL200LP	Slide Cam Screw (Uses 3)
23L	1208090	23L-SQL200LP	Handle Knob Screw	66S	1380625	66-SQL400LP	Worm Drive Gear
24	1539049	24-FTH400LPHS	Handle Complete Assembly (High Speed)	67	1380638	67-FTH400LP	Ring
24B	1208088	24B-SQL200LP	Handle Knob Bushing (Uses 4)	69B	1124201	69B-PUR	Retainer
24C	1539047	24C-FTH400LPHS	Cap, Handle Knob Cap	69C	1116226	69C-PUR	Retainer
24-1	1539045	24-FTH400LPHSSP	Handle (Blank) (High Speed)	71A	1380658	71A-SQL400LP	Spool Spindle Dowel Pin
25	1539046	25-FTH400LPHS	Knob, Handle Knob	86	1380630	86-FTH400LP	Washer, Drag Washer
26B	1539042	26B-FTH400LPHS	Brake Adjustment Dial	98B	1380633	98B-SQL400LP	Anti-Reverse Clutch Bearing
26B-SP	-----	26B-FTH400LP	Spool Tension Control Cap Kit	98C	-----	98C-SQL400LPS	Clutch Sleeve Assembly
26D	1125769	26D-525MAG2	Spool Tension Click Spring	98R	1380623	98R-SQL400LP	Ratchet
26F	1125768	26F-525MAG2	Inner Spool Tension Ratchet Washer	98S	1380637	98S-FTH400LP	Sleeve, A/R Sleeve
26G	1125772	26G-525MAG2	Click Washer	110	1380667	110-SQL400LP	Locking Plate Screw
26P	1104790	173-PUR	Bearing Retainer Ring	120	1185714	26R-PUR	O-Ring
26R	1380636	26R-SQL400LP	Bearing Retainer Ring	134	1380621	134-FTH400LP	Gear Stud
27	1539043	27-FTH400LPHS	Palm Side Plate (Plate Only)	141	1380654	141-SQL400LP	Slide Cam
27A	1380651	27A-FTH400LP	Housing, Bearing Housing	141A	1380650	141A-SQL400LP	Slide Cam Insert
27-SP	1539050	27-FTH400LPHSSP	Palm Side Plate Assembly	176	1380660	176-FTH300LP	Weight, Brake Weight
29	1539044	29-FTH400LPHS	Spool Core	183	1539026	183-FTH400LP	Frame
29L	1539051	29L-FTH400LPHS	Spool Complete Assembly (High Speed)	183C	1125738	183C-PUR	Frame Grill Screw
37	1380611	37-SQL400LP	Thumb Bar	183D	1539027	183D-SQL400LP	Frame Front Grille
37C	1380595	37C-SQL400LP	Right Side Thumb Bar Clutch Plate	301	1116222	301-SQL300LP	Magnet (Uses 5)
37D	1380594	37D-SQL400LP	Left Side Thumb Bar Clutch Plate	302B	1441801	302B-SQL400LP	Brake Adjustment Dial
37E	1380612	37E-SQL400LP	Thumb Bar Clutch Screw	302C	1380653	302C-FTH400LP	Holder, Magnet Holder
37F	1380610	37F-SQL400LP	Thumb Bar Clutch Link	302D	1313476	302D-SQL200LP	Magnet Holder Spring (Uses 3)
38	1380634	38-SQL400LP	Cam Lock Thumb Screw	302H	1185710	302H-SQL200LP	Brake Adjustment Dial Screw
38A	1257013	38A-SQL400LP	Lower Handle Side Plate Screw	302P	1380652	302P-SQL400LP	Magnet Plate
38B	1133903	38B-SQL400LP	Thumb Screw Washer				

MYSTIC REEL PARTS REVISION!

NOTE: Many of www.mysticparts.com schematics include changes that were either made by Penn, or errors found and corrected by our parts dept.

FOR THE SQUALL AND FATHOM LOW PROFILE REELS

WE REVISED KEY # AND LP SPECIFIC PART NUMBERS TO MATCH PENN'S FORMATTING

MRP Rev 1 Ver 120124 (based on Penn's Rev. 0)