

www.PENNparts.com

 **Scott's Bait & Tackle**

Penn Parts Dept.
945 Radio Road
Tuckerton NJ 08087
(609) 296-1300

No Minimum Order!
Plus, Parts in stock
that Penn doesn't
carry anymore.

SBT Ver 110613

(Based on Penn's Rev 1 8-28-12)

DEFIANCE 25LW

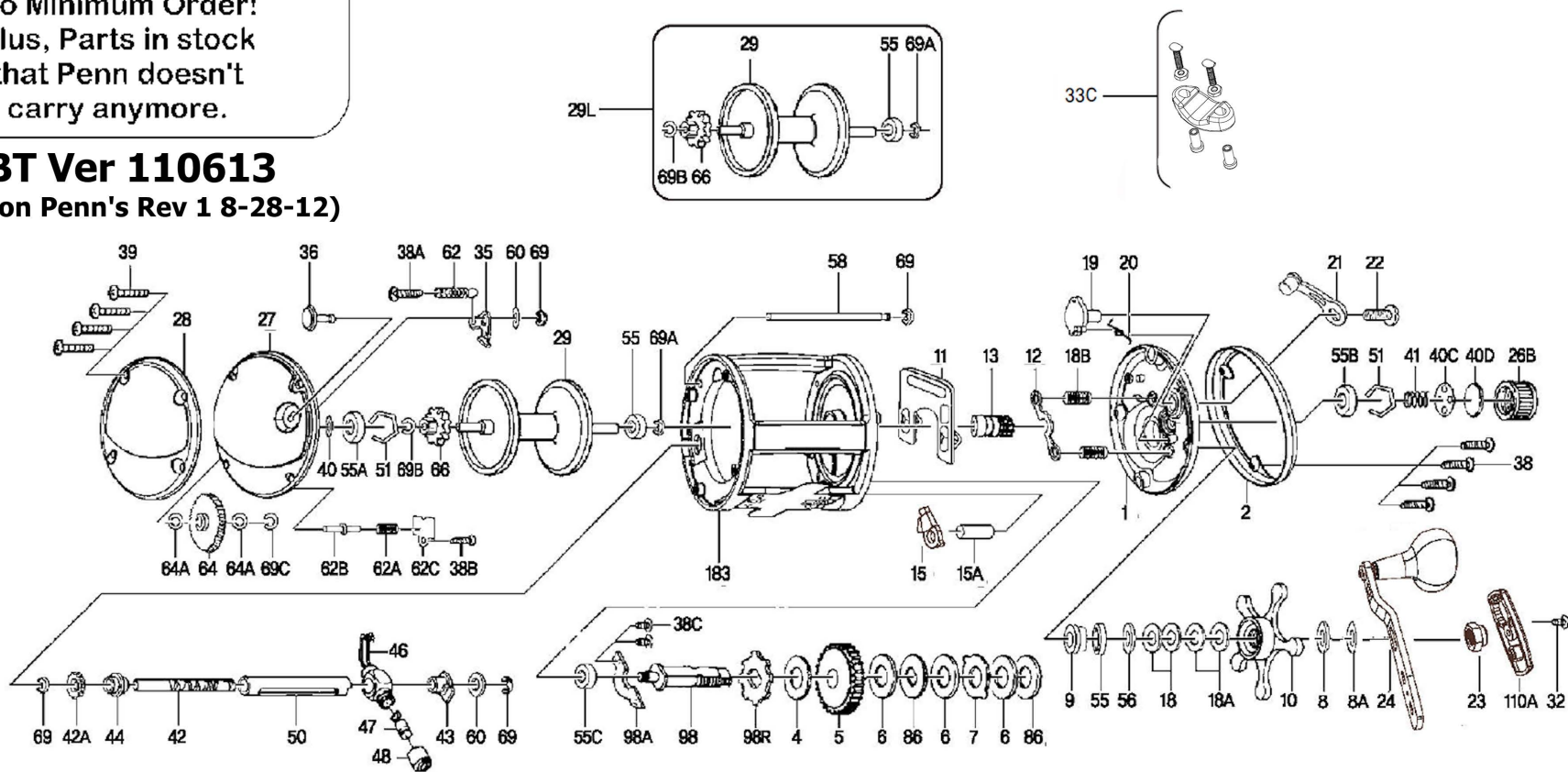

Penn Reel Parts list for:

Model: DFN25LW Defiance Levelwind

KEY	Penn's	PureFishing	DESCRIPTION	KEY	Penn's	PureFishing	DESCRIPTION
NO	Part #	Part #		NO	Part #	Part #	
1	1-DFN25LW	1257567	PLATE, HANDLE SIDE	39	39-DFN25LW	1257754	SCREW, TAPPING (4)
2	2-DFN25LW	1257641	RING, HANDLE SIDE	40	40-DFN20LW	1257710	THRUST DISC, METAL
4	4-DFN20LW	1257644	WASHER, FIBER	40C	40C-DFN20LW	1257711	THRUST DISC, METAL
5	5-DFN20LW	1257645	GEAR, MAIN	40D	40D-DFN20LW	1257712	THRUST DISC, RUBBER
6	6-DFN20LW	1257646	WASHER, FRICTION DRAG (3)	41	41-DFN20LW	1257713	SPRING, COIL
7	7-DFN20LW	1257647	WASHER, EARRER DRAG	42	42-DFN20LW	1257714	WORM SHAFT
8	8-DFN20LW	1257648	WASHER, TENSION (ROUND KEYED METAL)	42A	42A-DFN25LW	1257753	WORM GEAR
8A ***	8A-DFN20LW	???	HANDLE SPACER (RECT. WITH BENT SIDES)	43	43-DFN20LW	1257716	WORM BUSHING, HANDLE SIDE
9	9-DFN20LW	1257649	BUSHING, BRASS	44	44-DFN20LW	1257717	WORM BSHNG, NON-HAND. SIDI
10	10-DFN20LW	1257650	DRAG STAR ASSEMBLY	46	46-DFN20LW	1257718	LINE GUIDE
11	11-DFN20LW	1257651	ECCENTRIC JACK	47	47-DFN20LW	1257719	PAWL
12	12-DFN20LW	1257652	PINION YOKE	48	48-DFN20LW	1257720	SCREW F/LINE GUIDE
13	13-DFN20LW	1257653	PINION	50	50-DFN20LW	1257721	WORM SHIELD
15	15N-DFN20LW	1344584	DOG (revised)	51	51-DFN20LW	1257722	RETAINER, WIRE HEX (2)
15A	15A-DFN20LW	1257655	DOG POST	55	55-DFN20LW	1257723	BALL BEARING (2)
18	18-DFN20LW	1257656	WASHER, TENSION SPRING (2)	55A	55A-DFN20LW	1257724	BALL BEARING
18A	18A-DFN20LW	1257657	WASHER, TENSION SPRING (2)	55B	55B-DFN20LW	1257725	BEARING, SOLID BRASS
18B	18B-DFN20LW	1257658	SPRING, COIL (2)	55C	55C-DFN20LW	1257726	BALL BEARING
19	19-DFN25LW	1257751	ECCENTRIC CAM	56	56-DFN20LW	1257727	SHIM
20	20-DFN20LW	1257660	ECCENTRIC SPRING	58	58-DFN20LW	1257728	POST, LINE GUIDE POST
21	21-DFN25LW	1257752	ECCENTRIC LEVER	60	60-DFN20LW	1257729	WASHER, FLAT (2)
22	22-DFN20LW	1257662	ECCENTRIC SCREW	62	62-DFN20LW	1257730	SPRING, CLICK SPRING
23	23-DFN20LW	1257663	NUT, HANDLE	62A	62A-DFN20LW	1257731	SPRING, COIL
24	24-DFN20LW	1257664	HANDLE ASSEMBLY	62B	62B-DFN25LW	1257750	CLICK TENSION SHAFT
26B	26B-DFN20LW	1257665	CAP, SPOOL TENSION	62C	62C-DFN20LW	1257733	PLATE, CLICK TENSION
27	27-DFN25LW	1257667	PLATE, NON-HANDLE SIDE	64	64-DFN20LW	1257734	GEAR, IDLER
28	28-DFN25LW	1257671	RING, NON-HANDLE SIDE	64A	64A-DFN20LW	1257735	WASHER, FLAT (2)
29	29-DFN25LW	1257675	SPOOL	66	66-DFN20LW	1257736	CLICK RATCHET
29L	29L-DFN25LW	1257679	SPOOL ASSEMBLY	69	69-DFN20LW	1257737	RETAINER, E RING (4)
32	32-DFN20LW	1257682	SCREW, MACHINED	69A	69A-DFN20LW	1257738	RETAINER, C RING
33C	33C-DFN40LW	1291631	ROD CLAMP KIT	69B	69B-DFN20LW	1257739	RETAINER, C RING
35	35-DFN20LW	1257683	CLICK TONGUE	69C	69C-DFN20LW	1257740	RETAINER, C RING
36**	36-DFN20LW	1257684	CLICK BUTTON	86	86-DFN20LW	1257741	WASHER, KEYED DRAG (2)
38	38-DFN20LW	1257685	SCREW, TAPPING (4)	98	98-DFN20LW	1257742	STUD, MAIN GEAR
38A	38A-DFN20LW	1257686	SCREW, WASHER HEAD	98A	98A-DFN20LW	1257743	PLATE, F/MAIN GEAR STUD
38B	38B-DFN20LW	1257687	SCREW, TAPPING	98R	98R-DFN20LW	1257744	RATCHET, ANTI-REVERSE
38C	38C-DFN20LW	1257688	SCREW, TAPPING (2)	110A	110A-DFN20LW	1257745	HANDLE NUT LOCK
				183	183-DFN25LW	1257747	FRAME

NOTE: Many of www.pennparts.com schematics include changes that were either made by Penn, or errors found and corrected by our parts dept.
SBT Ver. 110613 (based on Penn's revision 1, 8-28-12)

*** The 8A found in the early run reels is not a supported part by Penn