

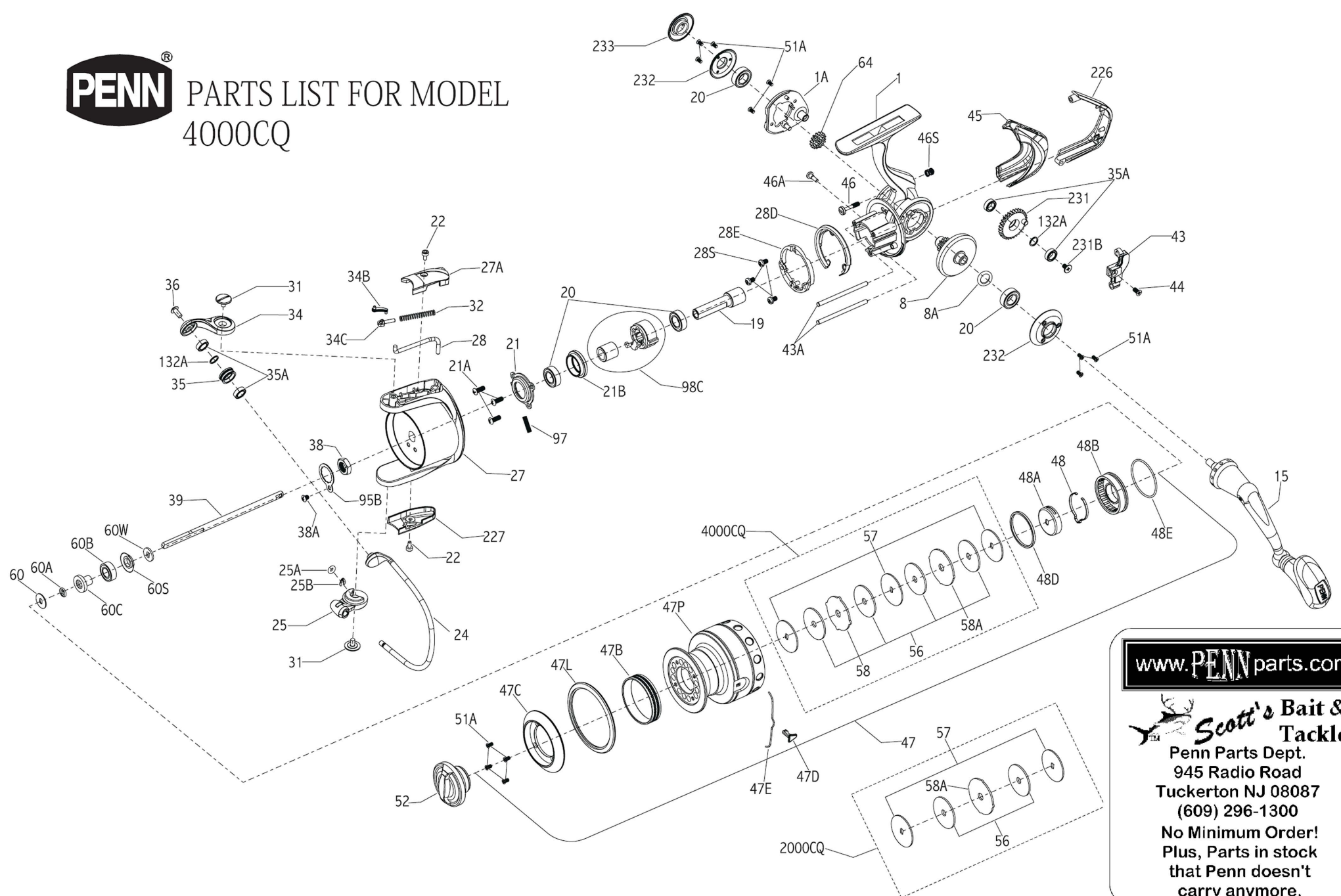

PARTS LIST FOR MODEL 4000CQ



www.PENNparts.com

Scott's Bait & Tackle
Penn Parts Dept.
945 Radio Road
Tuckerton NJ 08087
(609) 296-1300
No Minimum Order!
Plus, Parts in stock
that Penn doesn't
carry anymore.

SBT Ver. 020410

Penn Reel Parts list for:

Model: 4000CQ (also known as CQR4000) Conquer

KEY	PART	DESCRIPTION	KEY	PART	DESCRIPTION
NO	NO.		NO	NO.	
1	1-4000CQ	HOUSING	46A	46A-2000CQ	SCREW
1A	1A-4000CQ	HOUSING PLATE	46S	46S-2000CQ	SPRING
8	8-4000CQ	MAIN GEAR	47	47-4000CQ	SPOOL ASSEMBLY
8A	8A-2000CQ	SHIM	47P	47P-4000CQ	SPOOL (ONLY)
15	15-2000CQ	HANDLE ASSEMBLY	47B	47B-4000CQ	SPOOL BAND
19	19-4000CQ	PINION	47C	47C-4000CQ	SPOOL LIP COVER
20	20-4200	BALL BEARING (USES 4)	47D	47D-2000CQ	LINE CLIP
21	21-2000CQ	BEARING RETAINER	47E	47E-2000CQ	LINE CLIP SPRING
21A	21A-2000CQ	SCREW (USES 3)	47L	47L-4000CQ	SPOOL LIP
21B	21B-2000CQ	COLLAR	48	48-2000CQ	SPOOL CLICK
22	22-2000CQ	SCREW (USES 2)	48A	48A-2000CQ	SPOOL CLICK RETAINER
24	24-4000CQ	BAIL WIRE	48B	48B-2000CQ	SPOOL CLICK HOUSING
25	25-2000CQ	BAIL CAM	48D	48D-2000CQ	SPACER RING
25A	25A-2000CQ	O-RING	48E	48E-2000CQ	O-RING
25B	25B-2000CQ	CLIP	51A	51A-2000CQ	SCREW (12 REQUIRED)
27	27-4000CQ	ROTOR	52	52-2000CQ	DRAG KNOB ASSEMBLY
27A	27A-4000CQ	BAIL PIVOT COVER	56	56-2000CQ	DRAG WASER HT-100 (4 REQUIRED)
28	28-4000CQ	TRIP LEVER	57	57-2000CQ	KEYED WASHER (3 REQUIRED)
28D	28D-4000CQ	FRICTION RING	58	58-4000CQ	EARRED WASHER
28E	28E-4000CQ	FRICTION RING COVER	58A	58A-2000CQ	EARRED WASHER
28S	28S-2000CQ	FRICTION RING SCREW (USES 3)	60	60-2000CQ	SPACER WASHER
31	31-2000CQ	SCREW (USES 2)	60A	60A-2000CQ	O-RING
32	32-2000CQ	BAIL SPRING	60B	60B-2000CQ	BALL BEARING
34	34-2000CQ	BAIL ARM	60C	60C-2000CQ	BEARING SLEEVE
34B	34B-2000CQ	PIVOT LEVER	60S	60S-2000CQ	SEAL
34C	34C-2000CQ	PIVOT ARM	60W	60W-2000CQ	SPOOL SHAFT WASHER
35	35-2000CQ	LINE ROLLER	64	64-4000CQ	IDLER GEAR
35A	35A-2000CQ	BALL BEARING (USES 4)	95B	95B-2000CQ	ROTOR LOCKING PLATE
36	36-2000CQ	SCREW, LINE ROLLER	97	97-2000CQ	CLUTCH SPRING
38	38-2000CQ	ROTOR NUT	98C	98C-2000CQ	CLUTCH/SLEEVE ASSEMBLY
38A	38A-2000CQ	SCREW, ROTOR LOCKING PLATE	132A	132A-2000CQ	SPACER (2 REQUIRED)
39	39-4000CQ	SPOOL SHAFT	226	226-4000CQ	REAR COVER
43	43-4000CQ	CROSSWIND BLOCK	227	227-4000CQ	CAM COVER
43A	43A-4000CQ	CROSSWIND BLOCK PIN (2 REQUIRED)	231	231-4000CQ	CROSSWIND GEAR
44	44-2000CQ	SCREW, CROSSWIND BLOCK	231B	231B-2000CQ	CROSSWIND GEAR SCREW
45	45-4000CQ	MAINTENANCE HATCH	232	232-4000CQ	BEARING RETAINER (2 REQUIRED)
46	46-2000CQ	SCREW	233	233-2000CQ	BEARING COVER

NOTE: Many of www.pennparts.com schematics include changes that were either made by Penn, or errors found and corrected by our parts dept.
SBT Ver. 020410

It is likely that Penn will only sell the 47-4000CQ spool assembly rather than the 47P bare spool.