

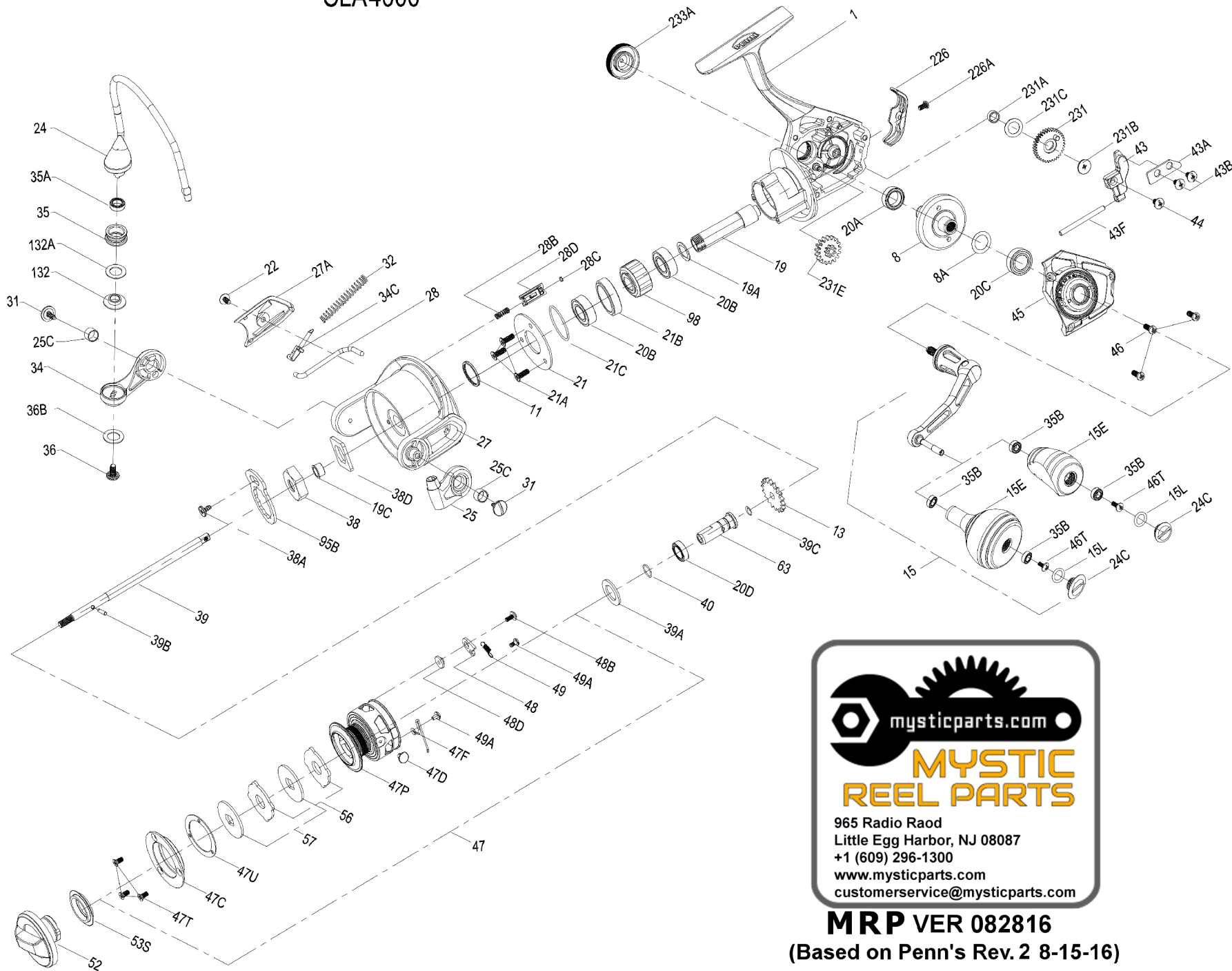

PARTS LIST FOR MODEL CLASH4000/CLASH4000AU  
CLA4000



mysticparts.com  
**MYSTIC REEL PARTS**  
965 Radio Raod  
Little Egg Harbor, NJ 08087  
+1 (609) 296-1300  
www.mysticparts.com  
customerservice@mysticparts.com

**MRP VER 082816**  
(Based on Penn's Rev. 2 8-15-16)

## Penn Reel Parts list for Model: CLA4000 (and CLA4000AU Australian) Clash Spinning

<u>KEY #</u>	<u>PUREFISHING #</u>	<u>PENN PART #</u>	<u>DESCRIPTION</u>	<u>KEY #</u>	<u>PUREFISHING #</u>	<u>PENN PART #</u>	<u>DESCRIPTION</u>
1	1385501	1-CLA4000	Housing Body	39A	1385558	39A-CLA3000	Washer, Spool Adjusting (2 Required)
8	1385502	8-CLA3000	Main Drive Gear	39B	1385559	39B-CLA3000	Pin, Main Shaft
8A	1276920	8A-SSV3500	Drive Gear Shim	39C	1385560	39C-CLA3000	Seal, Main Shaft
11	1385504	11-CLA3000	Rotor Seal	40	1385588	40-CLA3000	Washer, Main Shaft (2 Required)
13	1385505	13-CLA3000	Click Gear (Ratchet)	43	1385561	43-CLA3000	Oscillation Slider (Crosswind Block)
19	1385508	19-CLA3000	Pinion Gear	43A	1385562	43A-CLA3000	Slider Retainer Plate (Crosswind Block Plate)
19A	1277424	19A-SSV3500	Pinion Gear Washer	43B	1277070	43B-SSV5500	Screw, Osc. Slider Guide (2 Required)
19C	1385529	19C-CLA2000	Pinion Gear Bushing	43F	1385563	43F-CLA3000	Guide Shaft
20A	1385530	20A-CLA3000	Sealed Ball Bearing (Housing)	44	1385564	44-CLA3000	Screw, Crosswind Block
20B	1385531	20B-CLA3000	Sealed Ball Bearing (Pinion) (2 Required)	45	1385566	45-CLA4000	Body Cover
20C	1385532	20C-CLA3000	Sealed Ball Bearing (Cover)	46	1385567	46-CLA3000	Screw, Body Cover (3 Required)
20D	1385533	20D-CLA3000	Sealed Ball Bearing (Shaft)	47	1385570	47-CLA4000	Spool Assembly (Inc. Drags/Clicker)
21	1385534	21-CLA3000	Retainer, For Ball Bearing	47C	1385571	47C-CLA3000	Drag Cover
21A	1276926	21A-SSV3500	Screw, Bearing Retainer (3 Required)	47D	1276953	47D-SSV3500	Line Hook
21B	1385535	21B-CLA3000	Bushing, Ball Bearing	47F	1385572	47F-CLA3000	Line Clip Retainer
21C	1385536	21C-CLA3000	O-Ring	47P	1385574	47P-CLA4000	Spool, Bare (usually n/a from Penn)
22	1122148	22-CLA3000	Screw, Roter Cover	47T	1341544	47T-SSV7500LC	Screw, Drag Cover (3 Required)
24	1385538	24-CLA4000	Bail Wire Assembly	47U	1418960	47U-SLA3500	Drag Cover Seal
25	1385539	25-CLA3000	Bail Holder	48	1385578	48-CLA3000	Spool Click Plate
25C	1385540	25C-CLA3000	Bushing, Bail Holder (2 Required)	48B	1385581	48B-CLA3000	Screw, Spool Clicker Spring
27	1385542	27-CLA4000	Rotor	48D	1385579	48D-CLA3000	Spacer Ring, Spool Clicker
27A	1389434	27A-CLA4000	Rotor Cover	49	1385580	49-CLA3000	Pulling Spring (Clicker)
28	1385544	28-CLA4000	Rotor Trip Lever	49A	1341547	49A-SSV7500LC	Screw, Spool Clicker Spring (2 Required)
28B	1385546	28B-CLA3000	Compressing Spring (Damper)	52	1385582	52-CLA3000	Drag Knob Assembly
28C	1385547	28C-CLA3000	O-Ring	53S	1385583	53S-CLA3000	Seal, Drag Knob
28D	1385545	28D-CLA3000	Rotor Brake	56	1385584	56-CLA3000	Drag Friction Washer (2 Required)
31	1385548	31-CLA3000	Bail Arm Screw (2 Required)	57	1385586	57-CLA4000	Keyed Drag Washer (2 Required)
32	1385549	32-CLA3000	Compressing Bail Spring	63	1385587	63-CLA3000	Bushing, Main Shaft
34	1385550	34-CLA3000	Bail Arm	95B	1385647	95B-CLA2000	Rotor Nut Locking Plate
34C	1385551	34C-CLA3000	Lever, Bail Arm	98	1276966	98-SSV3500	One Way Clutch Bearing Assembly (A/R)
35	1276939	35-SSV3500	Line Roller	132	1277096	132-SSV5500	Line Roller Collar
35A	1385552	35A-CLA3000	Sealed Ball Bearing (Line Roller)	132A	1277097	132A-SSV5500	Line Roller Washer
36	1277061	36-SSV5500	Screw, Line Roller	226	1385590	226-CLA3000	Rear Cover
38	1385623	38-CLA2000	Rotor Nut	226A	1385591	226A-CLA3000	Screw, Rear Cover
38A	1385624	38A-CLA3000	Rotor Nut Lock Plate Screw	231	1385593	231-CLA4000	Oscillation (Crosswind) Gear
38D	1385555	38D-CLA3000	Rotor Washer	231A	1385595	231A-CLA3000	Bushing, Osc. (Crosswind) Gear
39	1385557	39-CLA4000	Main Shaft	231B	1385596	231B-CLA3000	Screw, Osc. (Crosswind) Gear
				231C	1385594	231C-CLA3000	Washer, Osc. (Crosswind) Gear
				231E	1385597	231E-CLA4000	Gear, Slow Oscillation (Crosswind)
				233A	1385598	233A-CLA3000	Handle Cap (Normally called 233)

### MYSTIC REEL PARTS REVISION!

#### NOTE:

Many of [www.mysticparts.com](http://www.mysticparts.com) schematics include changes that were either made by Penn, or errors found and corrected by our parts dept.

MRP Ver 040617 (Based on Penns Rev. 6 8-15-16)

**U.S. Handle**

15	1385506	15-CLA3000	Handle Assembly (Skinny Knob)
15E	1417805	15E-CLA3000	Handle Knob (Skinny Knob)
15L	1417804	15L-CLA2000	Handle Seal
24C	1417806	24C-CLA3000	Handle Knob Cap
35B	1418393	35B-CLA3000	Ball Bearing (2 Required)
46T	1341500	3-SSV7500LC	Screw, for Handle Knob

**Australian Handle**

15**	1385507	15-CLA3000AU **	Handle Assembly (Ball Knob) (AUSTRALIAN)
15E	1417807	15E-CLA3000AU	Handle Knob (Ball Knob)
15L	1417804	15L-CLA2000	Handle Seal
24C	1417808	24C-CLA3000AU	Handle Knob Cap
35B	1377606	35B-CLA3000AU	Ball Bearing (2 Required)
46T	1341500	3-SSV7500LC	Screw, for Handle Knob

**CHANGES/CORRECTIONS**

36B	1417809	36B-CLA6000	Bail arm Screw Washer (FORMERLY 36B-CLA5000)
-----	---------	-------------	--

**PAGE 3 OF 3**