

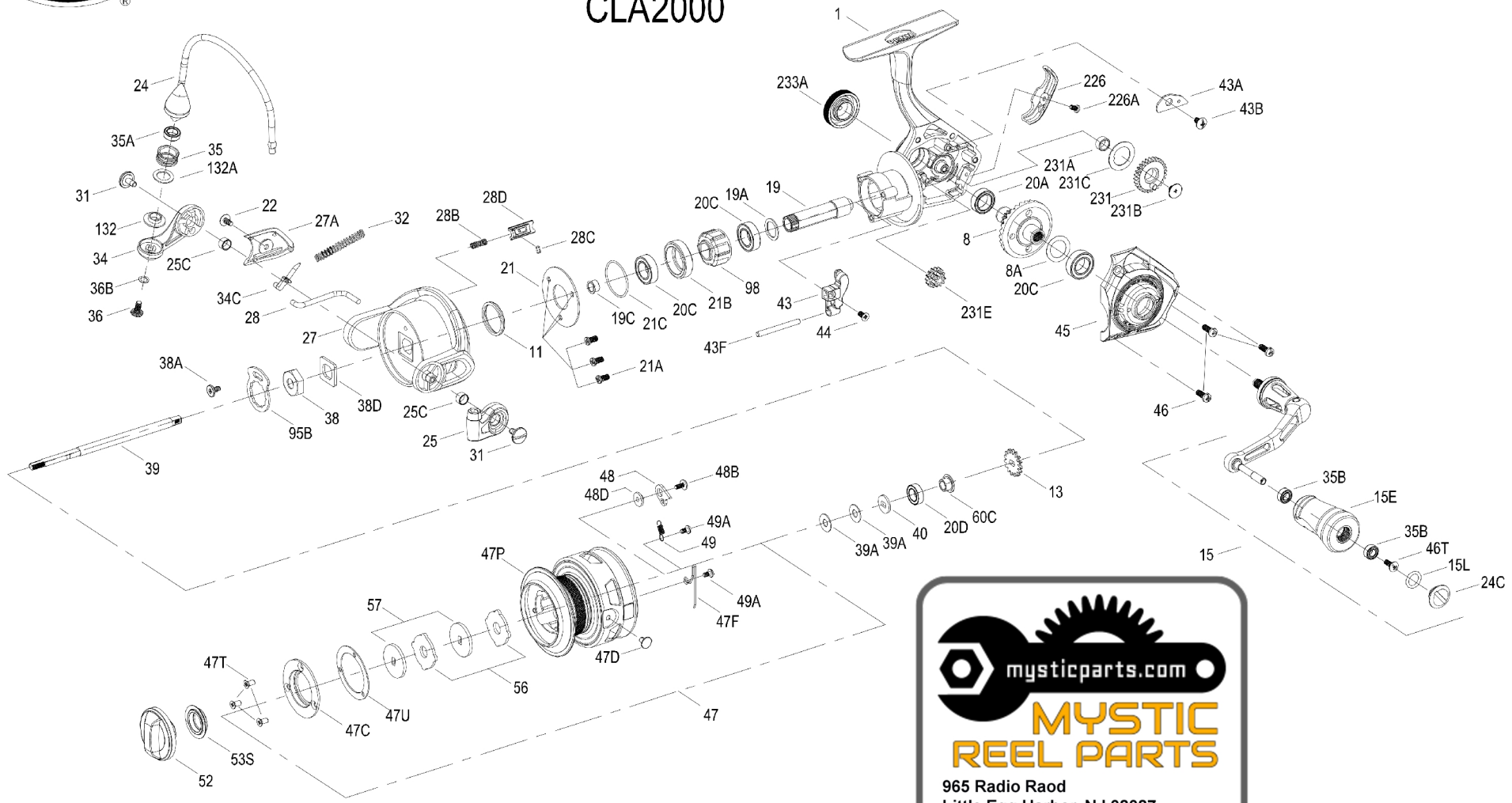

# PARTS LIST FOR MODEL CLASH 2000 CLA2000



**mysticparts.com**  
**MYSTIC REEL PARTS**  
 965 Radio Raod  
 Little Egg Harbor, NJ 08087  
 +1 (609) 296-1300  
 www.mysticparts.com  
 customerservice@mysticparts.com

**MRP VER 082816**  
 (Based on Penn's Rev. 2 8-15-16)

## Penn Reel Parts list for Model: CLA2000 Clash Spinning

<u>KEY #</u>	<u>PUREFISHING #</u>	<u>PENN PART #</u>	<u>DESCRIPTION</u>	<u>KEY #</u>	<u>PUREFISHING #</u>	<u>PENN PART #</u>	<u>DESCRIPTION</u>
1	1385599	1-CLA2000	Housing Body	39	1385625	39-CLA2000	Main Shaft
8	1385502	8-CLA3000	Main Drive Gear	39A	1385627	39A-CLA2000	Washer, Spool Adjusting (2 Required)
8A	1257352	8A-CLA2000	Drive Gear Shim	40	1252700	40-CLA2000	Washer, Main Shaft
11	1385504	11-CLA3000	Rotor Seal	43	1385629	43-CLA2000	Oscillation Slider (Crosswind Block)
13	1385600	13-CLA2000	Click Gear (Ratchet)	43A	1385630	43A-CLA2000	Slider Retainer Plate (Crosswind Block Plate)
15	1385601	15-CLA2000	Handle Assembly	43B	1277070	43B-SSV5500	Screw, Osc. Slider Guide
15E	1417803	15E-CLA2000	Handle Knob	43F	1385631	43F-CLA2000	Guide Shaft
15L	1417804	15L-CLA2000	Handle Seal	44	1126275	44-CLA2000	Screw, Crosswind Block
19	1385602	19-CLA2000	Pinion Gear	45	1385632	45-CLA2000	Body Cover
19A	1277424	19A-SSV3500	Pinion Gear Washer	46	1385633	46-CLA2000	Screw, Body Cover (3 Required)
19C	1385529	19C-CLA2000	Pinion Gear Bushing	46T	1341500	3-SSV7500LC	Screw, for Handle Knob
20A	1385530	20A-CLA3000	Sealed Ball Bearing (Housing)	47	1385634	47-CLA2000	Spool Assembly (Inc. Drags/Clicker)
20C	1385532	20C-CLA3000	Sealed Ball Bearing (Cover, Pinion)(3 Required)	47C	1385636	47C-CLA2000	Drag Cover
20D	1385604	20D-CLA2000	Sealed Ball Bearing (Shaft)	47D	1276953	47D-SSV3500	Line Hook
21	1385606	21-CLA2000	Retainer, For Ball Bearing	47F	1385637	47F-CLA2000	Line Clip Retainer
21A	1385607	21A-CLA2000	Screw, Bearing Retainer (3 Required)	47P	1385638	47P-CLA2000	Spool, Bare (usually n/a from Penn)
21B	1385608	21B-CLA2000	Bushing, Ball Bearing	47T	1389425	47T-CLA2000	Screw, Drag Cover (3 Required)
21C	1385605	21C-CLA2000	O-Ring	47U	1428241	47U-CLA2000	Drag Cover Seal
22	1092845	22-CLA2000	Screw, Roter Cover	48	1385578	48-CLA3000	Spool Click Plate
24	1385609	24-CLA2000	Bail Wire Assembly	48B	1385581	48B-CLA3000	Screw, Spool Clicker Spring
24C	1417806	24C-CLA3000	Handle Knob Cap	48D	1385579	48D-CLA3000	Spacer Ring, Spool Clicker
25	1385611	25-CLA2000	Bail Holder	49	1259579	49-7000AF	Pulling Spring (Clicker)
25C	1188261	25C-CLA2000	Bushing, Bail Holder (2 Required)	49A	1294638	49A-CLA2000	Screw, Spool Clicker Spring (2 Required)
27	1385612	27-CLA2000	Rotor	52	1385643	52-CLA2000	Drag Knob Assembly
27A	1385614	27A-CLA2000	Rotor Cover	53S	1385644	53S-CLA2000	Seal, Drag Knob
28	1385616	28-CLA2000	Rotor Trip Lever	56	1385645	56--CLA2000	Drag Friction Washer (2 Required)
28B	1346982	28B-CLA2000	Compressing Spring (Damper)	57	1385646	57-CLA2000	Keyed Drag Washer (2 Required)
28C	1206550	28C-CLA2000	O-Ring	60C	1385603	60C-CLA2000	Spool Support Sleeve
28D	1385618	28D-CLA2000	Rotor Brake	95B	1385647	95B-CLA2000	Rotor Nut Locking Plate
31	1385619	31-CLA2000	Bail Arm Screw (2 Required)	98	1257345	98-CLA2000	One Way Clutch Bearing Assembly (A/R)
32	1363787	32-CLA2000	Compressing Bail Spring	132	1385648	132-CLA2000	Line Roller Collar
34	1385620	34-CLA2000	Bail Arm	132A	1385649	132A-CLA2000	Line Roller Washer
34C	1385621	34C-CLA2000	Lever, Bail Arm	226	1385650	226-CLA2000	Rear Cover
35	1385622	35-CLA2000	Line Roller	226A	1385651	226A-CLA2000	Screw, Rear Cover
35A	1276940	35A-SSV3500	Sealed Ball Bearing (Line Roller)	231	1385652	231-CLA2000	Oscillation (Crosswind) Gear
35B	1418393	35B-CLA3000	Ball Bearing (2 Required)	231A	1385595	231A-CLA2000	Bushing, Osc. (Crosswind) Gear
36	1389419	36-CLA2000	Screw, Line Roller	231B	1307857	231B-SSV3500	Screw, Osc. (Crosswind) Gear
36B	1419265	36B-CLA2000	Bail arm Screw Washer	231C	1385594	231C-CLA2000	Washer, Osc. (Crosswind) Gear
38	1385623	38-CLA2000	Rotor Nut	231E	1385654	231E-CLA2000	Gear, Slow Oscillation (Crosswind)
38A	1385554	38A-CLA2000	Rotor Nut Lock Plate Screw	233A	1385598	233A-CLA2000	Handle Cap (Normally called 233)
38D	1385555	38D-CLA3000	Rotor Washer				

### MYSTIC REEL PARTS REVISION!

NOTE: Many of [www.mysticparts.com](http://www.mysticparts.com) schematics include changes that were either made by Penn, or errors found and corrected by our parts dept.

### MRP Ver 060318 (based on Penn's Rev. 5 2-1-13)

NOTE: Original schematic said the pinion bearings were 2 of 20B-3000, but Penn corrected this to 20C-CLA3000