

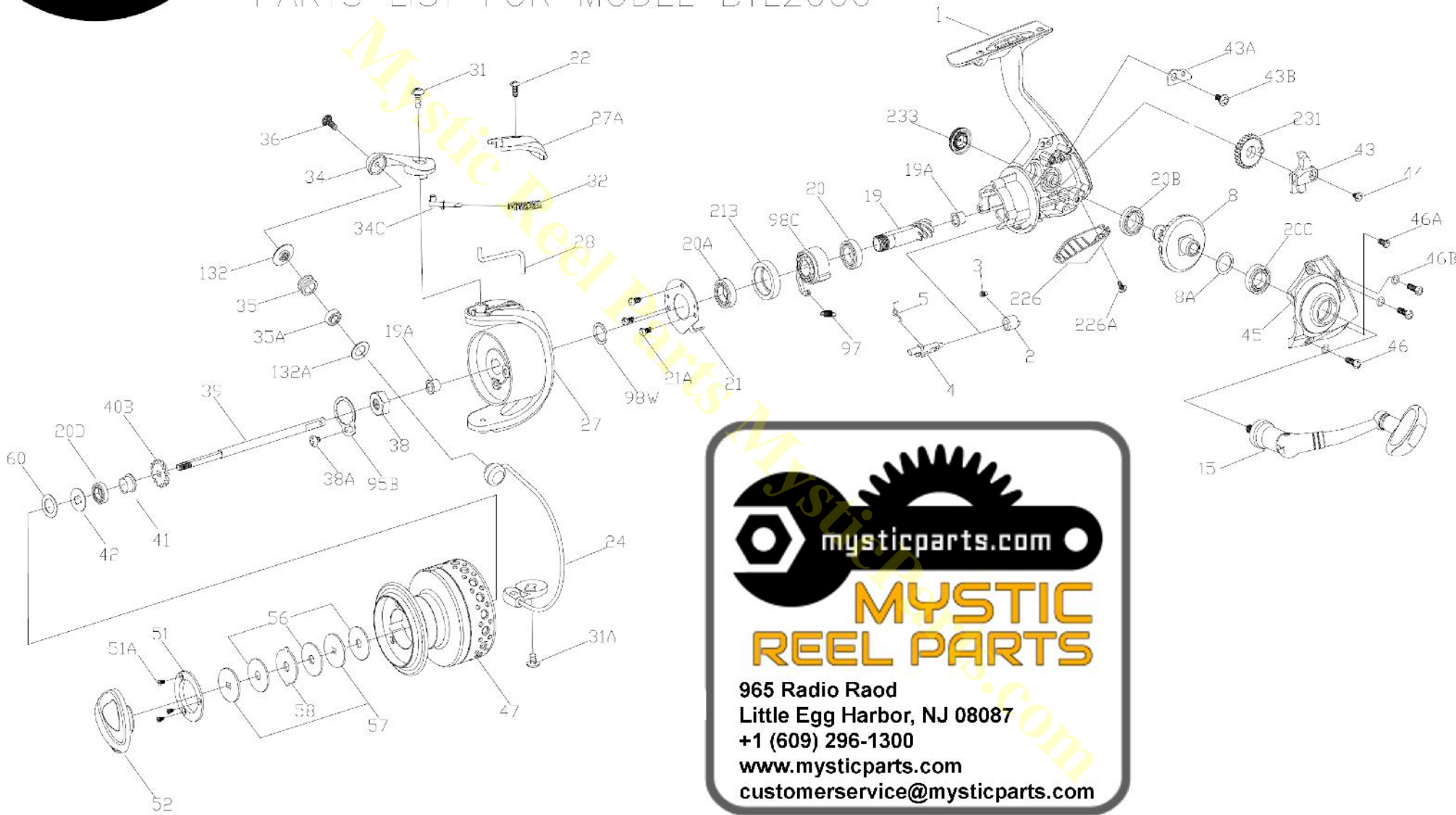

PARTS LIST FOR MODEL BTL2000



mysticparts.com

MYSTIC REEL PARTS

965 Radio Raod
Little Egg Harbor, NJ 08087
+1 (609) 296-1300
www.mysticparts.com
customerservice@mysticparts.com

MRP Ver. 120210

(based on Penn's 407-2000btl Rev. 1 4/21/10)

Penn Reel Parts list for:

Model: BTL2000 Battle Spinning Series

KEY NO	PUREFISHING NO.	PENN PART NO.	DESCRIPTION	KEY NO	PUREFISHING NO.	PENN PART NO.	DESCRIPTION
1	1211564	1-2000BTL	HOUSING	38A	1191734	38A-3000SG	ROTOR LOCKING PLATE SCREW
2	1190889	2-2000SG	A/R LEVER	39	1191743	39-2000SG	SPOOL SHAFT
3	1190922	3-2000SG	A/R LEVER SCREW	40B	1191778	40B-2000SG	CLICK RATCHET
4	1190935	4-2000SG	A/R SHAFT	41	1211573	41-2000BTL	SPOOL BUSHING
5	1190960	5-2000SG	A/R SPRING	42	1211574	42-2000BTL	SPOOL SHAFT WASHER
8	1191017	8-3000SG	MAIN GEAR ASSEMBLY	43	1191797	43-2000SG	CROSSWIND BLOCK
8A	1191028	8A-3000SG	MAIN GEAR SHIM	43A	1191817	43A-2000SG	CROSSWIND BLOCK PLATE
15	1211565	15-2000BTL	HANDLE ASSEMBLY	43B	1191826	43B-2000SG	CROSSWIND BLOCK PLATE SCREW
19	1191227	19-2000SG	PINION GEAR	44	1191843	44-3000SG	CROSSWIND BLOCK SCREW
19A	1211566	19A-2000BTL	PINION BUSHING (2 REQUIRED)	45	1211576	45-2000BTL	HOUSING COVER
20	1192610	20-2000SG	LOWER PINION BALL BEARING	46	1191901	46-3000SG	HOUSING COVER SCREW (3 REQUIRED)
20A	1192616	20A-2000SG	UPPER PINION BALL BEARING	46A	1191906	46A-3000SG	HOUSING COVER SCREW A
20B	1192619	20B-3000SG	HOUSING BALL BEARING	46B	1191907	46B-3000SG	HOUSING COVER WASHER (3 REQUIRED)
20C	1192622	20C-3000SG	HOUSING COVER BALL BEARING	47	1211577	47-2000BTL	SPOOL ASSEMBLY
20D	1211567	20D-2000BTL	HOUSING COVER BALL BEARING	51	1211578	51-2000BTL	RETAINING SPACER
21	1192629	21-2000SG	BEARING RETAINER	51A	1191986	51A-3000SG	RETAINING SCREW (3 REQUIRED)
21A	1192644	21A-3000SG	BEARING RETAINER SCREW (3 REQUIRED)	52	1211579	52-2000BTL	DRAG KNOB
21B	1192656	21B-2000SG	COLLAR	56	1211580	56-2000BTL	DRAG WASHER HT100 (3 REQUIRED)
22	1192658	22-2000SG	BAIL ARM COVER SCREW	57	1192041	57-2000SG	KEYED DRAG WASHER (2 REQUIRED)
24	1211569	24-2000BTL	BAIL WIRE	58	1192049	58-2000SG	EARRED DRAG WASHER
27	1211570	27-2000BTL	ROTOR CUP	60	1211581	60-2000BTL	THRUST WASHER
27A	1191441	27A-2000SG	BAIL PIVOT COVER	95B	1192185	95B-3000SG	ROTOR LOCKING PLATE
28	1191477	28-2000SG	TRIP LEVER	97	1192189	97-2000SG	CLUTCH SPRING
31	1191566	31-2000SG	BAIL ARM SCREW	98C	1192211	98C-2000SG	CLUTCH/SLEEVE ASSEMBLY
31A	1191574	31A-3000SG	BAIL CAM SCREW	98W	1192228	98W-2000SG	CLUTCH WASHER
32	1211571	32-2000BTL	BAIL SPRING	132	1211582	132-3000BTL	ROLLER WASHER
34	1191625	34-2000SG	BAIL ARM	132A	1192301	132A-2000SG	LINE ROLLER WASHER
34C	1191648	34C-2000SG	PIVOT ARM	226	1211583	226-2000BTL	REAR COVER
35	1211572	35-3000BTL	LINE ROLLER	226A	1192473	226A-3000SG	REAR COVER SCREW
35A	1191682	35A-2000SG	LINE ROLLER BEARING	231	1192496	231-2000SG	CROSSWIND GEAR
36	1211597	36-3000BTL	BAIL PIVOT COVER SCREW	233	1211584	233-2000BTL	BEARING COVER
38	1191727	38-2000SG	ROTOR NUT				

MYSTIC REEL PARTS REVISION!

NOTE:

Many of www.mysticparts.com schematics include changes that were either made by Penn, or errors found and corrected by our parts dept.

MRP Ver. 120210 (based on Penn's 407-2000btl Rev. 1 4/21/10)