

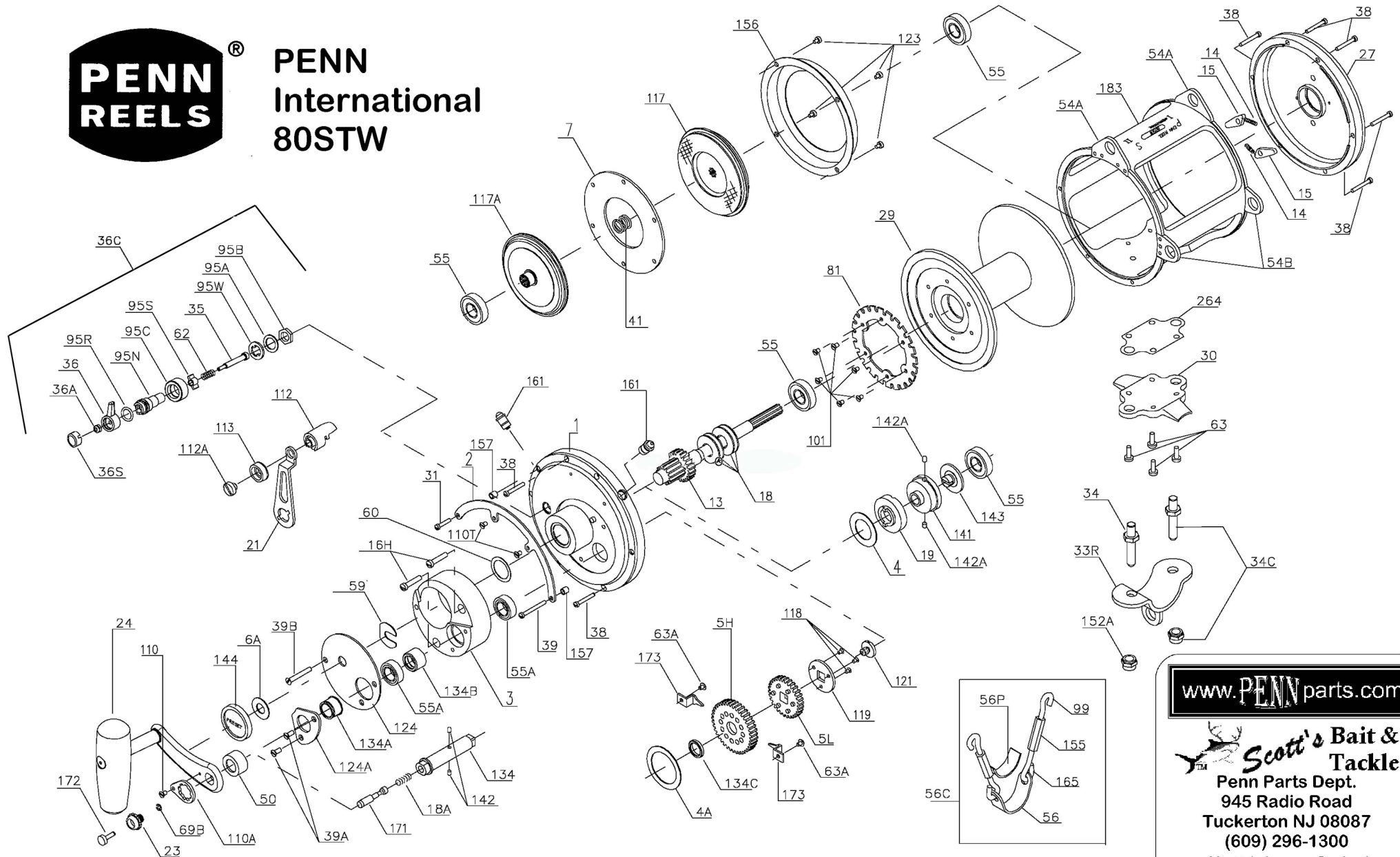

PENN International 80STW



SBT Version 122910

www.PENNparts.com

Scott's Bait & Tackle

Penn Parts Dept.
945 Radio Road
Tuckerton NJ 08087
(609) 296-1300

No Minimum Order!
Plus, Parts in stock
that Penn doesn't
carry anymore.

Penn Reel Parts list for:

Model: 80STW

KEY NO	PART NO.	DESCRIPTION	KEY NO	PART NO.	DESCRIPTION
1	1N-80ST	RIGHT SIDE PLATE ASSEMBLY	69	69-50	LOCATING PIN (2 REQ.)
2	2-80	QUADRANT RING	69B	69B-50	RETAINING RING (3 REQ.)
3	3-80ST	BRIDGE	81	81-80S	RATCHET
4	4-50	CAM THRUST WASHER (OLD #4-80)	95A	95A-20	CLICK BUSHING WASHER
4A	4-130	GEAR THRUST WASHER	95B	38-710	CLICK BUSHING NUT
5H	5-80HST	MAIN GEAR HIGH-SPEED	95C	95C-80ST	CLICK ADJUSTMENT RING
5L	5-80LST	MAIN GEAR LOW-SPEED	95N	95N-80ST	CLICK TONGUE BUSHING
6A	6-155	SPACER WASHER	95R	95R-80ST	CLICK O-RING
7	7A-80	METAL DRAG WASHER	95S	95S-80ST	CLICK SPRING SLIDER
13	13-80STW	PINION GEAR	95W	95W-80ST	EARRED SPRING WASHER
14	49-710	DOG SPRING (2 REQ.)	99	99-116	HARNESS SCREW HOOK (UPPER) (2REQ.)
15	15-130	DOG (2 REQ.)	101	101-30	RATCHET SCREW (6 REQ.)
16H	16T-130	HIDDEN BRIDGE SCREWS (2 REQ.)	110	110-50	HANDLE LOCK SCREW
18	18-80W	DISC CLUTCH SPRING (4 REQ.)	110A	110A-50	HANDLE LOCKING PLATE
18A	18-349	GEAR STUD SPRING	110T	110T-50	QUADRANT SCREW (2 REQ.)
19	19H-80	ECCENTRIC CAM	112	112-50	ECCENTRIC LEVER KNOB
21	21-80ST	ECCENTRIC LEVER	112A	112A-50	ECCENTRIC KNOB SCREW
23	23-80ST	HANDLE SCREW	113	113-50	ECCENTRIC LEVER CAP
24	24-80ST	HANDLE COMPLETE	117	117N-80ST	DRIVE PLATE (OUTER)
27	27-80ST	L.S. PLATE ASSEMBLY	117A	117AN-80T	DRIVE PLATE (INNER)
29L	29L-80SW	SPOOL	118	101-80ST	COUPLING PLATE SCREW (3 REQ.)
30	30-80S	STAND	119	119-80ST	COUPLING PLATE
31	31T-20	SHORT QUADRANT SCREW	121	121-80ST	GEAR STUD SCREW
33R	33-130ST	ROD CLAMP	123	123-50	DRAG COVER SCREW (4REQ.)
34	34-80T	CLAMP SCREW (2 REQ.)	124	124-80ST	BRIDGE COVER
34C	34C-80T	ROD CLAMP SCREW W/NUT	124A	124A-80ST	BEARING COVER
35	35-80ST	CLICK TONGUE	*	125-80ST	CAM HOUSING
36	36-80ST	CLICK BUTTON	*	128-80ST	PIN - 5 COME WITH 5-80LST AS OF 1/22/04
36A	36-700	CLICK BUTTON NUT	134N	134N-80ST	GEAR STUD
36S	36S-80STW	CLICK BUTTON CAP	134A	134A-80ST	BUSHING
38	38T-50	FRAME SCREW	134B	134B-80ST	GROOVED SPACER BUSHING
39	39-50	LONG QUADRANT SCREW	134C	134C-80ST	GEAR BUSHING
39A	39A-80S	COVER SCREWS (2 REQ.)	141	141-80	CAM FOLLOWER
39B	39-80ST	COVER SCREW	142	142-50	GEAR STUD PIN (2 REQ.)
41	41-50	L.S. BEARING SPRING	142A	142-80ST	CAM FOLLOWER PINS (2 REQ.)
50	50-80ST	SHIELD	143	143-80	ADJUSTING SCREW
54A	54A-80S	TOP HARNESS LUG (2 REQ.)	144	144-50	PRESET KNOB
54B	54B-80S	HARNESS LUG (2 REQ.)	152A	152A-80T	ROD CLAMP ACORN NUT
55	55-80	BALL BEARING (4 REQ.)	155	155-116	TURNBUCKLE (2 REQ.)
55A	55-80ST	BALL BEARING (2 REQ.)	156	156-80S	DRAG COVER
56	56-116	ROD BRACE	157	157-50	QUADRANT SPACER BUSHING (2 REQ.)
56C	56C-80ST	ROD BRACE ASSEMBLY (COMPLETE)	161	161-50	LOCATING PIN BUSHING (2 REQ.)
59	59-50	SLOTTED WASHER	162	162-50	LOCATING PIN SPRING (2 REQ.)
60	60-50	BACKING WASHER	165	165-116	HARNESS SCREW HOOK (LOWER) (2 REQ.)
62	62-50	CLICK SPRING	171	171-80ST	PLUNGER
63	63-30T	STAND SCREWS (4 REQ.)	172	172N-80S	PLUNGER CAP
63A	63-349	HOLD DOWN SCREW (4 REQ.)	173	173-50S	GEAR RETAINER
			183	183-80STW	TUBE FRAME
			264	264-80T	STAND GASKET

*NOT SHOWN

NOTE: Many of www.pennparts.com schematics include changes that were either made by Penn, or errors found and corrected by our parts dept.
SBT Version 122910

*154 154-80 Shim, Spool Shaft