

# Penn Schematic 705Z

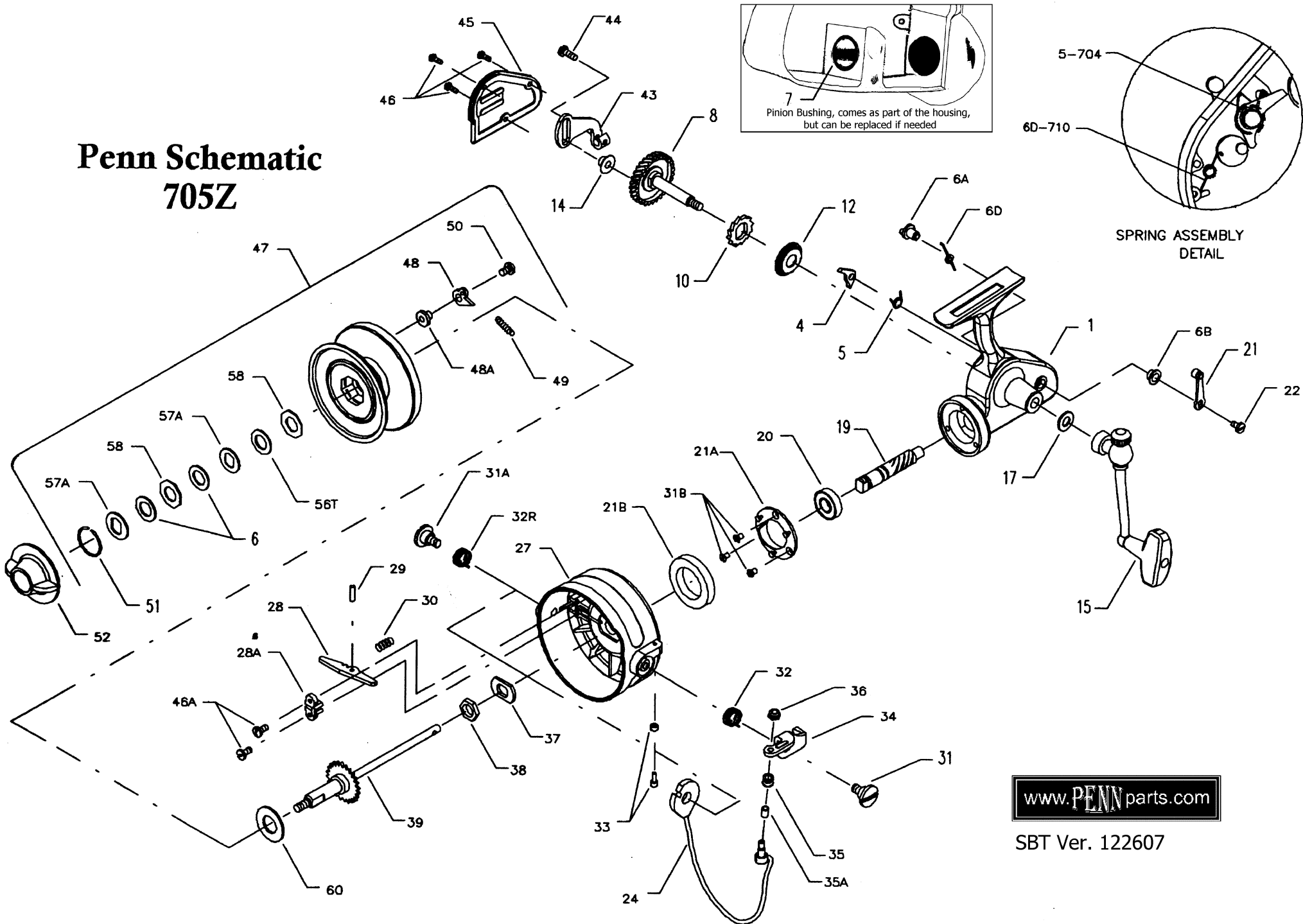

[www.PENNparts.com](http://www.PENNparts.com)

SBT Ver. 122607

## Penn Reel Parts list for:

Model: 705Z

KEY PART			KEY PART		
NO	NO.	DESCRIPTION	NO	NO.	DESCRIPTION
1	1-705Z	HOUSING W/BUSHING	32	32-704	BAIL SPRING
4	4-704	DOG	32R	32R-704	SECONDARY BAIL SPRING
5	5-705Z	DOG SPRING	33	33-704	BUMPER
6	6-60	DRAG WASHER-HT 100 (2 REQ.)	34	34-704	BAIL ARM
6A	6A-704	ECCENTRIC	35	35-704	LINE ROLLER
6B	6B-700Z	ECCENTRIC LINER	35A	35A-704	ROLLER SLEEVE
6D	6D-710	ECCENTRIC SPRING	36	36-700	BAIL LOCK NUT
8	8-705Z	MAIN GEAR W/RATCHET	37	37-704	ROTOR CUP WASHER
10	10-704	RATCHET	38	38-704	ROTOR CUP NUT
12	12-704	MAIN GEAR THRUST WASHER	39	39-704	SPOOL SHAFT
14	14-710	CROSSWIND ROLLER	43	43-705Z	CROSSWIND ARM
15	15-705Z	HANDLE (COMPLETE)	44	44-704	CROSSWIND SCREW
17	17-710	HANDLE WASHER	45	45-705Z	HOUSING PLATE
19	19-704	PINION GEAR	46	46A-704	HOUSING PLATE SCREW (3 REQ.)
20	20-704	PINION BEARING	46A	46A-704	RETAINING SCREW (2 REQ.)
21	21-109	ECCENTRIC	47	47-704	SPOOL (COMPLETE)
21A	21-704	BEARING RETAINER	48	48-450	CLICK TONGUE
21B	21B-704	ROTOR BRAKE	48A	48A-750	CLICK TONGUE WASHER
22	22-109	ECCENTRIC SCREW	49	49-710	CLICK SPRING
24	24-704	BAIL WIRE	50	22-750	CLICK SCREW
27	27-704	ROTOR CUP	51	51-704	RETAINING SCREW
28	28-704	BAIL RELEASE ARM	52	52-750	DRAG KNOB
28A	28A-704	BAIL RELEASE SADDLE	56T	56T-704	DRAG WASHER TEFLON
29	29-704	BAIL RELEASE PIN	57A	57A-750	METAL KEYED WASHER (2 REQ.)
30	30-704	BAIL RELEASE SPRING	58	58-704	METAL WASHER (OCTAGON) (2 REQ.)
31	31-704	BAIL ARM SCREW (2-REQ.)	60	60-710	REAR DRAG WASHER (TEFLON)
31B	31-19	BEARING COVER SCREW (3 REQ)			

NOTE: Many of [www.pennparts.com](http://www.pennparts.com) schematics include changes that were either made by Penn, or errors found and corrected by our parts dept.

705Z is the black/gold cosmetics

705 was the older version that came in green, blue, brown or black

All parts are interchangeable