

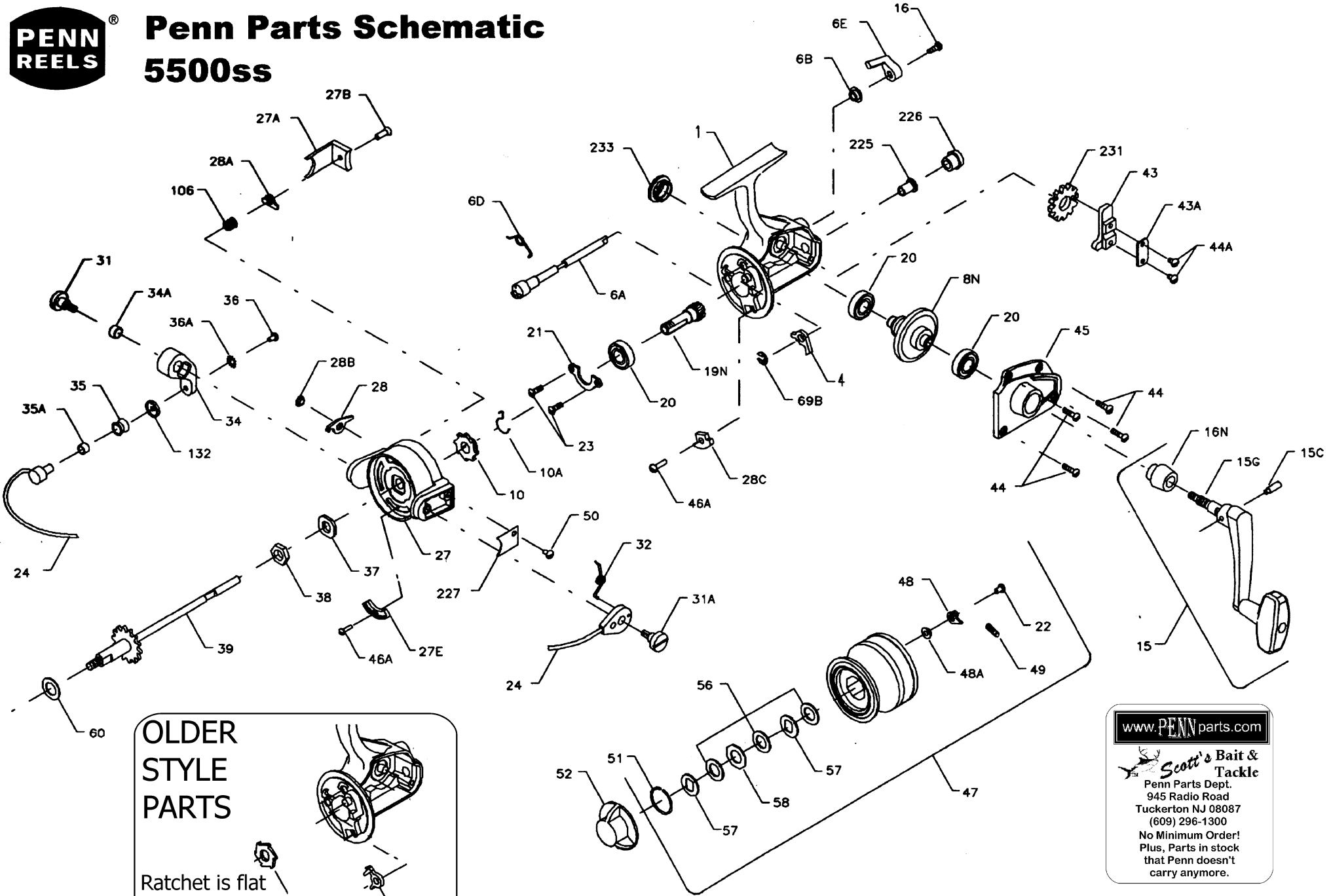

Penn Parts Schematic 5500ss



**OLDER
STYLE
PARTS**

Ratchet is flat

Dog has
spring fingers

www.PENNparts.com

Scott's Bait & Tackle
 Penn Parts Dept.
 945 Radio Road
 Tuckerton NJ 08087
 (609) 296-1300
 No Minimum Order!
 Plus, Parts in stock
 that Penn doesn't
 carry anymore.

SBT Ver. 052512

Penn Reel Parts list for:

Model: 5500SS

KEY PART			KEY PART		
NO	NO.	DESCRIPTION	NO	NO.	DESCRIPTION
6A	6A-450	ECCENTRIC	35A	35A-704	LINE ROLLER BUSHING
6B	6B-750	ECCENTRIC LINER	36	36-750	BAIL STUD SCREW
6D	6D-710	ECCENTRIC SPRING	36A	36A-750	LOCK WASHER
6E	6E-750	ECCENTRIC LEVER	37	37-450	ROTOR WASHER
15	15-5500	HANDLE (COMPLETE)	38	38-550	ROTOR NUT
15C	15C-650	HANDLE PIVOT SCREW	39	39N-5500	SPOOL SHAFT
15G	15G-5500	HANDLE PIVOT	43A	43A-550	CROSSWIND BLOCK PLATE
16	16-910	ECCENTRIC SCREW	44	44-704	COVER SCREW (4 REQ.)
16N	16-5500	HANDLE COLLAR	44A	22-750	CROSSWIND BLOCK SCREW (2 4REQ.)
19A	19A-550	PINION SPACER	45	45-5500	HOUSING COVER
19N	19N-5500	PINION	46A	46A-704	SCREW (2 REQ.)
20	20-722	BALL BEARING	47	47-5500	SPOOL (COMPLETE)
21	21-450	BEARING COVER	48	48-750	CLICK TONGUE
22	22-750	SPOOL CLICK SCREW	48A	48A-750	CLICK TONGUE WASHER
23	23-750	BERING COVER SCREW (2 REQ.)	49	49-710	CLICK TONGUE SPRING
24	24-5500	BAIL WIRE	50	50-712	BAIL SPRING COVER SCREW
27	27-5500	ROTOR	51	51-710	RETAINING RING
27A	27A-5500	BAIL TRIP COVER	52	52-550	DRAG KNOB
27B	27B-420	ROTOR END SCREW	56	56-710	DRAG WASHER-HT 100 (3 REQ.)
27E	27E-5500	BALANCE WEIGHT	57	57-710	METAL KEYED WASHER (2 REQ.)
28	28-5500	TRIP LEVER	58	58-710	METAL WASHER (OCTAGON)
28A	28A-440	CAM LEVER	60	60-550	THRUST WASHER (TEFLON)
28B	28B-5500	TRIP LEVER BUSHING	69B	69B-4400	RETAINING RING
28C	28C-440	TRIP CAM	106	106-5500	ROTOR END SPRING
31	31-550	BAIL ARM SCREW	132	132-450	ROLLER WASHER
31A	31A-450	TRIP ARM SCREW	225	225-5500	CROSSWIND SHAFT BUSHING
32	32-440	BAIL SPRING	226	226-5500	BUSHING CAP SCREW
34	34-450	BAIL ARM	227	227-440	BAIL SRPING
34A	34A-550	BAIL ARM BUSHING	233	233-440	BERING COVER
35	35-704	LINE ROLLER	**	300-5500	POWER HANDLE

**NOT SHOWN

NOTE: Many of www.pennparts.com schematics include changes that were either made by Penn, or errors found and corrected by our parts dept.

SBT Ver. 052512

OLDER SYSTEM

1	1-5500 Housing (original)
4	4-450 Dog (old style with spring fingers)
8N	8-5500 Main Gear
10	10-440 Ratchet (flat)
19N	19-5500 Pinion
43	43-5500 Crosswind Block (original)
231	231-4500 Crosswind Gear (original)

INTERMEDIATE SYSTEM

1	1N-5500 Housing (intermediate)
4	4N-4400 DOG (has slot for the 230N spring to sit in)
10A	230N-5500 Anti-Reverse Spring
8N	8N-5500 Main Gear
10	10N-4400 Ratchet (has groove for spring to wrap around)
19N	19N-5500 Pinion
43	43-5500 Crosswind Block (original)
69B	69B-4400 C-Clip (fits on groove on the dog post)
231	231-4500 Crosswind Gear (original)

NEWER SYSTEM

1	1P-5500 Housing (Newer)
4	4N-4400 DOG (has slot for the 230N spring to sit in)
10A	230N-5500 Anti-Reverse Spring
8N	8N-5500 Main Gear
10	10N-4400 Ratchet (has groove for spring to wrap around)
19N	19N-5500 Pinion
43	43N-5500 Crosswind Block (newer)
69B	69B-4400 C-Clip (fits on groove on the dog post)
231	231N-4500 Crosswind Gear (newer)

Dog type and housing # (stamped inside under main gear) are the best way to identify which version.