

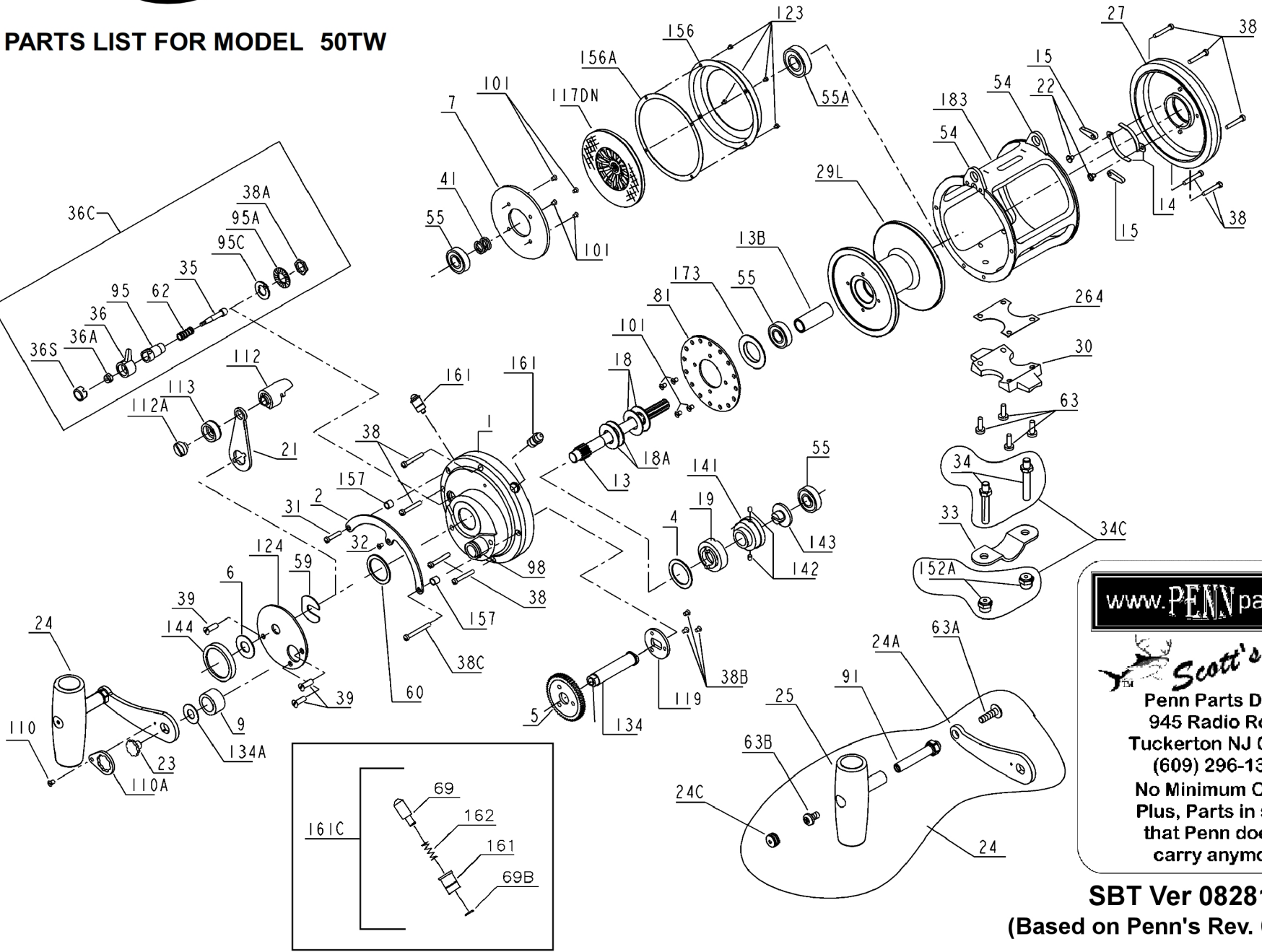

# PARTS LIST FOR MODEL 50TW



[www.PENNparts.com](http://www.PENNparts.com)

**Scott's Bait & Tackle**  
Penn Parts Dept.  
945 Radio Road  
Tuckerton NJ 08087  
(609) 296-1300  
No Minimum Order!  
Plus, Parts in stock  
that Penn doesn't  
carry anymore.

**SBT Ver 082816**  
(Based on Penn's Rev. 6 7-21-04)

## Penn Reel Parts list for Model: 50TW

KEY	PART	DESCRIPTION
NO	NO.	
2	2-50	QUADRANT RING
4	4-50	CAM THRUST WASHER
5	5-50W	MAIN GEAR
6	6-155	SPACER WASHER
7	7-50	FLOATING DRAG WASHER
9	9-30	SPACING SLEEVE
13	13-50W	PINION GEAR
13B	13B-50TW	SPOOL SLEEVE
14	14-50	DOG SPRING (2 REQ.)
15	15-50	DOG (2 REQ.)
18	18-50W	DISC CLUTCH SPRING (2 REQ.)
18A	18-50TW	DISC CLUTCH SPRING (2 REQ.)
19	19-50W	ECCENTRIC CAM
21	21-50	ECCENTRIC LEVER
22	22-109	DOG SPRING SCREW
23	23-114	HANDLE SCREW
24	24-50T	HANDLE COMPLETE
24C	24C-50	HANDLE KNOB CAP
25	25-50	HANDLE KNOB
27	27-50T	L.S. PLATE ASSEMBLY
29L	29L-50TW	SPOOL
30	30-50T	STAND
31	31T-20	SHORT QUADRANT SCREW
32	32-14CH	CENTER QUADRANT SCREW
33	33-114	ROD CLAMP
*	33R-114	RINGED ROD CLAMP (OPTIONAL)
34	34-50T	CLAMP SCREW (2 REQ.)
34C	34C-50T	ROD CLAMP SCREW W/NUT
36A	36-700	CLICK BUTTON NUT
36S	36S-80ST	CLICK BUTTON CAP
38	38T-50	FRAME SCREW (9 REQ.) (38-50) (T=TORQ)
38A	38-710	CLICK BUSHING NUT

## INTERNATIONAL II SPEED

KEY	PART	DESCRIPTION
NO	NO.	
38B	38-7	COUPLING PLATE SCREW (3 REQ.)
38C	38-80	QUADRANT SCREW
41	41-50	L.S. BEARING SPRING
*	46A-704	CAM HOUSING SCREW (2 REQ)
54	54-50T	HARNESS LUG (2 REQ.)
55	55-50	BALL BEARING (3 REQ.)
55A	55-80	BALL BEARING (1 REQ.)
59	59-50	SLOTTED WASHER
60	60-50	BACKING WASHER
62	62-50	CLICK SPRING
63	63-30T	STAND SCREWS (4 REQ.)
63A	63A-50	LONG SCREW
63B	63-50	SCREW
69B	69B-50	RETAINING RING
81	81-50	RATCHET
91	91N-50	HANDLE RIVET
95	95-50	CLICK TONGUE BUSHING
95A	95A-20	CLICK BUSHING WASHER
95B	95A-50	CLICK BUSHING WASHER
101	101-30	RATCHET PLATE SCREW (4 REQ.)
110	110-50	HANDLE LOCK SCREW
110A	110A-50	HANDLE LOCKING PLATE
112	112-50	ECCENTRIC LEVER KNOB
112A	112A-50	ECCENTRIC KNOB SCREW
113	113-50	ECCENTRIC LEVER CAP
117	117DN-50	OUTER DRIVE PLATE ASSEMBLY
119	119-50	COUPLING PLATE
123	123-50	DRAG COVER SCREW (4REQ.)
124	125-50S	CAM HOUSING
*	124-50	BRIDGE COVER
*	125-50	CAM HOUSING

134	134-50	GEAR STUD	156A	156A-50	DRAG COVER SEAL
134	134A-50	GEAR STUD WASHER	157	157-50	QUADRANT SPACER BUSHING (2 REQ.)
141	141-50	CAM FOLLOWER	173	173-50T	SPOOL BUSHING
142	142-50	CAM FOLLOWER PIN (2 REQ.)	183	183-50TW	TUBE FRAME
143	143-50	ADJUSTING SCREW	264	264-30T	STAND GASKET
144	144-50	PRESET KNOB	<i>*NOT SHOWN</i>		
152A	152A-50T	ROD CLAMP ACORN NUT (2 REQ.)			
*	154-50	SHIM, SPOOL SHAFT			
156	156-50	DRAG COVER			

NOTE: Many of www.pennparts.com schematics include changes that were either made by Penn, or errors found and corrected by our parts dept.  
 SBT Ver. 082816 (Based on Penn's Rev 6 7-21-04)

**OLDER DESIGN**

1	1-50T	RIGHT SIDE PLATE ASSEMBLY
*	3-50	BRIDGE
35	35-50	CLICK TONGUE
36	36-50	CLICK BUTTON
---	---	---
39A	39-50	COVER SCREW (3 REQ.)
98	98-50T	BRIDGE BUSHING

**NEWER DESIGN**

1	1-50TN	RIGHT SIDE PLATE ASSEMBLY (BRIDGE NOW PART OF PLATE)
35	35-50N	CLICK TONGUE
36	36N-50	CLICK BUTTON
*	36C-50	CLICK BUTTON COMPLETE ASSEMBLY
39A	39A-80S	COVER SCREW (3 REQ.)
98	98-50TN	BRIDGE BUSHING

**NOTES:** Key 39A cover screws are a different length due to plate differences  
 The 36C-50 click button assembly can be used on the older plates  
 There are photos of the plates and clicker parts in the www.pennparts.com website for comparison

**OLD INDIVIDUAL PARTS:**

69	69-50	LOCATING PIN (2 REQ.)
69B	69B-50	RETAINING RING (2 REQ.)
161	161-50	LOCATING PIN BUSHING (2 REQ.)
162	162-50	LOCATING PIN SPRING (2 REQ.)

**MERGED INTO ONE UNIT:**

161C	161C-50	LOCATING PIN BUSHING ASSEMBLY (2 REQ.)
------	---------	--