

# SLAMMER 260

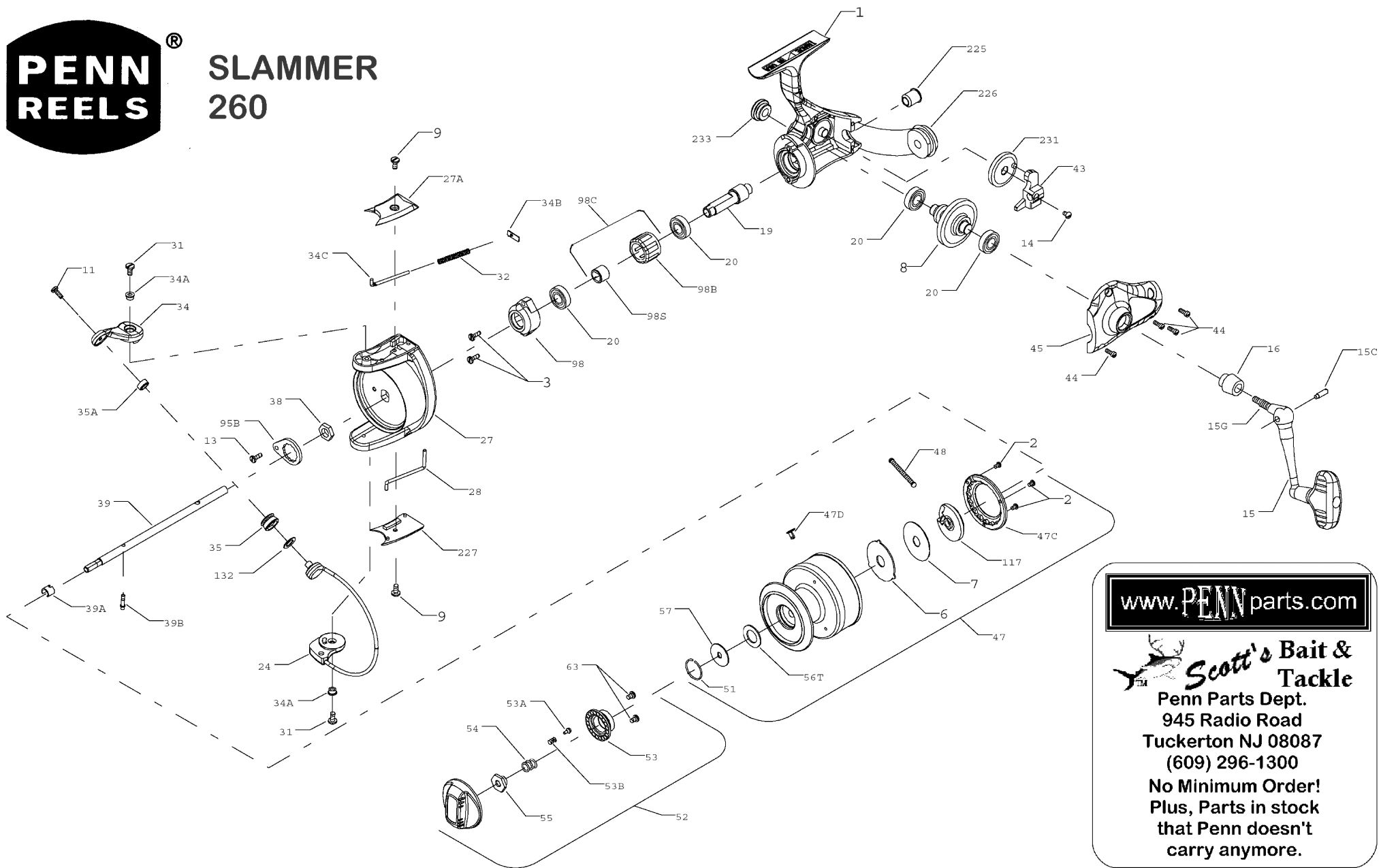

[www.PENNparts.com](http://www.PENNparts.com)

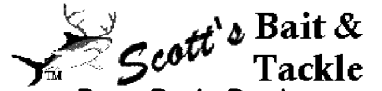

**Penn Parts Dept.**  
945 Radio Road  
Tuckerton NJ 08087  
(609) 296-1300

**No Minimum Order!**  
Plus, Parts in stock  
that Penn doesn't  
carry anymore.

## Penn Reel Parts list for:

Model: 260

KEY PART			KEY PART		
NO	NO.	DESCRIPTION	NO	NO.	DESCRIPTION
1	1-260	HOUSING	39B	39B-260	LOCATING PIN
2	44-5600	SCREW (3 REQ.)	43	43-260	CROSSWIND BLOCK
3	44-710	SCREW (2 REQ.)	44	46-260	SCREW (4 REQ.)
6	56-440	MAIN DRAG WASHER HT-100	45	45-260	HOUSING COVER
7	57-716	MAIN KEYED DRAG WASHER	47	47-260	SPOOL (COMPLETE)
8	8-260	GEAR	47C	47C-260	DRAG COVER
9	22-750	SCREW (2 REQ.)	47D	47D-5600	LINE CLIP
11	36-5600	SCREW	48	48-260	CLICK TONGUE
13	63A-2.5FR	SCREW	51	51-650	RETAINING RING
14	44-260	SCREW	52	52-260	DRAG KNOB (COMPLETE)
15	15-260	HANDLE	53	53-5600	DRAG KNOB INSERT
15C	15C-650	PIVOT SCREW	53A	53A-5600	DRAG KNOB CLICK PIN
15G	15G-260	HANDLE PIVOT	53B	53B-5600	DRAG KNOB CLICK SPRING
16	16-260	COLLAR	54	54-440	DRAG SPRING
19	19-260	PINION	55	55-550	DRAG KNOB NUT
20	20-260	BALL BEARING (4 REQ.)	56T	56T-650	DRAG WASHER (TEFLON)
24	24-260	BAIL WIRE	57	57-5600	DRAG WASHER (KEYED)
27	27-260	ROTOR CUP	63	52A-260	SCREW (2 REQ.)
27A	27A-260	BAIL PIVOT COVER	95B	95B-70	ROTOR LOCKING PLATE
28	28-360	TRIP LEVER	98	98-260	CLUTCH RETAINER
31	36-750	SCREW (2 REQ.)	98C	98C-360	CLUTCH BEARING ASSEMBLY
32	32-260	BAIL SPRING			***ASSEMBLY REPLACES 98B and 98S***
34	34-260	BAIL ARM	98B	98B-360	BEARING
34A	34A-5600	ROTOR BUSHING (2 REQ.)	98S	98S-360	CLUTCH BEARING SLEEVE
34B	34B-5600	PIVOT PLATE	117	117-260	DRIVE PLATE
34C	34C-260	PIVOT ARM	132	132-5600	LINE ROLLER WASHER
35	35-5600	LINE ROLLAR	225	225-260	CROSSWIND SHAFT BUSHING
35A	35A-706	BALL BEARING	226	226-260	REAR CAP
38	38-550	ROTOR NUT	227	227-260	BAIL TRIP COVER
39	39-260	SPOOL SHAFT	231	231-260	CROSSWIND GEAR
39A	39A-260	LOCATING PIN CLIP	233	233-560	BEARING COVER

NOTE: Many of [www.pennparts.com](http://www.pennparts.com) schematics include changes that were either made by Penn, or errors found and corrected by our parts dept.

SBT Ver. 051708