

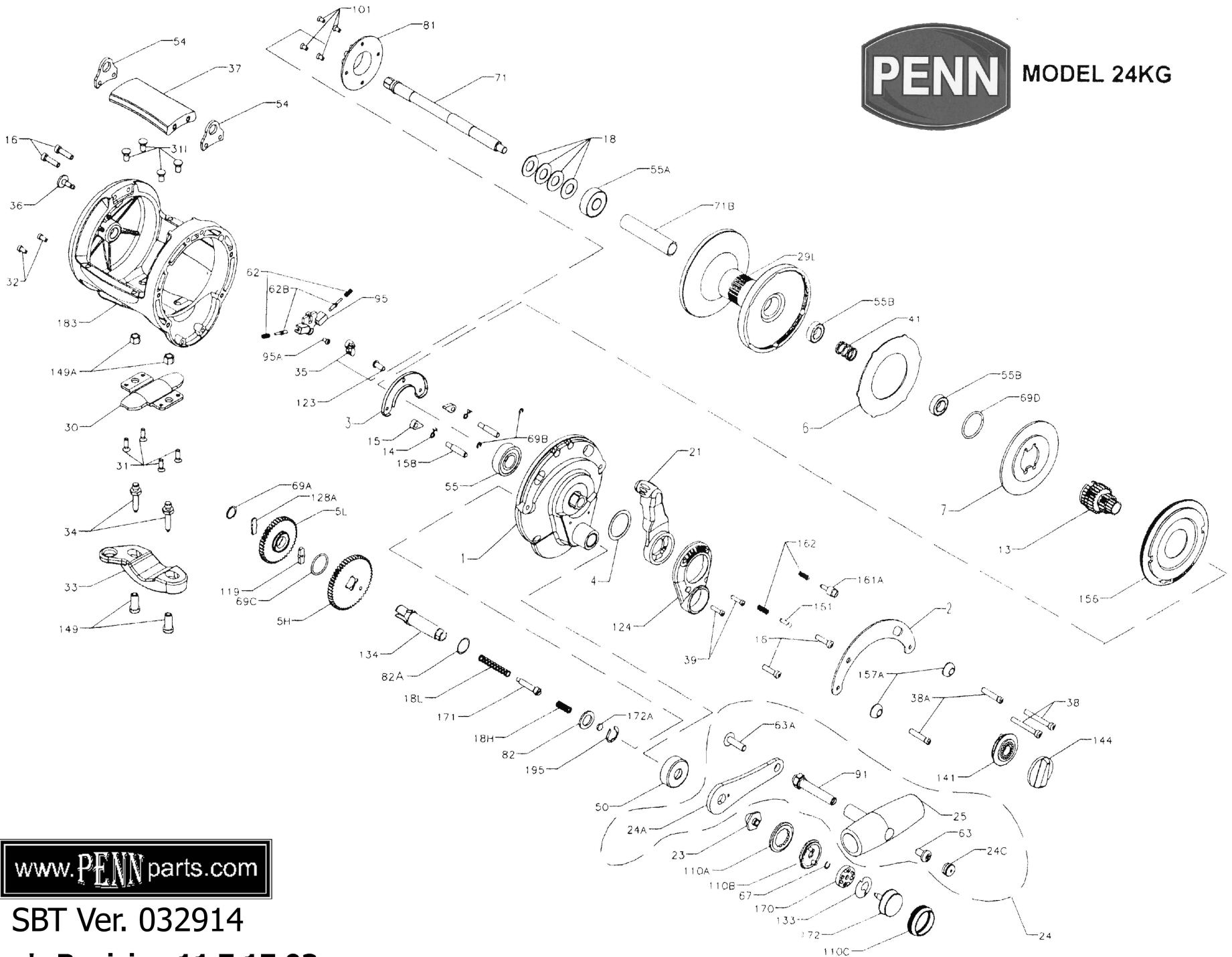

MODEL 24KG



www.PENNparts.com

SBT Ver. 032914

Penn's Revision 11 7.17.03

Penn Reel Parts list for Model: 24KG, Penn Version 11

KEY NO.	PART NO.	DESCRIPTION	KEY NO.	PART NO.	DESCRIPTION
1	1-24KG	RIGHT SIDE PLATE ASSEMBLY	55B	55-12H	BEARING (2 REQ)
2	2-24KG	QUADRANT RING	62	62-545	CLICK SPRING (2 REQ)
3	3-24KG	DOG BRIDGE	62B	62B-5253	CLICK PIN (2 REQ.)
4	4-24KG	THRUST WASHER	67	69C-245	RETAINING RING
5H	5-24KGHS	MAIN GEAR (HIGH SPEED)	67A	69C-30S	RETAINING RING
5L	5-24KGLS	MAIN GEAR (LOW SPEED)	69	69B-50	RETAINING RING (2 REQ.)
6	6-24KG	DRAG WASHER	69A	69B-30S	RETAINING RING
7	7-24KG	METAL DRAG WASHER	69D	69D-24KG	RETAINING RING
7B	7B-24KG	BACKING WASHER	71	71-24KG	SPOOL SPINDLE
13	13-24KG	PINION GEAR ASSEMBLY W/117	71B	71B-24KG	PINION SLEEVE
14	14-15KG	DOG SPRING (2 REQ.)	81	81-40	CLICK RATCHET
15	15-15KG	DOG (2 REQ.)	82	82-40	THRUST WASHER
16	16T-130	SIDE PLATE SCREW (4 REQ.)	82A	82-24KG	SHIM
18	18-50TW	DISC CLUTCH SPRING (4 REQ.)	91	91N-50	HANDLE RIVET
18C	18C-15KG	SHIFT BUTTON SPRING (2 REQ.)	95	95-24KG	CLICK HOUSING
18H	18H-70	SHIFT SPRING (HEAVY)	95A	63-500S	CLICK HOUSING SCREW
18L	18L-15KG	SHIFT SPRING (LIGHT)	101	101-30	SCREW (4 REQ)
21	21-24KG	ECCENTRIC LEVER	110A	110A-15KG	HANDLE LOCKING PLATE
23	23-15KG	SCREW	110B	110B-15KG	SHIFT HOUSING
24	24-15KG	HANDLE COMPLETE	119	119-24KG	SHIFT PLATE
24C	24C-50	HANDLE KNOB INSERT	123	123-800	BRIDGE SCREW
25	25-50	HANDLE KNOB	124	124-24KG	BRIDGE COVER
29	29L-24KG	SPOOL	128A	128A-24KG	DRIVE PLATE
30	30-114HL	STAND	134	134-24KG	GEAR STUD
31	31T-70	STAND SCREW (4 REQ)	141	141-24KG	CAM FOLLOWER
31I	31I-24KG	STAND INSERT (4 REQ)	144	144M-24KG	PRESET KNOB
32	32T-20	SCREW (2 REQ)	149	149-70	ROD CLAMP NUT (2)
33	33-70	ROD CLAMP	149A	149-15KG	FRAME NUT (2 REQ)
34	34-70	ROD CLAMP SCREW (2 REQ.)	156	156-24KG	DRAG COVER
35	35-24KG	CLICK TONGUE	157A	157-24KG	SPACER BUSHING (2 REQ)
36	36-15KG	CLICK BUTTON	158	158-24KG	DOG PIN (2 REQ)
37	37E-24KG	TOP SPACER BAR	161	161-25	FREE SPOOL BUTTON
38	38T-130S	SCREW (2 REQ)	161A	161-40	STRIKE BUTTON
38A	38T-50	SCREW (2 REQ)	162	162-50	BUTTON SPRING (2 REQ)
39	39-15KG	BRIDGE COVER SCREWS (2)	171	171-15KG	SHIFT PLUNGER
41	41-40	SPINDLE SPRING	172	172-24KG	SHIFT BUTTON (LOW)
50	50-15KG	GEAR STUD SHIELD	172B	172B-15KG	SHIFT BUTTON (HIGH)
54	54-15KG	HARNESS LUG (2 REQ.)	183	183-24KG	FRAME
55	55-80	BALL BEARING	195	195-40	RETAINING RING
55A	55-50	BEARING			

NOTE: Many of www.pennparts.com schematics include changes that were either made by Penn, or errors found and corrected by our parts dept.
SBT Ver. 032914 (Based on Penn's Rev. 11)

UPGRADE NOTES - Handle

Penn started subbing handle to 24M-15KG in 2005

To use the new number, you also need to change the screw (key#39) to 23-15KG

TYPO: *Some of Penn's schematics have the 63 and 63A key numbers mis-matched on the drawing*

63 63-50 HANDLE KNOB SCREW, SHORT

63A 63A-50 HANDLE STUD SCREW, LONG

This schematic drawing has the numbers correctly as shown here.