

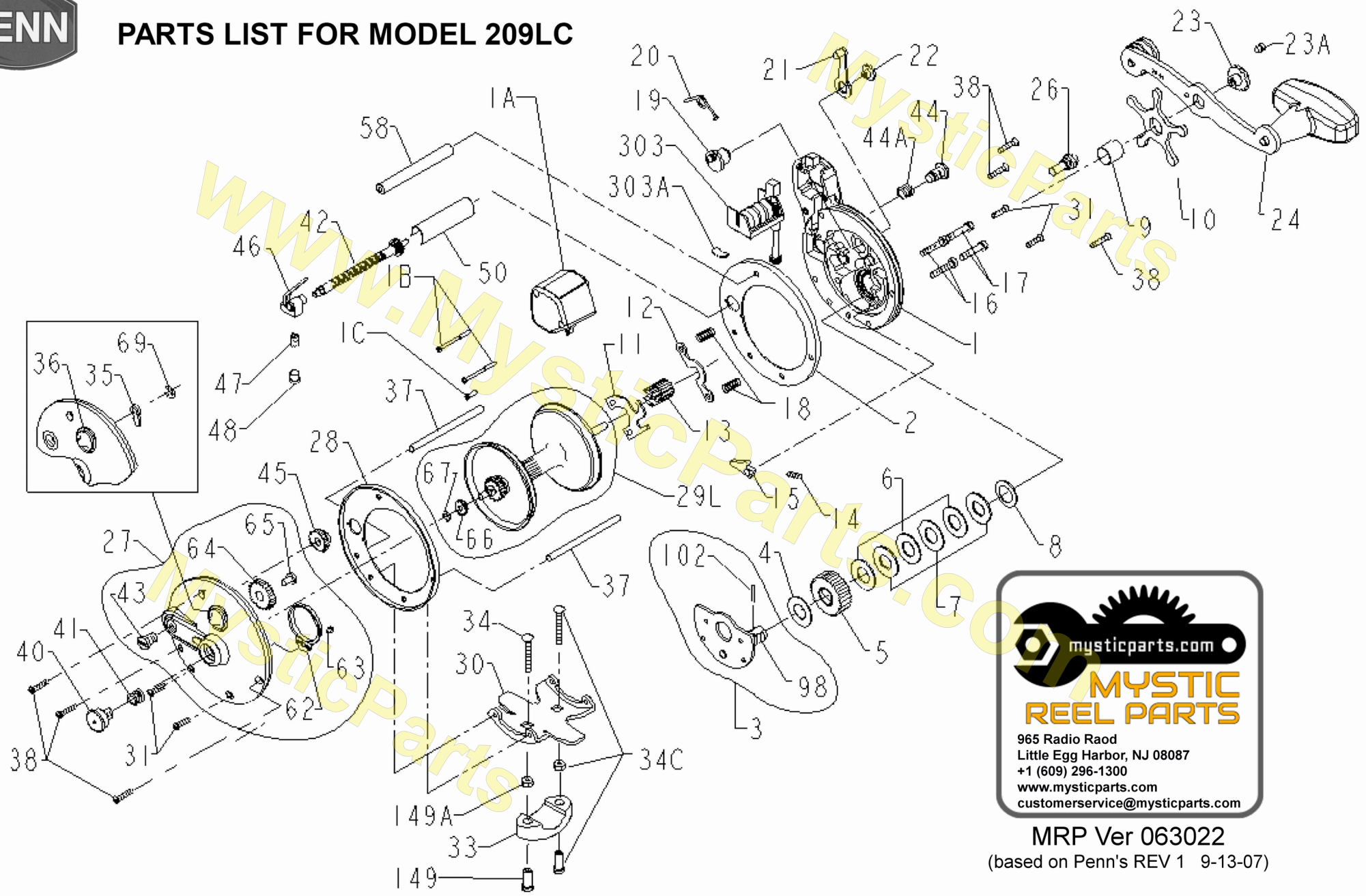

PARTS LIST FOR MODEL 209LC



mysticparts.com
MYSTIC REEL PARTS
965 Radio Raod
Little Egg Harbor, NJ 08087
+1 (609) 296-1300
www.mysticparts.com
customerservice@mysticparts.com

MRP Ver 063022
(based on Penn's REV 1 9-13-07)

PENN SCHEMATIC PARTS LIST FOR 209LC LINE COUNTER

KEY	PART		KEY	PART	
NO	NO.	DESCRIPTION	NO	NO.	DESCRIPTION
1	1-209LC	HANDLE SIDE PLATE	33	033 113	ROD CLAMP
1A	1A-209LC	LINE COUNTER COVER	*	33R-200	RINGED CLAMP (OPTIONAL)
1B	1B-209LC	SCREW F/ LC COVER TOP (2 REQUIRED)	34	34-45	CLAMP SCREW (ONLY)
1C	1C-209LC	SCREW F/ LC COVER LOEVER	34C	34C-45	CLAMP SCREW W/ NUTS
2	2-209	HANDLE SIDE RING	35	35-155	CLICK TONGUE
3	3-155	BRIDGE W/ SLEEVE	36	36N-209	CLICK BUTTON
4	4-155	FIBER WASHER	37	37-160	FRAME POST (2 REQ.)
5	5-209LC	MAIN GEAR	38/39	38-8	POST SCREW (3 REQ. PER SIDE)
6	6-155	DRAG WASHER	40	40-60	NON-HANDLE SIDE BEARING
7	7C-155	DRAG WASHER (METAL SET)	41	41-60	NON-HANDLE SIDE BEARING SPRING
8	8-60	TENSION WASHER	42	42-209LC	WORM
9	9-60	SPACING SLEEVE	43	43-109	HANDLE SIDE WORM BEARING
10	10-60	STAR DRAG	44	44N-109	NON-HANDLE SIDE WORM BEARING
11	11-155	ECCENTRIC JACK	44A	57-109	WORM BEARING SPRING
12	12-155	PINION YOKE	45	45N-209	WORM GEAR
13	13-209LC	PINION GEAR	46	46-209	LINE GUIDE
14	14-99	DOG SPRING	47	47-109	PAWL
15	15-209	DOG	48	48-109	PAWL COVER
16	16-60CH	LOWER BRIDGE SCREW (2 REQ.)	50	50-209	WORM SHEILD
17	17-60CH	UPPER BRIDGE SCREW (2 REQ.)	58	58-209	SLOTTED POST
18	18-60	CLUTCH SPRING	62	62-209	CLICK SPRING
19	19-209	ECCENTRIC	63	63-209	CLICK SPRING SCREW
20	20-155	ECCENTRIC SPRING	64	64-209	IDLER GEAR
21	21-209	ECCENTRIC LEVER	65	65-209	IDLER GEAR SCREW
22	22-60CH	ECCENTRIC SCREW	66	66N-209	LEVEL WIND DRIVE GEAR
23	23-60	HANDLE SCREW	67	67-209	DRIVE GEAR LOCK SPRING
23A	110-60	HANDLE LOCK SCREW	69	69B-600	CLICK BUTTON RETAINING SPRING
24	24-66	HANDLE	98	98-155	GEAR SLEEVE
26	26-155	HANDLE SIDE BEARING	102	102-60	GEAR SLEEVE PIN
27	27-209	NON-HANDLE SIDE PLATE	149	149-45	CLAMP NUT (2 REQ.)
28	28-209	NON-HANDLE SIDE RING	149A	149-200	HEX NUT (2 REQ.)
29L	29L-209	SPOOL ALUMINUM	303	303-209LC	COUNTER WHEEL ASSEMBLY
30	30-66	STAND	303A	303A-209LC	RETAINER FOR COUNTER WHEEL ASSEMBLY
31/32	32-22	STAND SCREW (2 REQ. PER SIDE)			

NOTE: Many of www.pennparts.com schematics include changes that were either made by Penn, or errors found and corrected by our parts dept.
PennPartsLLC Ver. 040517