

PENN PARTS LIST FOR MODEL 16VSX FOR SERIAL Nos. BEFORE J100001

Early Run Parts

as shown here

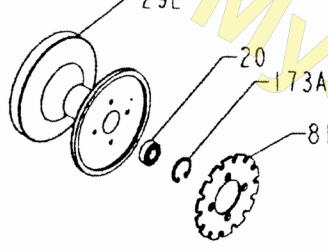

Design Change As of REV. 11/18/05

The first series 16VSX reels did not have a spacing sleeve (9-16VS) or the specific ratchet (81-16VS).

The replacement ratchet (81-16VS) has a smaller center hole diameter to hold the spacing sleeve (9-16VS) and spool bearing (20-722) inside the core of the spool. The use of the new parts eliminate the use of the retaining ring (173-16VS). If your 16VSX has the original arrangement, it is recommended to purchase the two parts: ratchet (81-16VS) and spacing sleeve (9-16VS) to complete the upgrade.

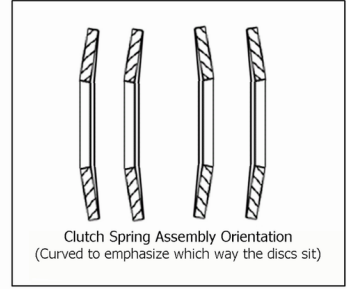
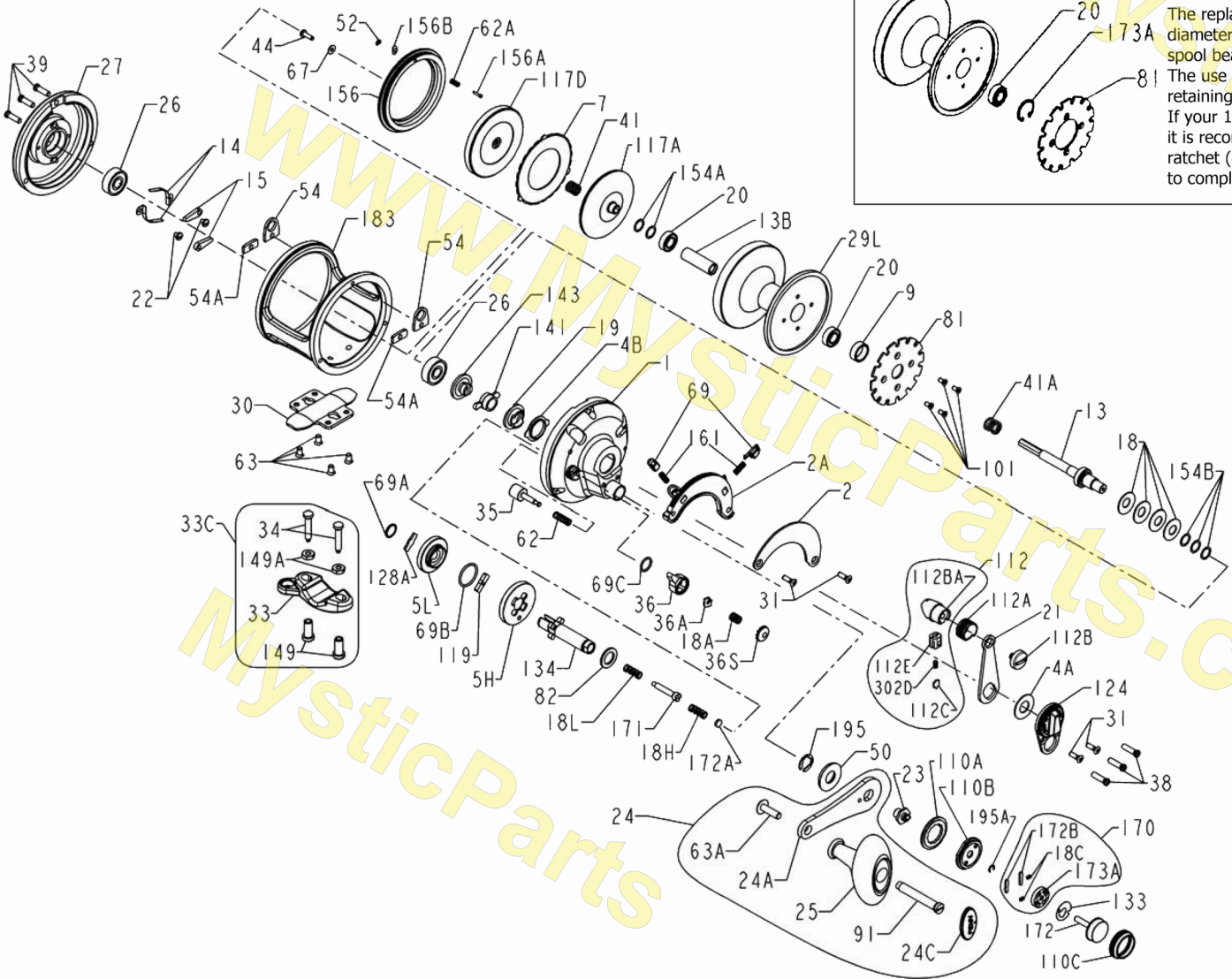

mysticparts.com
MYSTIC REEL PARTS
965 Radio Road
Little Egg Harbor, NJ 08087
+1 (609) 296-1300
www.mysticparts.com
customerservice@mysticparts.com

MRP Ver. 061723
(based on Penn's Rev 9 10-1-10)

Penn Reel Parts list for Model 16VSX (BEFORE J100001)

KEY PURE FISHING PART				KEY PURE FISHING PART			
<u>NO</u>	<u>7 DIGIT #</u>	<u>NO.</u>	<u>DESCRIPTION</u>	<u>NO</u>	<u>7 DIGIT #</u>	<u>NO.</u>	<u>DESCRIPTION</u>
1	1190803	1-16VS	HANDLE SIDE PLATE ASSEMBLY [GOLD]	33	1191592	33-16VS	ROD CLAMP, IRON ALLOY
1	N/A	1-16VSSLV	HANDLE SIDE PLATE ASSEMBLY [SILVER]	33C	1191605	33C-16VSX	ROD CLAMP KIT W/STUDS/NUTS
2	1190882	2-16VS	QUADRANT RING	34	1182786	34-16VS	CLAMP SCREW (2 REQUIRED)
2A	1190901	2A-16VS	QUADRANT RATCHET PLATE	34C	n/a	34C-16VS	ROD CLAMP SCREW W/ NUT
4A	1180748	4-12LT	THRUST WASHE R	35	1191666	35-16VSX	CLICK TONGUE
4B	1180752	4-30VS	CAM THRUST WASHE R	36	1191693	36-16VS	CLICK BUTTON
5H	1190947	5-16VSHSX	MAIN GEAR HIGH SPEED	36A	1191711	36A-16VS	CLICK BUTTON NUT
5L	1190949	5-16VSLSX	MAIN GEAR LOW SPEED	36C	n/a	36C-16VS	CLICK BUTTON ASSEMBLY
7	1191002	7-16VS	METAL DRAG WASHER	36S	1191714	36S-16VS	CLICK BUTTON CAP
9 SEE NOTES ON PAGE 3				38	1191723	38-16VS	HANDLE SIDE PLATE SCREW (3 REQUIRED)
13	1191095	13-16VSX	PINION GEAR	39	1191739	39-16VS	L.S. PLATE SCREW (3 REQUIRED)
13B	1191123	13B-16VS	SPOOL SLEEVE	41	1183329	41-109	L.S. BEARING SPRING
14	1181388	14-16S	DOG SPRING (2 REQUIRED)	41A	1183327	41-60	DRAG SPRING
15	1181425	15-50	DOG (2 REQUIRED)	44	1183459	44-710	PINION GEAR SCREW
18	1191204	18-16VS	DISC CLUTCH SPRING (4 REQUIRED)	50	1191964	50-30VS	GEAR STUD SHEILD
18A	1181624	18-525	CLICK SPRING	52	1191987	52-16VS	RETAINING RING
18C	1181632	18C-15KG	PRESET KNOB SPRING (2 REQUIRED)	54	1183850	54-16S	HARNES LUG (2 REQUIRED)
18H	1181634	18H-30VS	SHIFT SPRING (HEAVY)	54A	1183865	54A-16VS	HARNES LUG PLUG (2 REQUIRED)
18L	1181637	18L-30VS	SHIFT SPRING (LIGHT)	62	1184022	62-50	CLICK SPRING
19	1191220	19-16VS	ECCENTRIC CAM	62A	1181393	14-99	DOG SPRING
20	1181792	20-722	SPOOL BALL BEARING (2 REQ)	63	1191562	31-16VS	STAND SCREW (4 REQUIRED)
21	1192625	21-16VS	ECCENTRIC LEVER	63A	1192088	63A-16VS	HANDLE KNOB SHAFT SCREW
22	1181912	22-109	DOG SPRING SCREW (2 REQUIRED)	67	1192093	67-16VS	PINION GEAR WASHER
23	1181933	23-30VS	HANDLE/SHIFT BUTTON SCREW	69	1192105	69-12VS	LOCATING PIN (2 REQUIRED)
24	1181969	24-16VS	HANDLE COMPELTE	69A	1184954	195-24KG	RETAINING RING
24A	1207738	24A-16VS-1	HANDLE BLANK ONLY	69B	1184133	69C-245	RETAINING RING, FOR GEAR
24C	1182092	24C-113HN	HANDLE KNOB CAP	69C	1192106	69-16VS	CLICK RETAINING RING, FOR CLICK LEVER
25	1207739	25S-113HN	HANDLE KNOB	81 SEE NOTES ON PAGE 3			
26	1182146	26N-40	BALL BEARING (2 REQUIRED)	82	1184219	82-24KG	SHIM
27	1191374	27-16VS	NON-HANDLE SIDE PLATE [GOLD]	91	1207740	91S-16VS	HANDLE RIVET, STAINLESS
27	1390194	27-16VSSLV	NON-HANDLE SIDE PLATE [SILVER]	101	1184403	101-30	DRIVE PLATE SCREW (4 REQUIRED)
29	1192676	29L-16VS	SPOOL [GOLD]	110A	1184440	110A-30VS	RING
29	1389487	29L-16VSSLV	SPOOL [SILVER]	110B	1184446	110B-30VS	SHIFT BASE
30	1182599	30-16VS	STAND	110C	1184447	110C-30VS	SHIFT BUTTON RETAINER
31	1182700	31T-70	SHORT SCREW (4 REQUIRED)				

KEY PURE FISHING PART

<u>NO</u>	<u>7 DIGIT #</u>	<u>NO.</u>	<u>DESCRIPTION</u>
112	1184456	112-30VS	ECCENTRIC LEVER KNOB ASSEMBLY [GOLD]
112	1390201	112-30VSSLV	ECCENTRIC LEVER KNOB ASSEMBLY [SILVER]
112A	1184460	112A-30VS	KNOB SLEEVE
112B	1184464	112B-70	ECCENTRIC KNOB SCREW [GOLD]
112B	1389498	112B-70SLV	ECCENTRIC KNOB SCREW [SILVER]
112BA	1192711	112B-30VS	DRAG KNOB [GOLD]
112BA	1389497	112B-30VSSLV	DRAG KNOB [SILVER]
112C	1192712	112C-30VS	DRAG CLICK PLATE
112E	1192713	112E-30VS	CLICK PLATE HOUSING
117A	1192716	117AN-16VS	INNER DRIVE PLATE ASSEMBLY
117D	1192718	117DN-16VS	OUTER DRIVE PLATE ASSEMBLY
119	1184515	119-24KG	SHIFT PLATE
124	1184566	124L-16VS	BRIDGE COVER ASSEMBLY
128A	1184566	128A-24KG	CAM HOUSING
133	1184602	133-30VS	RETAINING PLATE
134	1192307	134-16VS	GEAR STUD
141	1184652	141-30VS	CAM FOLLOWER
143	1184670	143-16VS	PRESET SCREW
144L	1192726	144L-16VS	PRESET KNOB

KEY PURE FISHING PART

<u>NO</u>	<u>7 DIGIT #</u>	<u>NO.</u>	<u>DESCRIPTION</u>
149	1184702	149-45	ROD CLAMP NUT (2 REQUIRED)
149A	1184706	149-200	ROD CLAMP LONG NUT (2 REQUIRED)
154A	1192350	154-16VS	SHIM (2 - only if needed - optional)
154B	1192350	154-16VS	SHIM (3 REQUIRED)
156	1192352	156-16VS	DRAG COVER
156A	1192356	156A-16VS	PIN
156B	1192358	156B-16VS	PLATE
162	1184795	162-50	LOCATING PIN SPRING (2 REQUIRED)
170	1184809	170-30VS	CATCH ASSEMBLY
171	1184811	171-15KG	SHIFT PLUNGER
172	1226062	172N-30VS	SHIFT BUTTON ASSEMBLY (METAL)
172A	1184823	172A-15KG	SPACER
172B	1184835	173-30VS	SHIFTER CATCH PLATE (2 REQUIRED)
173A	1184848	173A-30VS	SHIFTER CATCH HOUSING
183	1192731	183-16VSX	TUBE FRAME [GOLD]
183	1389504	183-16VSXSLV	TUBE FRAME [SILVER]
195	1184955	195-40	RETAINING RING, FOR SHIFT ASSEMBLY
195A	1184105	67-30VS	RETAINING RING, FOR SHIFT BUTTON
302D	1185255	302D-525MAG	DRAG CLICK PLATE SPRING

USES WRENCHES: 168-60, 168-30VS, 168A-70
 BAG: 111-50

*** PLEASE READ ***

<https://scottsb.t.zendesk.com/hc/en-us/articles/203741379>

ABOUT EARLY RUN, BEFORE AND AFTER DESIGNS FOR THE 16VSX REELS

MYSTIC REEL PARTS REVISION!

NOTE:

Many of www.mysticparts.com schematics include changes that were either made by Penn, or errors found and corrected by our parts dept.

MRP Ver. 061723 (based on Penn's Rev 9 (10-1-10))

EARLY RUN PARTS (SEE DRAWING INSERT)

173	1192385	173-16VS	RETAINING RING (EARLY RUN ONLY)
81	1184201	81-16S	RATCHET (EARLY RUN ONLY) *** THIS PART HAS BEEN REPLACED BY 81-16VS AND 9-16VS

The first series 16VSX reels did not have a spacing sleeve (9-16VS) or the specific ratchet (81-16VS).

REVISED PARTS

9	1191037	9-16VS	SPACING SLEEVE
81	1192152	81-16VS	RATCHET, REVISED (EARLY RUNS HAD 81-16S)

The replacement ratchet (81-16VS) has a smaller center hole diameter to hold the spacing sleeve (9-16VS) and spool bearing (20-722) inside the core of the spool. The use of the new parts eliminate the use of the retaining ring (173-16VS).

If your 16VSX has the original arrangement, it is recommended to purchase the two parts: ratchet (81-16VS) and spacing sleeve (9-16VS) to complete the upgrade.