

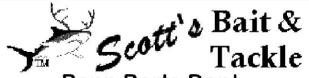

PARTS LIST FOR MODEL 16VS FOR SERIAL Nos. BEFORE J100001

www.PENNparts.com



Penn Parts Dept.
945 Radio Road
Tuckerton NJ 08087
(609) 296-1300

No Minimum Order!
Plus, Parts in stock
that Penn doesn't
carry anymore.

SBT Ver. 052512

(based on Penns 407-16VS Rev. 27, 4-7-11)

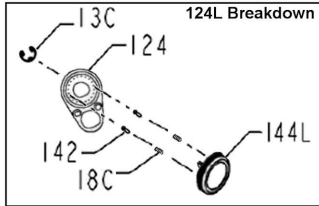
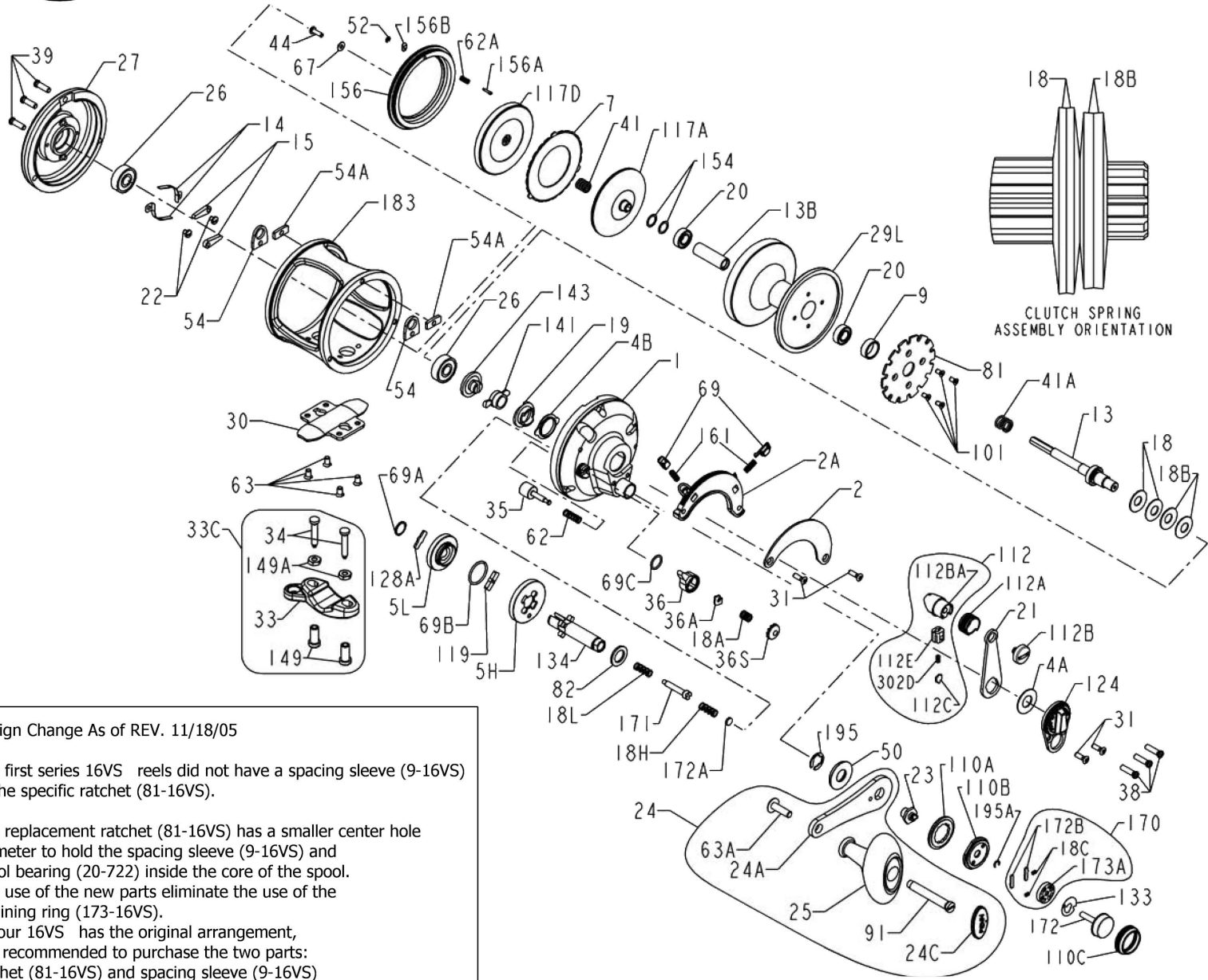

Early Run Parts

as shown here

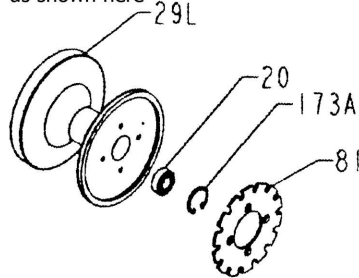

Design Change As of REV. 11/18/05

The first series 16VS reels did not have a spacing sleeve (9-16VS) or the specific ratchet (81-16VS).

The replacement ratchet (81-16VS) has a smaller center hole diameter to hold the spacing sleeve (9-16VS) and spool bearing (20-722) inside the core of the spool. The use of the new parts eliminate the use of the retaining ring (173-16VS).

If your 16VS has the original arrangement, it is recommended to purchase the two parts: ratchet (81-16VS) and spacing sleeve (9-16VS) to complete the upgrade.

Penn Reel Parts list for:

Model: 16VS (BEFORE J100001)

KEY PART			KEY PART		
NO	NO.	DESCRIPTION	NO	NO.	DESCRIPTION
1	1-16VS	R.S. PLATE ASSEMBLY	54A	54A-16VS	HARNES LUG PLUG (2 REQ.)
2	2-16VS	QUADRANT RING	62	62-50	CLICK SPRING
2A	2A-16VS	QUADRANT RATCHET PLATE	62A	14-99	DOG SPRING
4	4-12LT	THRUST WASHE R	63	31-16VS	STAND SCREW (4 REQ.)
4A	4-30VS	CAM THRUST WASHE R	63A	63A-16VS	HANDLE KNOB SHAFT SCREW
5H	5-16VSHS	MAIN GEAR HIGH SPEED	67	67-16VS	PINION GEAR WASHER
5L	5-16VSL S	MAIN GEAR LOW SPEED	69	69-12VS	LOCATING PIN (2 REQ.)
7	7-16VS	METAL DRAG WASHER	69A	195-24KG	RETAINING RING, MAIN GEAR LS
9	9-16VS	SPACING SLEEVE	69B	69C-245	RETAINING RING, MAIN GEAR HS
13	13-16VS	PINION GEAR	69C	69-16VS	RETAINING RING F/CLICK BUTTON
13B	13B-16VS	SPOOL SLEEVE	81	81-16VS	RATCHET (EARLY RUNS HAD 81-16S)
14	14-16S	DOG SPRING (2 REQ.)	82	82-24KG	SHIM
15	15-50	DOG (2 REQ.)	91	91S-16VS	HANDLE RIVET
18	18-12T	DISC CLUTCH SPRING (2 REQ.)	101	101-30	DRIVE PLATE SCREW (4 REQ.)
18A	18-525	CLICK SPRING	110A	110A-30VS	RING
18B	18-16VS	DISC CLUTCH SPRING (2 REQ.)	110B	110B-30VS	SHIFT BASE
18C	18C-15KG	PRESET KNOB SPRING (2 REQUIRED)	110C	110C-30VS	SHIFT BUTTON RETAINER
18H	18H-30VS	SHIFT SPRING (HEAVY)	112	112-30VS	ECCENTRIC LEVER KNOB ASSEMBLY
18L	18L-30VS	SHIFT SPRING (LIGHT)	112A	112A-30VS	KNOB SLEEVE
19	19-16VS	ECCENTRIC CAM	112B	112B-70	ECCENTRIC KNOB SCREW
20	20-722	SPOOL BALL BEARING (2 REQ)	112BA	112B-30VS	DRAG KNOB
21	21-16VS	ECCENTRIC LEVER	112C	112C-30VS	DRAG CLICK PLATE
22	22-109	DOG SPRING SCREW (2 REQ.)	112E	112E-30VS	CLICK PLATE HOUSING
23	23-30VS	HANDLE/SHIFT BUTTON SCREW	117A	117AN-16VS	INNER DRIVE PLATE ASSEMBLY
24	24-16VS	HANDLE COMPELTE	117D	117DN-16VS	OUTER DRIVE PLATE ASSEMBLY
24A	24A-16VS-1	HANDLE BLANK ONLY	119	119-24KG	SHIFT PLATE
24C	24C-113HN	HANDLE KNOB CAP	124	124L-16VS	BRIDGE COVER ASSEMBLY
25	25S-113HN	HANDLE KNOB	128A	128A-24KG	CAM HOUSING
26	26N-40	BALL BEARING (2 REQ.)	133	133-30VS	RETAINING PLATE
27	27-16VS	L.S. PLATE	134	134-16VS	GEAR STUD
29	29L-16VS	SPOOL	141	141-30VS	CAM FOLLOWER
30	30-16VS	STAND	143	143-16VS	PRESET SCREW
31	31T-70	SHORT SCREW (4 REQ.)	149	149-45	ROD CLAMP NUT (2 REQ.)
33	33-16VS	ROD CLAMP, IRON ALLOY	149A	149-200	ROD CLAMP LONG NUT (2 REQ.)
33C	33C-16VS	ROD CLAMP KIT	154	154-16VS	SHIM (2 ONLY IF NEEDED - OPTIONAL)
34	34-16VS	CLAMP SCREW (2 REQ.)	156	156-16VS	DRAG COVER
34C	34C-16VS	ROD CLAMP SCREW W/ NUT	156A	156A-16VS	PIN
35	35-16VSX	CLICK TONGUE	156B	156B-16VS	PLATE
36	36-16VS	CLICK BUTTON	162	162-50	LOCATING PIN SPRING (2 REQ.)
36A	36A-16VS	CLICK BUTTON NUT	170	170-30VS	CATCH ASSEMBLY
36C	36C-16VS	CLICK BUTTON ASSEMBLY	171	171-15KG	SHIFT PLUNGER
36S	36S-16VS	CLICK BUTTON CAP	172	172N-30VS	SHIFT BUTTON (METAL)
38	38-16VS	R.S. PLATE SCREW (3 REQ.)	172A	172A-15KG	SPACER
39	39-16VS	L.S. PLATE SCREW (3 REQ.)	173	173-16VS	RETAINING RING (EARLY RUNS ONLY)
41	41-109	L.S. BEARING SPRING	172B	173-30VS	SHIFTER CATCH PLATE (2 REQUIRED)
41A	41-60	DRAG SPRING	173A	173A-30VS	SHIFTER CATCH HOUSING
44	44-710	PINION END SCREW	183	183-16VS	TUBE FRAME
50	50-30VS	GEAR STUD SHEILD	195	195-40	RETAINING RING, FOR SHIFT ASSEMBL
52	52-16VS	RETAINING RING	195A	67-30VS	RETAINING RING, FOR SHIFT BUTTON
54	54-16S	HARNES LUG (2 REQ.)	302D	302D-525MAGDRAG	CLICK PLATE SPRING

NOTE: Many of www.pennparts.com schematics include changes that were either made by Penn, or errors found and corrected by our parts dept.

SBT VER. 052512

124 Bridge Cover Assembly Breakdown

13C	13C-30VS	PRESET KNOB RETAINING RING
124	124-16VS	BRIDGE COVER (NOT AVAILABLE)
142	142-16VS	PRESET KNOB PIN (2 REQ.)
18C	18C-15KG	PRESET KNOB SPRING (2 REQ.)
144L	144L-16VS	PRESET KNOB

USES WRENCHES: 168-60, 168-30VS, 168A-70
BAG: 111-50