

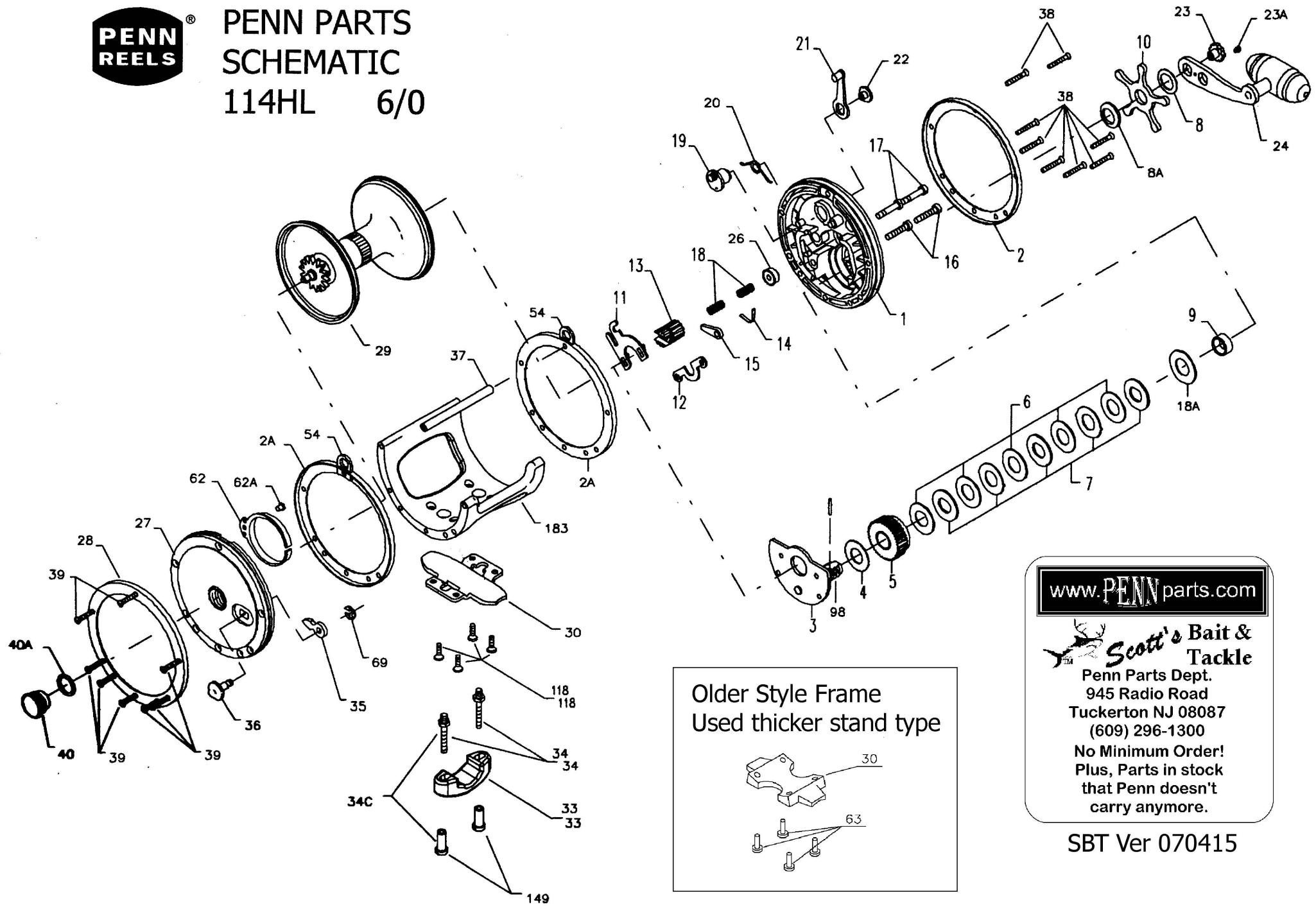

**PENN PARTS
SCHEMATIC
114HL 6/0**



Older Style Frame
Used thicker stand type

www.PENNparts.com

Scott's Bait & Tackle
 Penn Parts Dept.
 945 Radio Road
 Tuckerton NJ 08087
 (609) 296-1300
 No Minimum Order!
 Plus, Parts in stock
 that Penn doesn't
 carry anymore.

SBT Ver 070415

Penn Reel Parts list for Model: 114HL 6/0 Senator

KEY PART			KEY PART		
NO	NO.	DESCRIPTION	NO	NO.	DESCRIPTION
1	1-114H	HANDLE SIDE PLATE	22	22-60	ECCENTRIC SCREW
2	2-114H-O	OUTER HANDLE SIDE RING	23	23-116	HANDLE SCREW
2A	2-114-I	INNER SIDE RING (2 REQUIRED)	23A	110-60	HANDLE LOCK SCREW
3	3-114H	BRIDGE ASSEMBLY	24	24-57	HANDLE
4	4-115	FIBER WASHER	26	26-116	HANDLE SIDE BEARING
5	5-115	MAIN GEAR	27	27N-114H	NON-HANDLE SIDE PLATE
6	6-115	DRAG WASHER	28	2-114-O	OUTER NON-HANDLE SIDE RING
7	7C-115	METAL WASHER SET	29	29L-114HL	SPOOL
8	8-114	TENSION SPRING (Thin)	33	33-340	ROD CLAMP, THICK GRAPHITE
8A	8-115	TENSION SPRING (Thick)	34	34-114HLW	ROD CLAMP SCREW (2 REQUIRED)
9	9-114H	SPACING SLEEVE	35	35-114	CLICK TONGUE
10	10-114	STAR DRAG WHEEL	36	36-114H	CLICK BUTTON
11	11-114	ECCENTRIC JACK	37	37-114	FRAME POST
12	12-114	PINION YOKE	38	39-12	HANDLE SIDE POST SCREW (8 REQUIRED)
13	13-114H	PINION	39	32-21	NON-HANDLE SIDE POST SCREW (8 REQUIRED)
14	14-114	DOG SPRING	40	40-114HL	NON-HANDLE SIDE BEARING
15	15-114H	DOG	40A	120-114H	NON-HANDLE SIDE BEARING O-RING
16	16-114	LOWER BRIDGE SCREW (2 REQUIRED)	54	54-114	HARNES LUG (2 REQUIRED)
17	17-114	UPPER BRIDGE SCREW (2 REQUIRED)	62	62-114	CLICK SPRING
18	18-114	CLUTCH SPRING (2 REQUIRED)	62A	63-209	CLICK SPRING SCREW
18A	18-114H	SPRING DISK	69	69B-600	RETAINING RING
19	19-114	ECCENTRIC	98	98-114	GEAR SLEEVE
20	20-114	ECCENTRIC SPRING	149	149-45	ROD CLAMP NUT (2 REQUIRED)
21	21-114	ECCENTRIC LEVER	**		NOT SHOWN ON DRAWING

NOTE: Many of www.pennparts.com schematics include changes that were either made by Penn, or errors found and corrected by our parts dept.
SBT Ver 070415

DESIGN CHANGE FRAMES AND STANDS

183	183-114HL	FRAME, ORIG, THICK STAND	183	183N-114HL	FRAME, LATER, THIN STAND
	USES			USES	
30	30-50T	STAND	30	30-114HL	STAND
63	63-30T	SCREWS, STAND (4 REQUIRED)	118	118-80	SCREWS, STAND (4 REQUIRED)