

# PENN

## Penn 114H 6/0 Reel Full Frame Version

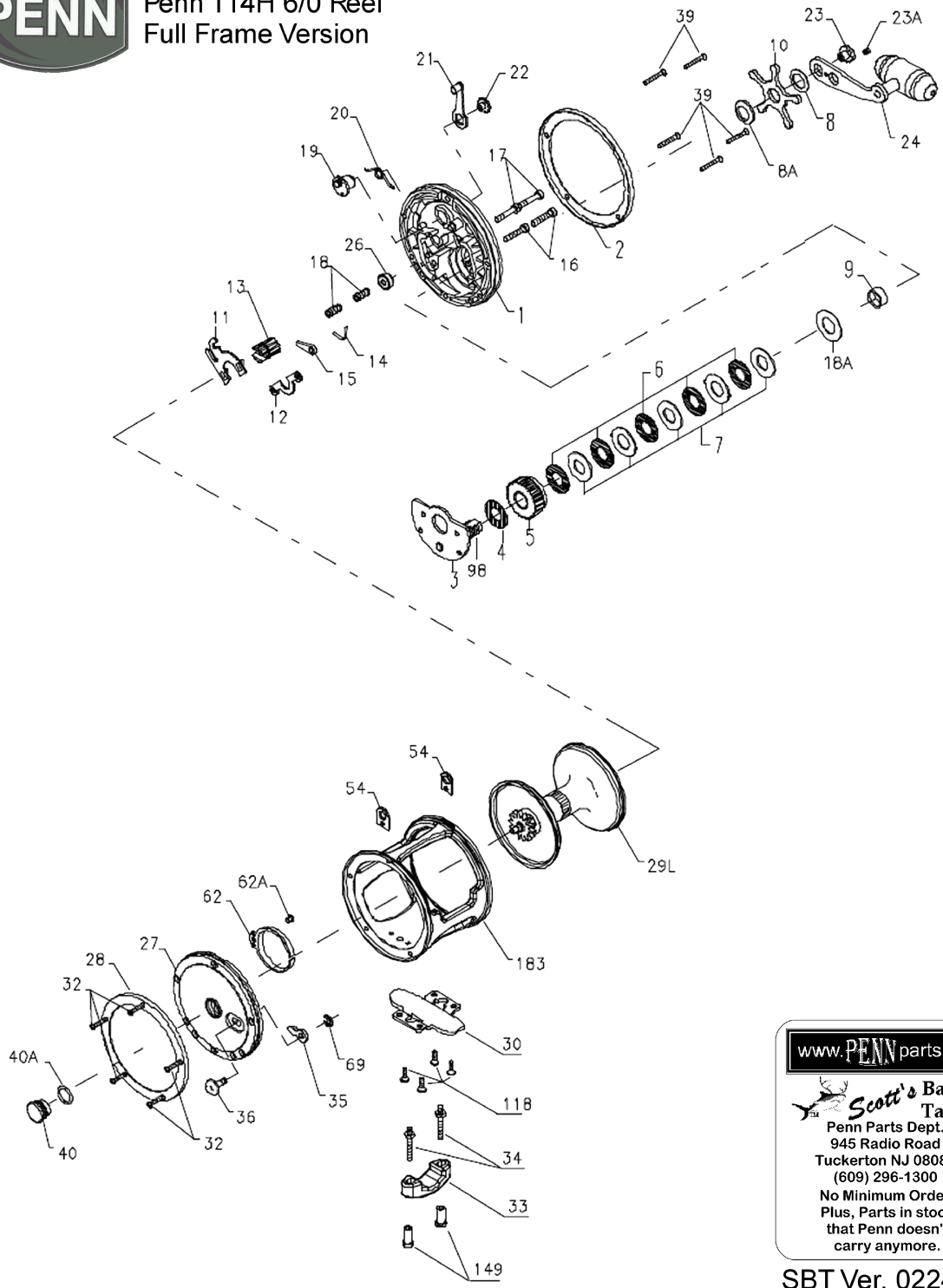

[www.PENNparts.com](http://www.PENNparts.com)

**Scott's Bait & Tackle**  
Penn Parts Dept.  
945 Radio Road  
Tuckerton NJ 08087  
(609) 296-1300  
No Minimum Order!  
Plus, Parts in stock  
that Penn doesn't  
carry anymore.

SBT Ver. 022406

## Penn Reel Parts list for Model: 114H 6/0 Senator, Full Frame Version

KEY NO.	PART NO.	DESCRIPTION	KEY NO.	PART NO.	DESCRIPTION
1	1-114H	Handle Side Plate	24	24-57	Handle
2	2N-114H	Handle Side Ring Outer	26	26-116	Bearing Handle Side
3	3-114H	Bridge with Sleeve	27	27N-114H	Non-Handle Side Plate
4	4-115	Fiber Washer	28	2N-114	Non-Handle Side Ring Outer
5	5-115	Main Gear	29	29L-114HL	Spool, Aluminum
6	6-115	Drag Washer	30	30-114HL	Stand
7	7C-115	Metal Drag Washer Set	32	32-21	Non-Handle Side Post Screw (5 Required)
	88-114	Tension Spring	33	33-340	Rod Clamp
8A	8-115	Tension Spring	34	34-114HLW	Rod Clamp Screw (2 Required)
9	9-114H	Spacing Sleeve	35	35-114	Click Tongue
10	10-114	Star Drag Wheel	36	36-114H	Click Button
11	11-114	Eccentric Jack	39	39-12	Handle Side Post Screw (5 Required)
12	12-114	Pinion Yoke	40	40-114HL	Non-Handle Side Bearing
13	13-114H	Pinion	40A	120-114H	Non-Handle Side Bearing O Ring
14	14-114	Dog Spring	54	54-114	Harness Lug (2 Required)
15	15-114H	Dog	62	62-114	Click Spring
16	16-114	Bridge Screw Lower (2 Required)	62A	63-209	Click Spring Screw
17	17-114	Bridge Screw Upper (2 Required)	69	69B-600	Retaining Ring
18	18-114	Clutch Spring	98	98-114	Gear Sleeve
18A	18-114H	Spring Disc	118	118-80	Stand Screws (4 Required)
19	19-114	Eccentric	149	149-45	Clamp Nut (2 Required)
20	20-114	Eccentric Spring	183	183-114H-T	Frame, Full, Aluminum
21	21-114	Eccentric Lever			
22	23-60	Eccentric Screw			
23	23-116	Handle Screw			
23A	110-60	Handle Lock Screw			

NOTE: Many of [www.pennparts.com](http://www.pennparts.com) schematics include changes that were either made by Penn, or errors found and corrected by our parts dept.  
SBT Ver 101213

CHANGES: 33R-114 RINGED METAL CLAMP WAS REMOVED - DOES NOT FIT THIS VERSION