

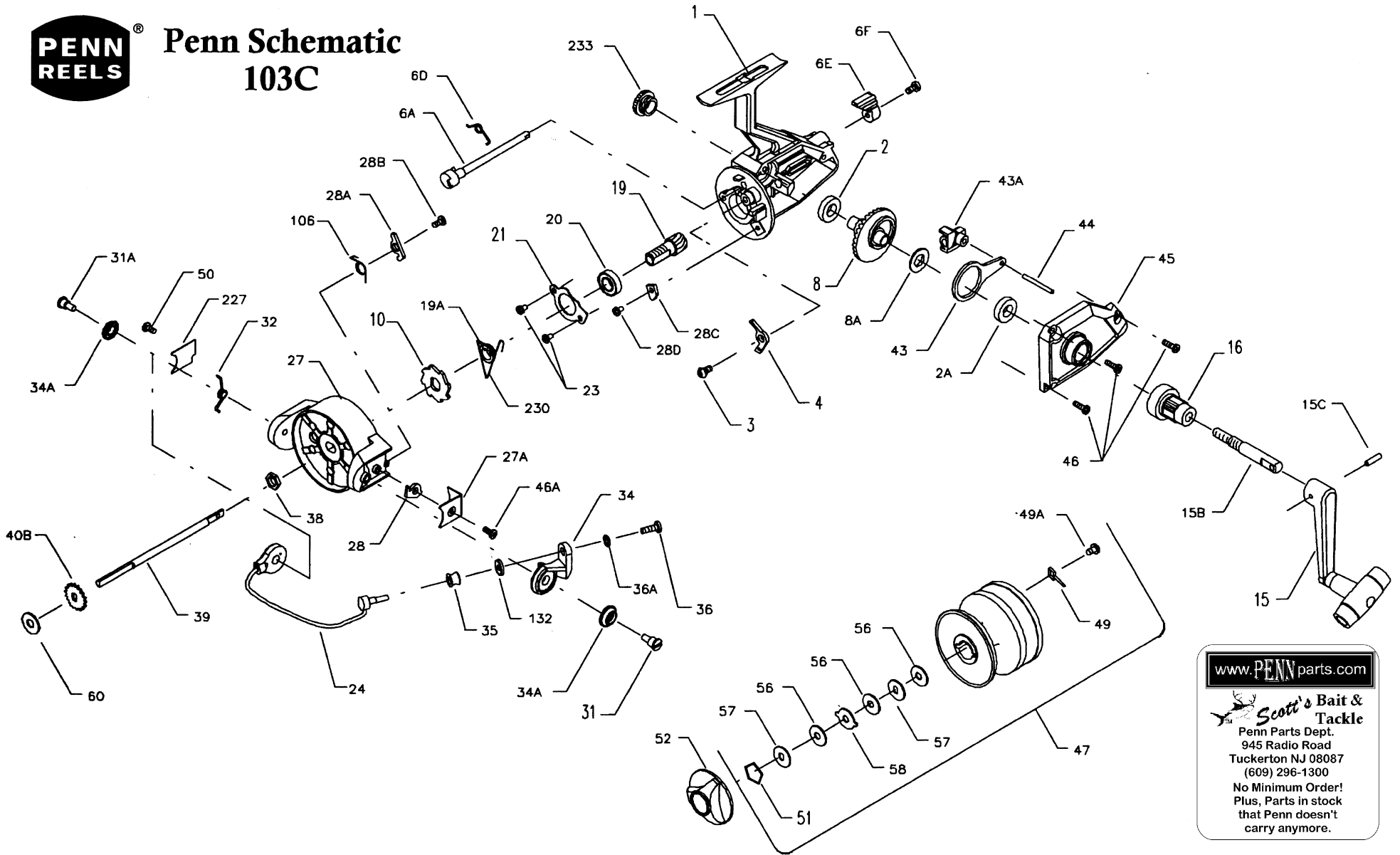

Penn Schematic 103C



www.PENNparts.com

Scott's Bait & Tackle
Penn Parts Dept.
945 Radio Road
Tuckerton NJ 08087
(609) 296-1300

No Minimum Order!
Plus, Parts in stock
that Penn doesn't
carry anymore.

Penn Reel Parts list for:

Model: 103C

KEY PART			KEY PART		
NO	NO.	DESCRIPTION	NO	NO.	DESCRIPTION
1	1-103C	HOUSING W/ BUSHING EMBLEM	32	32-103	BAIL SPRING
2	2-103	HOUSING BUSHING	34	34-103	BAIL ARM
2A	2A-103	COVER BUSHING	34A	34A-103	BAIL ARM SPACER
3	3-103	DOG MOUNTING SCREW	35	35-103C	LINE ROLLER
4	4-103C	DOG W/ FINGER SPRING	36	36-101	BAIL STUD SCREW
6A	6A-103	ECCENTRIC	36A	36A-103	LOCK WASHER
6D	6D-103	ECCENTRIC SPRING	38	38-103	ROTOR NUT
6E	6E-103	ECCENTRIC LEVER	39	39-103C	CROSSWIND SHAFT
6F	6F-101	ECCENTRIC LEVER MOUNTING SCREW	40B	40B-103	CLICK RATCHET
8	8-103C	MAIN GEAR ASSEMBLY	43	43-103C	CROSSWIND ARM
8A	8A-103	MAIN GEAR SHIM	43A	43A-103C	CROSSWIND BLOCK
10	10-103C	ANTI-REVERSE RATCHET	44	44-103C	CROSSWIND ARM PIN
15	15-103	HANDLE	45	45-103C	HOUSING COVER W/ BUSHING
15B	15B-103	HANDLE SHAFT	46	46-103	HOUSING COVER SCREW (3 REQ.)
15C	15C-103	HANDLE PIVOT PIN	46A	46A-103	ROTOR END COVER SCREW
16	16-103	HANDLE COLLAR	47	47-103C	SPOOL (COMPLETE)
19	19-103C	PINION GEAR	49	49-103	CLICK SPRING
19A	19A-103C	PINION GEAR SPACER	49A	3-101	CLICK SPRING SCREW
20	20-103	BALL BEARING	50	23-103	BAIL SPRING COVER SCREW
21	21-103C	BEARING COVER	51	51-103	RETAINING RING
23	23-103	BEARING COVER SCREW (2 REQ.)	52	52-103	DRAG KNOB
24	24-103	BAIL WIRE	56	56T-103	DRAG WASHER (TEFLON) (3 REQ.)
27	27-103C	ROTOR CUP	57	57-103	DRAG WASHER (KEYED) (2 REQ.)
27A	27A-103	ROTOR END COVER	58	58-103	DRAG WASHER (EAR)
28	28-103	TRIP LEVER	60	60-103	THRUST WASHER (TEFLON)
28A	28A-103	CAM LEVER	106	106-103	CAM LEVER SPRING
28B	28B-103	CAM LEVER MOUNTING SCREW	132	132-103	ROLLER WASHER
28C	28C-103	TRIP CAM	227	227-103	BAIL SPRING COVER
28D	46A-103	CAM MOUNT SCREW	230	230-103C	SILENT DOG SPRING
31	31A-103	BAIL ARM SCREW	233	233-103	HOUSING HANDLE CAP
31A	31A-103	BAIL WIRE MOUNTING SCREW			

NOTE: Many of www.pennparts.com schematics include changes that were either made by Penn, or errors found and corrected by our parts dept.

Last update 8/15/03